

THE 35TH ANNUAL SCIENTIFIC MEETING
OF THE INTERNATIONAL SOCIETY OF
POLITICAL PSYCHOLOGY (ISPP)



Identity Politics and Politicized
Identities: Political Psychology
in Times of Contention



ISPP
International Society
of Political Psychology

6–9 JULY 2012
Chigaco, USA, Mart Plaza Hotel

Welcome to the 35th Annual
Scientific Meeting of the
International Society of Political
Psychology

TABLE OF CONTENTS

• Welcome letter from President	04
• Welcome letter from Chicago Program Chairs	05
• Keynotes	06
• Welcome letter from JSC Chair	08
• Section Chairs	09
• Floor plans	10
• Summary of special events	12
• Award winners for 2012	13
• Call for Roberta Sigel Paper Award	14
• Call for Best Dissertation Award 2012	15
• Call for proposals & papers, Israel 2013	16
• Israel 8–11 July 2013	17
• Schedule at a glance;	
Friday, July 6	18
Saturday, July 7	20
Sunday, July 8	22
Monday, July 9	24
• Sessions by section	26
• Sessions by day and time;	
Friday, July 6	32
Saturday, July 7	33
Sunday, July 8	34
Monday, July 9	35
• Conference details by day and time;	
Friday, July 6	38
Saturday, July 7	56
Sunday, July 8	75
Monday, July 9	92
• Index of conference presenters	100
• List of ISPP Officers	128
• Membership information	131

'IDENTITY POLITICS AND POLITICIZED IDENTITIES. POLITICAL PSYCHOLOGY IN TIMES OF CONTENTION'

When I chose this as the theme of the 35th Annual Scientific Meeting of the ISPP two years ago, I could hardly imagine how timely that would be in 2012. Syria, Libya, Tunisia, Greece, and Spain, Occupy and the Tea Party, riots in Athens and Berlin, central squares occupied in Egypt, Spain and Tel Aviv. Our times are contentious indeed. Politics concerns the distribution of scarce resources and the working of power relations in society, and the conflicts that arise pit social groups against one another. The major players are often at opposite sides of cleavages along lines of race, ethnicity, class, religion, or language. When politicians utilize identity politics, do they then trigger the formation of politicized identities, which in turn instigate contentious politics? Or do they merely exploit existing cleavages, representing one side in a long-standing dispute thus politicizing existing collective identities? The goal of the conference will be to apply political psychology to these important questions. I will do so in my Presidential Address and so will our keynote speakers and the presenters in the thematic sessions that run through the program.

The 2012 meeting will take place in Chicago, a city with a rich contentious history. Jacquelin van Stekelenburg and Nicholas Valentino – the Program Chairs – together with the Section Chairs have compiled an exciting program featuring, not only keynote speakers and thematic sessions, but many stimulating papers. Anca Mineanu programmed the chain of thematic sessions throughout the conference. They all did a wonderful job and deserve a big cheer. We hope that we have been able to bring together new findings from the various fields of political psychology and have succeeded in creating an intellectual forum in which scholars can exchange views and work towards the contribution of political psychology to the understanding of our contentious times.

Throughout the meeting keynote speakers and a chain of thematic sessions will address the conference theme, such as: *Politicizing Religion*, *Political Motherhood*, *Political Impact of Political Identity*, *Dynamics and Consequences of Politicized Identities*, *Political Identities in Current Social Movements: Egypt and Iran*, and *Forging Identities in Different National Contexts*. I hope you find this all interesting and stimulating.

All this illustrates that our Society is alive and well. This year we continue the Summer Academy (SA) which we started so successfully in Istanbul and are determined to make this a permanent feature of our Conference. Tereza Capelos deserves credit for that. You will certainly meet some of the students of the SA as they are attending the conference as well and are recognizable by their name tag. Another exciting novelty is the expansion of *Political Psychology*, our journal, with an annual issue with review articles named *Advances in Political Psychology*. Howard Lavine will be the editor of *Advances*. The first issue will be available in 2014. Another exciting development is our new organizational set up. As of the 1st of July we have a new full-time Executive Director, Severine Bennett. Take the opportunity to meet and talk with her while you are here.

This ISPP meeting is carefully planned by Anita Bäckman of Congrex in conjunction with Paul Nesbitt Larking (our Vice-President for conferences) and Linda Skitka from the Chicago area. They deserve our warm thanks. Chicago, a city with a turbulent history, is an ideal locale for a conference on political psychology in times of contention.

Finally, I hope to see you at one of the social events, the Opening Reception, the Awards Reception or the Junior Scholar's Social Hour. Take the opportunity to have a drink with old friends or to make new friends and to congratulate our awardees.

I extend a warm welcome to all of you. I hope you have a wonderful time in Chicago both academically and socially. At its meetings the Society comes to live, enjoy being part of it.

BERT KLANDERMANS, ISPP President

WELCOME TO THE 35TH ANNUAL MEETING OF THE INTERNATIONAL SOCIETY OF POLITICAL PSYCHOLOGY!

We are delighted you are here and hope you enjoy the conference and your time in Chicago. At the cross-roads of the United States, Chicago is one of the world's most exciting cities. With its vibrant and often turbulent history, Chicago offers an ideal setting for a conference on political psychology with 'Identity Politics and Politicized Identities: Political Psychology in Times of Contention' as its timely theme. Enjoy the 2012 ISPP Annual Meeting in Chicago: the right place at the right time!

It is important to note that this conference contains a 'thematic chain' of panels and talks. Several thematic keynote addresses by eminent scholars have been scheduled during lunch time. In addition to the Presidential Address by Prof. Bert Klandermans, this year's conference will feature thematic keynote addresses by Prof. Ronald Fisher of American University, Prof. Katherine Reynolds of The Australian National University, and Prof. Felicia Pratto of the University of Connecticut. In addition, Anca Minescu programmed a fascinating chain of thematic sessions on Identity Politics and Politicized Identities. Next to the thematic chain, our section chairs have compiled an exciting program featuring roundtables, paper panels and poster sessions.

We also feature several panels and events which put junior scholars centre stage, including the Mentoring Tea, Publishing Roundtable, and Career Development Roundtable. Over 500 participants have come to Chicago to exchange ideas and learn from each other.

We hope that all of you will enjoy and participate in an exciting intellectual exchange that will enrich political psychology and help us better understand the dynamics of our contentious times.

We continue here in Chicago some innovative ways to increase discussion, engagement, and the sharing of ideas that were initiated so successfully last year in Istanbul. Log on to ISPP's Facebook page to get conference updates, chat, and see videos of key presentations. In Istanbul we worked with Michael Stretter from Wiley-Blackwell, the publisher of the society's journal, to record several interviews highlighting some of the work being done by young scholars in political psychology. So if a video camera is pointed at you, don't be shy!

Putting all of these people and ideas into a coherent program is not an easy task, yet we were extremely fortunate to have some amazing individuals working with us to create what we hope is a highly engaging and successful program. We first need to thank our section chairs who put the individual proposals into over 100 panels.

Our thanks go to Davide Morselli, Chris Cohrs, Chris Federico, Mike Wagner, Lene Aarhoe, Catarina Kinnvall, Jason Barabas, Michael Morrell, Cameron Thies, Michael Quayle, Eva Green, and Jozanneke van der Toorn. Thanks to Linda Skitka, the conference chair, for all of her work on the ground in Chicago. We were also helped by Paul Nesbitt Larkin, vice-president conferences, and the conference team at Congress led by Anita Bäckman. A special thanks goes to Farrah Graham, from ISPP's Central Office, who never seemed to tire of responding to the thousands of emails we sent her over the year. Bert Klandermans, president of the ISPP, deserves our heartfelt gratitude for inviting us to be the program chairs and for his advice and suggestions along the way. Finally, our biggest thank you goes to Katie Brown, our assistant. Katie's help has been absolutely vital at every step of our planning process. We cannot thank her enough for all the work she has done.

Enjoy the conference and have a wonderful stay in Chicago!

JACQUELIEN VAN STEKELBURG and NICHOLAS VALENTINO

FRIDAY 6 JULY 12.30 AM-1.30 PM SAUGANASH EAST

Power, prejudice, and personality:

Is progress in political and social psychology limited by a stability bias?

Katherine Reynolds, The Australian National University

In social and political psychology much effort is devoted to explanations and theories that largely focus on stability and the reproduction of existing social structures. These themes are evident, for example, in (a) the analysis of power as flowing from the top down, (b) arguments that prejudice persists because of early socialization that is deeply rooted in the unconscious, and (c) the psychology of personality as pre-determined and reasonably static. Such accounts have limitations for those focused on structural and social reform. Paradoxically this stability bias co-exists with evidence of considerable flexibility and variability in cognition and behavior. In this presentation I offer an integrated account that highlights the psychology of change as well as social stability.

This analysis not only broadens the theoretical focus, it offers new opportunities to contribute to public policy and social progress. I will outline theory and research concerning when and how the political and social, through changes in the meaning of identities and associated social norms, are interlinked with personal change (e.g., personality, prejudice, well-being). The implications of this and related work for a political psychology with renewed political and practical vigor will be discussed.

SATURDAY 7 JULY 12.30 AM-1.30 PM SAUGANASH EAST

Dialectical Identities:

The psychologies of dominance, resistance, and social change

Felicia Pratto, University of Connecticut

Political psychology is fundamentally concerned with how features of people, including their psychologies, cultures, societies, and histories, influence how they enact and try to control power. However, our conceptions of power can go beyond focusing on the nation-state, beyond a focus on leaders and leadership, and beyond a focus on power-hungry individuals and groups. Arguably, much of the world does not live in nation-states, yet their societies are governed. Focusing on elites and leaders ignores the agency and the power problems of most people, including the poor. To theoretically incorporate a universal psychology of power, which accounts for power dynamics and inequality, I introduce Power Basis Theory.

Power Basis Theory argues that power is pertinent to all people because it is the means of meeting universal survival needs, including wholeness, access to material resources, belonging, knowledge and transcendence. Power is not therefore just in the actions or agency of a person, but in the relationship of the person to her social and physical ecology. In social transactions, people sometimes use one form of power to gain other forms, producing power dynamics. Ethical and legal systems attempt to govern such transactions and may influence how much inequality or equality develops via those transactions. Using cross-national surveys and laboratory experiments, I show that people in structurally dominant and structurally dependent positions differ in what power actions and social rules they find ethical, in the methods of power use that appeal to them, and what they value. I also show that collective emergent outcomes of power transactions, including the level of inequality and mortality rates, result from power transactions. My talk aims to provide a theoretical scaffold for why moral psychology, governance issues, psychological processes, stereotypes and intergroup images, and collective identities provide for the dynamics of dominance, resistance, and social change.

SUNDAY 8 JULY 12.30 AM -13.30 PM SAUGANASH EAST

Fifty Years of Interactive Conflict Resolution: Applying Psychology to Polarized Identity Conflicts

Ronald J. Fisher, American University

The small group method of interactive conflict resolution, expressed mainly as problem-solving workshops, is approximately fifty years old in its application to intergroup and ethno-political conflicts. This address outlines the history, nature and forms of this social innovation with the focus on protracted and destructive conflicts between different identity groups, defined in ethnic, racial, religious or ideological terms.

The rationale for interactive conflict resolution is based mainly in a social-psychological analysis of escalated intergroup conflict and in social-psychological principles of interaction, both of which result in the expectations, strategies, and ground rules of the method. Despite evidence for its effectiveness, the major challenge facing interactive conflict resolution is the transfer from the individual effects experienced by workshop participants to the domains of policy making and political discourse. In addition, the diffusion of the method faces several continuing issues, such as funding, professionalization and institutionalization, not to mention concerns about cultural generalizability and cooptation by powerful actors to pursue their own policy agendas.

SUNDAY 8 JULY 5.00 PM -6.00 PM SAUGANASH EAST

Presidential Address: Identity politics and politicized identities

Bert Klendermans, VU University, Amsterdam

Over the last decades the concept of identity became increasingly central in the political psychology of protest. Collective identity, politicized collective identity, dual identity and multiple identities are concepts that help to understand and describe the social psychological dynamics of protest. In this presentation I will present a theoretical framework accounting for identity processes in the context of protest participation. I will use data from research among farmers, immigrants, South African citizens, and participants in street demonstrations to illustrate and underscore the argument. Identity processes play a crucial role in the dynamics of protest. In my presentation I will conceptualize the various kinds of identity processes that are involved: how group identification establishes the link between social identity and collective identity, how multiple identities and dual identities influence protest participation, how collective identity politicizes, and how politicization is linked to emotions. I will illustrate my argument with results from comparative research into collective action.

JSC WELCOME 2012

Welcome to the 35th Annual Meeting of the International Society of Political Psychology. This year's event, "Identity Politics and Politicized Identities: Political Psychology in Times of Contention," promises an array of innovative and important research from junior and senior scholars from around the world. I am pleased to announce that this year the JSC has arranged several events, which we hope you will attend.

JSC Social Hour. The JSC will host its annual social hour on Friday, July 6th at 5PM. This is a relatively informal event meant to facilitate interaction among junior scholars. The event is only open to junior scholars, which the ISPP defines as students and post-graduate scholars within eight years of receiving their degree. Drinks will be provided.

Roundtables. Two members of the JSC, Delia Dumetriscu and Lene Aarøe, have arranged two roundtables that focus on professional development and publishing in our field. Both roundtables are intended to initiate a dialogue between junior and senior scholars. On Saturday, July 7th at 10:45, the JSC will sponsor a career development roundtable entitled "Strategies for Successful and Effective Collaborations." The focus of this year's discussion will be the advantages and disadvantages of collaborative research. Three experienced senior scholars will offer advice regarding the advantages and disadvantages of collaborative research. The roundtable will focus on how to structure the division of labor in collaborative endeavors, when and how to negotiate and decide the order of the authors in an article, and advantages and potential pitfalls in interdisciplinary collaborations.

On Sunday, July 8th at 1:45, the JSC will hold "Publication Strategies for JSC." Experienced scholars from the field will offer advice to junior scholars about how to strengthen their research records. Discussion topics will include: How to choose an appropriate outlet for your research, how the peer review process works, how to decide whether a manuscript is ready for submission to a scholarly journal, and how to structure your workday to maintain research productivity.

Mentoring Tea. Monica Gerber and Jojanneke van der Toorn have arranged this year's mentoring tea, which will take place on Saturday, July 7th at 5PM. For those registered for the Tea, this event provides a one-on-one interaction between junior scholars and leading researchers in the field. Mentees are encouraged to discuss their research interests and projects. After the meeting, we hope this conversation will continue. We encourage mentors and mentees to maintain communication.

In addition to this year's event, our committee continues to manage several online services. Our blog (<http://www.ispp.org/jsc/blog>) and the ISPP Facebook page include up-to-date information about conferences, publications, and funding opportunities in our field. The JSC can also be followed through Twitter (@ISPP_JSC).

Finally, I would like to thank the 2011-2012 JSC for their hard work. It has been an honor being able to work with such a talented group. Finally, special thanks to all the individuals who have helped the JSC this year.

Enjoy the conference!

CHRISTOPHER WEBER, JSC Chair

Identity Politics & Politicization of Identity

Anca Minescu, University of Limerick

Political Conflict, Violence and Crisis

Davide Morselli, University of Lausanne

Intergroup Relations

Chris Cohrs, Queen's University Belfast

Leadership/Political Personality

Chris Federico, University of Minnesota

Public Opinion

Michael W. Wagner, University of Nebraska-Lincoln

Political Communication

Lene Aaroe, Aarhus University

Political Culture, Identity, and Language

Catarina Kinnvall, Lund University

Political Behavior and Electoral Participation

Jason Barabas, Florida State University

Democracy and Civic Development

Michael Morrell, University of Connecticut

International Relations, Globalization, Macropolitical Issues

Cameron Thies, University of Iowa

New Theoretical and Methodological Developments

Michael Quayle, University of KwaZulu-Natal

Social Inequality and Social Change

Jojanneke van der Toorn, Yale University

Migration and Acculturation

Eva Green, University of Lausanne

14TH FLOOR





15TH FLOOR

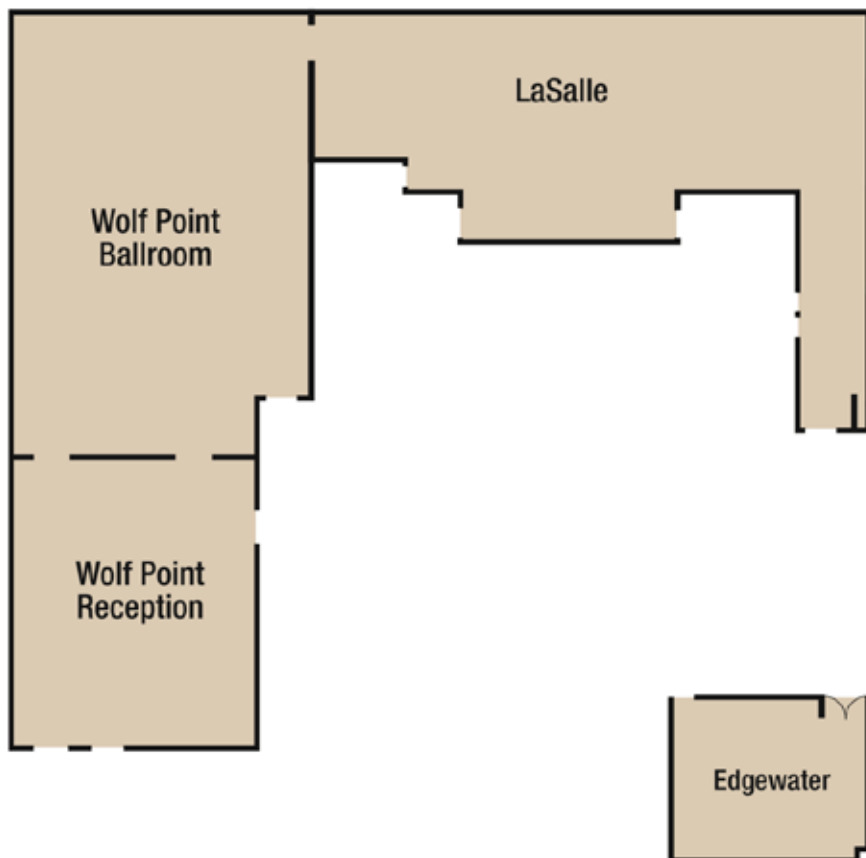

FRIDAY JULY 6

JSC Social Hour

Date: Friday July 6, at 5:00 PM – 6:00 PM.

Location: Petterino's, 150 North Dearborn Street, Chicago, IL 60601. Telephone Number: (312) 422-0150

Come and meet other junior scholars attending the conference. This event is for junior scholars only (graduate students and scholars within 8 years of degree). The reception is free of charge but you must indicate you plan to attend upon registration. Snacks and one glass of wine/beer per person will be served.

Opening Reception

Date: Friday July 6, at 6:00 PM.

Location: Petterino's, 150 North Dearborn Street, Chicago, IL 60601. Telephone Number: (312) 422-0150

The Opening Reception is free of charge but must you must indicate you plan to attend upon registration. Finger food will be served and drinks are available for purchase in the bar.

SATURDAY JULY 7

JSC Mentoring Tea

Date: Saturday July 7, at 5:00 PM – 6:00 PM.

Location: Holiday Inn Mart Plaza, Foyer of Sauganash Ballroom East, 14th floor

Through the mentoring program junior scholars and senior mentors with similar fields if interest meet one-on-one at this reception. The reception is for junior scholars and mentors only. It is free of charge but you must indicate you plan to attend upon registration. Coffee/tea and pastries will be served.

Reception for 'New Civics' sponsored by the Spencer Foundation

Date: Saturday July 7, at 5:30 PM – 7:00 PM

Location: Holiday Inn Mart Plaza, Edgewater room 15th floor

A reception celebrating the Spencer Foundation's initiative in research on New Civics. All attendees are welcome.

SUNDAY JULY 8

Awards Ceremony and Reception

Date: Sunday July 8, at 6:00 PM

Location: Holiday Inn Mart Plaza, Sauganash Ballroom East, 14th floor and Foyer of Sauganash Ballroom East

Join us in recognizing this year's award winners. The Awards Reception is free of charge but you must indicate you plan to attend upon registration. Finger food and one glass of wine/beer per person will be served.

ISPP MEETINGS

ISPP Governing Council Meeting

Date: July 5, at 9:00 AM – 5:00 PM

Location: LaSalle Room – 15th Floor

Editorial Board Lunch

Date: Friday July 6, at 12:30 AM – 1:45 PM

Location: Wolf Point Prefunction 15th Floor

ISPP Business Meeting

Date: July 9, at 12:30 AM – 1:30 PM

Location: Sauganash East

2012 AWARD WINNERS

Alexander George Book Award

Ervin Staub

'Overcoming Evil: Genocide, Violent Conflict and Terrorism'

Best Dissertation Award

Michael Quayle, University of Kwazulu-Natal, South Africa

"Situated Identity Performance: Understanding Stereotype Threat as a Social Identity Phenomenon"

David O. Sears Book Award

Clark McCauley & Sophia Moskalenko

Friction: How Radicalization Happens to Them and Us

Erik Erikson Award for Early Career Achievement

Eran Halperin, IDC Herzliya

Peter Hatemi, Penn State University

Jeanne Knutson Award for Long-Standing Service to ISPP

Doris Graber, University of Illinois, Chicago

Harold Lasswell Award for Distinguished Scientific Contributions

Ervin Staub, University of Massachusetts, Amherst

Nevitt Sanford Award for Professional Contributions to Political Psychology

Daniel Bar-Tal, Tel Aviv University

Noel Markwell Media Award

Shankar Vedantam, National Public Radio

Roberta Sigel Award 1

(for best paper by a junior scholar)

Rune Slothuus, Aarhus University

'Assessing the Influence of Political Parties on Public Opinion: The Bias from Pretreatment Effects'

Roberta Sigel Award 2

(for best paper with junior scholar as lead author)

Scott Clifford, Florida State University

with Jennifer Jerit and Jason Barabas 'Comparing Treatment Effects in Parallel Experiments'

ROBERTA SIGEL JSC PAPER AWARD

The Sigel Award is given to junior scholar authors of the best papers presented at annual scientific meetings. Nominees must be current ISPP members.

ISPP first announced this award at its Vancouver meeting in 1996. Professor Sigel, whom the award honors, has been a distinguished professor of political science at Rutgers University since 1973. She is author and editor of seven books and many articles and book chapters, mostly in the areas of political socialization and democratic citizenship. She has had many leadership roles in the American Political Science Association and has served as program chair, Vice-President and President of ISPP.

All ISPP junior scholars who are current dues paid members of ISPP and had their paper accepted for the 2012 summer meeting/conference are eligible to be considered for the award to be presented during the 2013 meeting. JSC are students (graduate or undergraduate) and faculty who received their Ph.D. within the last eight years. Each (of the two) award carries a cash prize of \$250.

There are two prizes with slightly different criteria to accommodate the authorship and publication practices in the various disciplines represented in ISPP:

- The first award is given to the best paper written by junior scholars only. In the case of multiple authors, all co-authors must be junior scholars.
- The second award is conferred to the best paper with a junior scholar first author. This award allows for a senior scholar co-author.

Please nominate (self-nominations are encouraged) eligible papers only (posters are not eligible) and submit them to the email below by February 15, 2013. Papers previously submitted to the Sigel Award are not eligible. All submissions will be read by the award committee, consisting of members of the Junior Scholar Committee as well as senior scholars. Two papers will be selected strictly according to scientific excellence and their contribution to research in political psychology.

For more information, see <http://ispp.org/archives/sigel.html>

Send nominations to:

Cindy Kam
Vanderbilt University
cindy.d.kam@vanderbilt.edu

BEST DISSERTATION AWARD ANNOUNCEMENT 2012

The International Society of Political Psychology is pleased to announce a call for nominations for the Best Dissertation Award, given for the first time at the 2008 Annual Meeting in Paris!

All Ph.D. dissertations within the field of political psychology are eligible for consideration, regardless of home discipline. Dissertations should represent an independent piece of research that is the sole work of the author and gains the highest degree at the author's university.

Nominations are due by Feb. 15, 2013, for dissertations completed and successfully defended between Jan. 1, 2012, and Dec. 31, 2012. **Nominees must be current ISPP members.**

Nominations should be submitted electronically and must include a one-page abstract (300 word), a 10-page (3,000 word) summary of the dissertation, and a letter of recommendation from the thesis adviser or committee member, all in English.

Send nominations to the 2013 Award Committee Chair:

Ann Crigler
University of Southern California
acrigler@usc.edu

The award committee will request a copy of the full dissertation for those selected to participate in the second-round evaluation. If the dissertation is written in a language other than English, the full dissertation may be submitted in the original language for the second-round evaluation, and at least one qualified reader fluent in that language will be included as a committee member for the second-round evaluation.

Israel 8-11 July 2013
The 36th Annual Meeting

POLITICAL PSYCHOLOGY OF GLOBAL CONFLICT, PROTEST AND RECONCILIATION.

To be held at:

Program in Political Psychology and Decision Making (POP-DM)
Lauder School of Government, Diplomacy and Strategy, IDC–Herzliya, Israel

Conference Organizer: Alex Mintz

Program Co-chairs: Alex Mintz (Chair), Daphna Canetti (Co-chair), Pazit Ben-Nun Bloom (Co-chair)

In the wake of changes brought about by the Arab Spring and the waves of incipient democratic as well as radical movements across the Middle East, and debates and conflicts over the global economic crisis, including threats to the Eurozone, we hope to highlight the role of conflict and protest in precipitating change. In addition, we hope to explore prospects for reconciliation in areas of endemic or enduring conflict, and invite innovative papers dealing with the resolution of protracted conflicts among identity groups.

We particularly welcome individual papers and posters, and entire panels and workshops presenting systematic analyses of factors precipitating conflict, instigating protest or promoting peace, recovery, cooperation and well-being at an individual, community, country or regional level of analysis. We are also interested in contributions examining the intersection of protest politics and political change on the one hand, and identity politics, ethnic-religious cleavages and conflict on the other.

We also encourage papers from the greater repertoire of the psychological sciences, including social, experimental, neuropsychological, developmental, biological and genetic analyses of political decision making and behavior. Such work might explore the interaction of culture and biology in shaping the structure of political institutions, or examine the role of developmental issues, including maternal malnutrition or childhood neglect, which often results during times of conflict, on prospects for violence, aggression and enduring cycles of conflict. Explicating the factors which affect human prospects for achieving peace and justice are of great importance in an increasingly unstable international system. Research which examines these areas, and highlights their interactions in precipitating harmony or dissension, is particularly welcome.



PLEASE JOIN US FOR OUR 2013
ANNUAL MEETING
JULY 8-11, 2013
LAUDER SCHOOL OF GOVERNMENT,
DIPLOMACY AND STRATEGY
IDC-HERZLIYA, ISRAEL

36th ANNUAL MEETING

ISRAEL

8-11 JULY 2013

FRIDAY JULY 6, 2012

ROOM/ TIME	AMERICAN	PETTERI- NO'S	BULLS HEAD	LAKE HOUSE	MANSION HOUSE	MER- CHANTS
FRI. 9:00AM			2J Justification and Violence: the Perpetrator's Perspective	7J Orange Identities: (Dis)continuities across space and time	3D Cognitive and Affective Processes in Ideology and Prejudice	9H The Development of Citizens
FRI. 10:45AM	8D The Psychology of Political Behavior		9G The Determinants of Political Participation and Cooperation	7F Narratives, Trauma and Reconciliation	2I Psychological and Political Consequences of Terrorism	5I Dynasties and Dynamics: Factors Affecting Democratic Attitudes
FRI. 12:30PM						
FRI. 1:45PM	3C Personality, Ideology, and Prejudice		12B Justice in the World: Antecedents and Consequences of Perceiving, Expressing, and Enacting Justice	11A Advances in political cognition	4G Narcissism and Politics: The "Specialness" of the Narcissist in Power	3M Dynamic Processes in Intergroup Relations
FRI. 3:30PM	6D Political deliberation and citizens' attitudes		2E Strategic Uses of Emotion and Interpretations in Conflict Resolution	3P Individual and Institutional Aspects of Discrimination	7E Social, Civic and Community Identity	12E Economically Vulnerable Groups in a Marketized World
FRI. 5:00PM		JSC's Social Hour				
FRI. 6:00PM		Opening Reception				

SAUGANASH EAST	SAUGANASH FOYER	SHAKESPEARE	STEAM-BOAT	WESTERN STAGE	WOLF POINT PREFUNCTION
1L Theme The Polarization Potential of Political Identities		5M Is Political Behavior Motivated by Style or Substance?	7L What is Radical? Language, Protest, and Conflict	5E Threat, Anxiety, and Tone	
1G Theme Political Action: from Strikes to Protest Participation		3J Group Identity and Prejudice	2B Complex Perspectives on Victimhood	4E The Political Psychology of the American Presidency	
Keynote Address by Katherine Reynolds					Political Psychology Editorial Board Luncheon
1A Theme Dynamics and Consequences of Politicised Identities		8H Political Psychology Worldwide	2G The Double Edges of Identity and Religion	7K Political Identities: Prejudices, Patriotism and Conflict	
1H Theme Political Identities in Current Movements: Egypt and Iran	12G Poster Session: Social Inequality and Social Change AND 3A Poster Session: Inter-group Relations	5C New Directions in the Study of Voting	4C Dynamics of Leadership, Personality, and Mass Perceptions	2N Staying Alive: The Political Psychology of Survival and Flourishing in a complex and hostile world	

SATURDAY JULY 7, 2012

ROOM/ TIME	AMERICAN	BULLS HEAD	EDGEWATER	LAKE HOUSE	MANSSION HOUSE
SAT. 9:00AM	3H Advances in Intergroup Contact Research	6I Scandal and negativity in political communication: Rhetoric and effects		Roundtable of Editors at Political Psychology	3N Morality, Religiosity, Values, and Ideology
SAT. 10:45AM	3K Ideological Dynamics under Threat and Competition	6E Political knowledge, deliberation and engagement		2D New Directions in Terrorism Research	4F Multiple Psychological Bases of Elite Decision Making in Diverse Contexts
SAT. 12:30PM					
SAT. 1:45PM	3G Individual and Social Context Influences on Intergroup Contact Effects	6A Cues in political communication: Persuasion and backlash effects		8B Experiments in Gender and Political Psychology	5L Political Combat: Conviction, Attitude Strength, and Authoritarianism
SAT. 3:30PM	2C Context Matters: Measuring the Impact of Social Ecologies of Political Violence on Adolescents and Mothers	9A Book Roundtable: No Citizen Left Behind		9F Morality, Justice Sensitivity, and Civil Courage	5B Do You See What I See? The Power of Perceptions
SAT. 5:00PM					
SAT. 5:30PM			Spencer Foundation Sponsored Reception for "New Civics"		

MER-CHANTS	SAUGA-NASH EAST	SAUGANASH FOYER	SHAKES-PEARE	STEAMBOAT	WESTERN STAGE
13B Acculturation, marginalisation and wellbeing	1C THEME Forging Identities in Different National Contexts		8G Cognition, Cues, and Certainty	2A Coping with the Effects of Violence	8F Experiments and Experimental Approaches
9I Youth Leading the Way: Redefining Civic Engagement for a New Era	1J THEME Political Motherhood	13C Poster Session: Acculturation, identity and immigration AND 20 Poster Session: Pathways to Reconciliation	5K Personality and Emotion	JSC Career Development Roundtable: Strategies for successful and effective collaborations	8A Advances in the Study of Emotions and Politics
	Keynote Address by Felicia Pratto				
4D Personality, Political Context, and Leadership	9C Constructing Ethical Games, Testing Their Psychological Impact	1E THEME Poster Session: Identity Politics and Politicized Identities AND 7I Poster Session: Minority Rights, Language Activism and Intergroup Perceptions	8C Information Processing and Political Knowledge	7D Ideology, Representation and Political Knowledge	2F The Power of a Word: Social Psychological Processes and Consequences of Using the Term "Genocide"
11G Theoretical advances in Ideology, polarization and order	1K THEME Politicising Religion In Contemporary Indonesia	11D Poster Session: New theoretical and methodological developments AND 9B Poster Session: Civic Development and Civic Education	8E Partisanship & Identity	7B National and European Identity: Foreign policy and decision-making	12D Working for the Group? The Interplay between Emotions, Motivations, and Engagement in Protest or Cooperation
		JSC Mentoring Tea			

SUNDAY JULY 8, 2012

ROOM/ TIME	AMERICAN	BULLS HEAD	LAKE HOUSE	MANSION HOUSE	MER- CHANTS
SUN. 9:00AM	6H Politicization, Polarization, and Health Policy Opinion	3O Towards Positive Intergroup Relations	10A Ethnocentrism and National Images	2P The Rise of Extremism and Political Violence	
SUN. 10:45AM	7C Political Discourses, Symbols and Politicized Identities	2L Understanding power and power motivation: Fighting, Persuading, and Taming	13A Immigration, multiculturalism and political attitudes	11B Legitimacy and morality	5F Conspiracies and Cooperation in Public Opinion
SUN. 12:30PM					
SUN. 1:45PM	2M International Conflicts: an Interstate Perspective	6G Priming	11F Where do we go from here? Reflections on the POPS Special Issue	JSC Publishing Roundtable: Publication Strategies for JSC	10B Identity, Decision-making, and Global Processes
SUN. 3:30PM	2Q Counterterrorism as fear management	12F Social Dominance Theory and the Psychology of Inclusion	6K Communication mode, media effects and citizens' attitudes	11E Political identities, institutions, structures and their relations	5D How People Think About Divisive Issues
SUN. 5:00PM					
SUN. 6:00PM					
SUN. 7:00PM					

SAUGANASH EAST	SAUGANASH FOYER	SHAKESPEARE	STEAMBOAT	WESTERN STAGE
1B THEME Emotions as Antecedents and Consequences of Collective Action		3B Authoritarianism and Conformity		5H Do Ideological Differences Run Deep?
1I THEME Political Impacts of Political Identity: Experimental Approaches		9E How Political Socialization Research Became Civic Engagement Research: Reflections from 1962 to 2012	5J Religion, Culture, and Issues	6B Emotions in political communication and citizens' attitude formation
Keynote Address by Ronald Fisher				
1M THEME Models of Collective Action		12A Cooperation in Context: Antecedents and Limits of Tolerance	7H In-Group Glorification: Emotions, Identity and Youth	5N Liberals are From Mars, Conservatives are From Venus
1D THEME History Education and the Construction of Identities	5A Poster Session: Electoral Behavior, Participation, and Public Opinion AND 8J Poster Session: Political Behavior and Political Communication	3E Empirical Tests of Modern Anti-semitism	6F Political violence, rhetoric of destruction and citizens' coping strategies	3F Historical Trends in Political Attitudes and Prejudice
Presidential Address by Bert Klendermans				
Awards Ceremony				
	Awards Reception			

MONDAY JULY 9, 2012

ROOM/ TIME	AMERICAN	BULLS HEAD	LAKE HOUSE	MANSION HOUSE
MON. 9:00AM	6C Framing	12C Reducing Inequality: The Individual, the Group, and the System	9D Democracy and Its Institutions	4B Indirect Assessments of Leader Personality
MON. 10:45AM		8I Awareness, Affect, and Attitudes		2K Perpetuating and Overcoming Oppression and War: Bridging Collective Representations, Political Rhetoric, and Psychological Processes
MON. 12:30PM				

MERCHANTS	SAUGANASH EAST	SHAKESPEARE	STEAMBOAT	WESTERN STAGE
2H Pathways to Reconciliation: the Contact Hypothesis	5G Advances in Measurement	3I Stereotyping and Discrimination	3L Negotiating Group Identity	2R Resistance to Oppression
7A Narratives, Memory and Borders		6J Scandalization, intimidation and personalization? Investigating coverage and reception of politicians in the media	4A Leadership and Conceptions of the Political	
	ISPP Business Meeting			7G Democracy, Ideology and Rights

ISPP 35TH ANNUAL SCIENTIFIC MEETING

Fri. 12:30	Keynote Address by Katherine Reynolds, The Australian National University
Fri. 12:30	Political Psychology Editorial Board Luncheon
Fri. 5:00	JSC's Social Hour
Fri. 6:00	Opening Reception
Sat. 9:00	Roundtable of Editors at Political Psychology
Sat. 10:45	JSC Career Development Roundtable: Strategies for successful and effective collaborations
Sat. 12:30	Address by Felicia Pratto, University of Connecticut (Keynote)
Sat. 5:00	JSC Mentoring Tea
Sat. 5:30	Spencer Foundation-sponsored Reception for "New Civics"
Sun. 12:30	Keynote Address by Ronald J. Fisher, American University
Sun. 1:45	JSC Publishing Roundtable: Publication Strategies for JSC
Sun. 5:00	Presidential Address by Bert Klendermans
Sun. 6:00	Awards Ceremony
Sun. 7:00	Awards Reception
Mon. 12:30	ISPP Business Meeting

THEMATIC SESSION: IDENTITY POLITICS AND POLITICIZED IDENTITIES

Fri. 9:00	THEME The Polarization Potential of Political Identities (1L)
Fri. 10:45	THEME Political Action: from Strikes to Protest Participation (1G)
Fri. 1:45	THEME Dynamics and Consequences of Politicized Identities (1A)
Fri. 3:30	THEME Political Identities in Current Movements: Egypt and Iran (1H)
Sat. 9:00	THEME Forging Identities in Different National Contexts (1C)
Sat. 10:45	THEME Political Motherhood (1J)
Sat. 1:45	THEME Poster Session: Identity Politics and Politicized Identities AND Poster Session: Minority Rights, Language Activism and Intergroup Perceptions (1E)
Sat. 3:30	THEME Politicizing Religion In Contemporary Indonesia (1K)
Sun. 9:00	THEME Emotions as Antecedents and Consequences of Collective Action (1B)
Sun. 10:45	THEME Political Impacts of Political Identity: Experimental Approaches (1I)
Sun. 1:45	THEME Models of Collective Action (1M)
Sun. 3:30	THEME History Education and the Construction of Identities (1D)

POLITICAL CONFLICT, VIOLENCE, AND CRISIS

Fri. 9:00	Justification and Violence: the Perpetrator's Perspective (2J)
Fri. 10:45	Complex Perspectives on Victimhood (2B)
Fri. 10:45	Psychological and Political Consequences of Terrorism (2I)
Fri. 1:45	The Double Edges of Identity and Religion (2G)
Fri. 3:30	Strategic Uses of Emotion and Interpretations in Conflict Resolution (2E)
Fri. 3:30	Staying Alive: The Political Psychology of Survival and Flourishing in

	a complex and hostile world (2N)
Sat. 9:00	Coping with the Effects of Violence (2A)
Sat. 10:45	New Directions in Terrorism Research (2D)
Sat. 10:45	Poster Session: Pathways to Reconciliation- Identity and Categorization Hypotheses (2O)
Sat. 1:45	The Power of a Word: Social Psychological Processes and Consequences of Using the Term “Genocide” (2F)
Sat. 3:30	Context Matters: Measuring the Impact of Social Ecologies of Political Violence on Adolescents and Mothers (2C)
Sun. 9:00	The Rise of Extremism and Political Violence (2P)
Sun. 10:45	Understanding power and power motivation: Fighting, Persuading, and Taming (2L)
Sun. 1:45	International Conflicts: an Interstate Perspective (2M)
Sun. 3:30	Counterterrorism as fear management (2Q)
Mon. 9:00	Pathways to Reconciliation: the Contact Hypothesis (2H)
Mon 9:00	Resistance to Oppression (2R)
Mon. 10:45	Perpetuating and Overcoming Oppression and War: Bridging Collective Representations, Political Rhetoric, and Psychological Processes (2K)

INTERGROUP RELATIONS

Fri. 9:00	Cognitive and Affective Processes in Ideology and Prejudice (3D)
Fri. 10:45	Group Identity and Prejudice (3J)
Fri. 1:45	Personality, Ideology, and Prejudice (3C)
Fri. 1:45	Dynamic Processes in Intergroup Relations (3M)
Fri. 3:30	Poster Session: Intergroup Relations (3A)
Fri. 3:30	Individual and Institutional Aspects of Discrimination (3P)
Sat. 9:00	Advances in Intergroup Contact Research (3H)
Sat. 9:00	Morality, Religiosity, Values, and Ideology (3N)
Sat. 10:45	Ideological Dynamics under Threat and Competition (3K)
Sat. 1:45	Individual and Social Context Influences on Intergroup Contact Effects (3G)
Sun. 9:00	Authoritarianism and Conformity (3B)
Sun. 9:00	Towards Positive Intergroup Relations (3O)
Sun. 3:30	Empirical Tests of Modern Anti-Semitism (3E)
Sun. 3:30	Historical Trends in Political Attitudes and Prejudice (3F)
Mon. 9:00	Stereotyping and Discrimination (3I)
Mon. 9:00	Negotiating Group Identity (3L)

LEADERSHIP AND POLITICAL PERSONALITY

Fri. 10:45	The Political Psychology of the American Presidency (4E)
Fri. 1:45	Narcissism and Politics: The “Specialness” of the Narcissist in Power (4G)
Fri. 3:30	Dynamics of Leadership, Personality, and Mass Perceptions (4C)
Sat. 10:45	Multiple Psychological Bases of Elite Decision Making in Diverse Contexts (4F)
Sat. 1:45	Personality, Political Context, and Leadership (4D)

Mon. 9:00 Indirect Assessments of Leader Personality (4B)
Mon. 10:45 Leadership and Conceptions of the Political (4A)

ELECTORAL BEHAVIOR AND PUBLIC OPINION

Fri. 9:00 Threat, Anxiety, and Tone (5E)
Fri. 9:00 Is Political Behavior Motivated by Style or Substance? (5M)
Fri. 10:45 Dynasties and Dynamics: Factors Affecting Democratic Attitudes (5I)
Fri. 3:30 New Directions in the Study of Voting (5C)
Sat. 10:45 Personality and Emotion (5K)
Sat. 1:45 Political Combat: Conviction, Attitude Strength, and Authoritarianism (5L)
Sat. 3:30 Do You See What I See? The Power of Perceptions (5B)
Sun. 9:00 Do Ideological Differences Run Deep? (5H)
Sun. 10:45 Conspiracies and Cooperation in Public Opinion (5F)
Sun. 10:45 Religion, Culture, and Issues (5J)
Sun. 1:45 Liberals are From Mars, Conservatives are From Venus (5N)
Sun. 3:30 Poster Session: Electoral Behavior, Participation, and Public Opinion AND 8J Poster Session: Political Behavior and Political Communication (5A)
Sun. 3:30 How People Think About Divisive Issues (5D)
Mon. 9:00 Advances in Measurement (5G)

POLITICAL COMMUNICATION

Fri. 3:30 Political deliberation and citizens' attitudes (6D)
Sat. 9:00 Scandal and negativity in political communication: Rhetoric and effects (6I)
Sat. 10:45 Political knowledge, deliberation and engagement (6E)
Sat. 1:45 Cues in political communication: Persuasion and backlash effects (6A)
Sun. 9:00 Politicization, Polarization, and Health Policy Opinion (6H)
Sun. 10:45 Emotions in political communication and citizens' attitude formation (6B)
Sun. 1:45 Priming (6G)
Sun. 3:30 Political violence, rhetoric of destruction and citizens' coping strategies (6F)
Sun. 3:30 Communication mode, media effects and citizens' attitudes (6K)
Mon. 9:00 Framing (6C)
Mon. 10:45 Scandalization, intimidation and personalization? Investigating coverage and reception of politicians in the media (6J)

POLITICAL CULTURE, IDENTITY, AND LANGUAGE

Fri. 9:00 Orange Identities: (Dis)continuities across space and time (7J)
Fri. 9:00 What is Radical? Language, Protest, and Conflict (7L)
Fri. 10:45 Narratives, Trauma and Reconciliation (7F)

Fri. 1:45	Political Identities: Prejudices, Patriotism and Conflict (7K)
Fri. 3:30	Social, Civic and Community Identity (7E)
Sat. 1:45	Ideology, Representation and Political Knowledge (7D)
Sat. 1:45	Poster Session: Minority Rights, Language Activism and Intergroup Perceptions (7I)
Sat. 3:30	National and European Identity: Foreign policy and decision-making (7B)
Sun. 10:45	Political Discourses, Symbols and Politicized Identities (7C)
Sun. 1:45	In-Group Glorification: Emotions, Identity and Youth (7H)
Mon. 10:45	Narratives, Memory and Borders (7A)
Mon. 10:45	Democracy, Ideology and Rights (7G)

POLITICAL BEHAVIOR AND ELECTORAL DECISION MAKING

Fri. 10:45	The Psychology of Political Behavior (8D)
Fri. 1:45	Political Psychology Worldwide (8H)
Sat. 9:00	Experiments and Experimental Approaches (8F)
Sat. 9:00	Cognition, Cues, and Certainty (8G)
Sat. 10:45	Advances in the Study of Emotions and Politics (8A)
Sat. 1:45	Experiments in Gender and Political Psychology (8B)
Sat. 1:45	Information Processing and Political Knowledge (8C)
Sat. 3:30	Partisanship & Identity (8E)
Sun. 3:30	Poster Session: Political Behavior and Political Communication (8J)
Mon. 10:45	Awareness, Affect, and Attitudes (8I)

CIVIC ENGAGEMENT AND CIVIC DEVELOPMENT

Fri. 9:00	The Development of Citizens (9H)
Fri. 10:45	The Determinants of Political Participation and Cooperation (9G)
Sat. 10:45	Youth Leading the Way: Redefining Civic Engagement for a New Era (9I)
Sat. 1:45	Constructing Ethical Games, Testing Their Psychological Impact (9C)
Sat. 3:30	Book Roundtable: No Citizen Left Behind (9A)
Sat. 3:30	Poster Session: Civic Development and Civic Education (9B)
Sat. 3:30	Morality, Justice Sensitivity, and Civil Courage (9F)
Sun. 10:45	How Political Socialization Research Became Civic Engagement Research: Reflections from 1962 to 2012 (9E)
Mon. 9:00	Democracy and Its Institutions (9D)

INTERNATIONAL RELATIONS, GLOBALIZATION, MACROPOLITICAL ISSUES

Sun. 9:00	Ethnocentrism and National Images (10A)
Sun. 1:45	Identity, Decision-making, and Global Processes (10B)

NEW THEORETICAL AND METHODOLOGICAL DEVELOPMENTS

Fri. 1:45	Advances in political cognition (11A)
Sat. 3:30	Poster Session: New theoretical and methodological developments

	AND 9B Poster Session: Civic Development and Civic Education (11D)
Sat. 3:30	Theoretical advances in Ideology, polarization and order (11G)
Sun. 10:45	Legitimacy and morality (11B)
Sun. 1:45	Where do we go from here? Reflections on the POPS Special Issue (11F)
Sun. 3:30	Political identities, institutions, structures and their relations (11E)

SOCIAL INEQUALITY AND SOCIAL CHANGE

Fri. 1:45	Justice in the World: Antecedents and Consequences of Perceiving, Expressing, and Enacting Justice (12B)
Fri. 3:30	Economically Vulnerable Groups in a Marketized World (12E)
Fri. 3:30	Poster Session: Social Inequality and Social Change AND 3A Poster Session: Intergroup Relations (12G)
Sat. 3:30	Working for the Group? The Interplay between Emotions, Motivations, and Engagement in Protest or Cooperation (12D)
Sun. 1:45	Cooperation in Context: Antecedents and Limits of Tolerance (12A)
Sun. 3:30	Social Dominance Theory and the Psychology of Inclusion (12F)
Mon. 9:00	Reducing Inequality: The Individual, the Group, and the System (12C)

MIGRATION AND ACCULTURATION

Sat. 9:00	Acculturation, marginalisation and wellbeing (13B)
Sat. 10:45	Poster Session: Acculturation, identity and immigration AND 20
	Poster Session: Pathways to Reconciliation (13C)
Sun. 10:45	Immigration, multiculturalism and political attitudes (13A)

ISPP SESSIONS BY DAY AND TIME

FRIDAY, JULY 6 9:00 AM-10:30 AM

- F1.1 1L THEME The Polarization Potential of Political Identities
- F1.2 2J Justification and Violence: the Perpetrator's Perspective
- F1.3 3D Cognitive and Affective Processes in Ideology and Prejudice
- F1.4 5M Is Political Behavior Motivated by Style or Substance?
- F1.5 5E Threat, Anxiety, and Tone
- F1.6 7J Orange Identities: (Dis)continuities across space and time
- F1.7 7L What is Radical? Language, Protest, and Conflict
- F1.8 9H The Development of Citizens

FRIDAY, JULY 6 10:45 AM-12:15 PM

- F2.1 1G THEME Political Action: from Strikes to Protest Participation
- F2.2 2I Psychological and Political Consequences of Terrorism
- F2.3 2B Complex Perspectives on Victimhood
- F2.4 3J Group Identity and Prejudice
- F2.5 4E The Political Psychology of the American Presidency
- F2.6 5I Dynasties and Dynamics: Factors Affecting Democratic Attitudes
- F2.7 7F Narratives, Trauma and Reconciliation
- F2.8 8D The Psychology of Political Behavior
- F2.9 9G The Determinants of Political Participation and Cooperation

FRIDAY, JULY 6 12:30 PM-1:30 PM

- F3.1 Keynote Address by Katherine Reynolds
- F3.2 Political Psychology Editorial Board Luncheon

FRIDAY, JULY 6 1:45 PM-3:15 PM

- F4.1 1A THEME Dynamics and Consequences of Politicized Identities
- F4.2 2G The Double Edges of Identity and Religion
- F4.3 3C Personality, Ideology, and Prejudice
- F4.4 3M Dynamic Processes in Intergroup Relations
- F4.5 4G Narcissism and Politics: The "Specialness" of the Narcissist in Power
- F4.6 7K Political Identities: Prejudices, Patriotism and Conflict
- F4.7 8H Political Psychology Worldwide
- F4.8 11A Advances in political cognition
- F4.9 12B Justice in the World:
Antecedents and Consequences of Perceiving, Expressing, and Enacting Justice

FRIDAY, JULY 6 3:30 PM-5:00 PM

- F5.1 1H THEME Political Identities in Current Movements: Egypt and Iran
- F5.2 2E Strategic Uses of Emotion and Interpretations in Conflict Resolution
- F5.3 2N Staying Alive: The Political Psychology of Survival and Flourishing in a complex and hostile world
- F5.4 3P Individual and Institutional Aspects of Discrimination
- F5.5 12G Poster Session: Social Inequality and Social Change
AND 3A Poster Session: Intergroup Relations

- F5.6 4C Dynamics of Leadership, Personality, and Mass Perceptions
- F5.7 5C New Directions in the Study of Voting
- F5.8 6D Political deliberation and citizens' attitudes
- F5.9 7E Social, Civic and Community Identity
- F5.10 12E Economically Vulnerable Groups in a Marketized World

FRIDAY, JULY 6 5:00 PM-6:00 PM

- F6.1 Junior Scholar's Social Hour

FRIDAY, JULY 6 6:00 PM-9:00 PM

- F7.1 Opening Reception

SATURDAY, JULY 7 9:00 AM-10:30 AM

- S1.1 Roundtable of Editors at Political Psychology
- S1.2 1C THEME Forging Identities in Different National Contexts
- S1.3 2A Coping with the Effects of Violence
- S1.4 3H Advances in Intergroup Contact Research
- S1.5 3N Morality, Religiosity, Values, and Ideology
- S1.6 6I Scandal and negativity in political communication: Rhetoric and effects
- S1.7 8G Cognition, Cues, and Certainty
- S1.8 8F Experiments and Experimental Approaches
- S1.9 13B Acculturation, marginalisation and wellbeing

SATURDAY, JULY 7 10:45 AM-12:15 PM

- S2.1 JSC Career Development Roundtable:
Strategies for successful and effective collaborations
- S2.2 1J THEME Political Motherhood
- S2.3 2D New Directions in Terrorism Research
- S2.4 13C Poster Session: Acculturation, identity and immigration
AND 2O Poster Session: Pathways to Reconciliation
- S2.5 3K Ideological Dynamics under Threat and Competition
- S2.6 4F Multiple Psychological Bases of Elite Decision Making in Diverse Contexts
- S2.7 5K Personality and Emotion
- S2.8 6E Political knowledge, deliberation and engagement
- S2.9 8A Advances in the Study of Emotions and Politics
- S2.10 9I Youth Leading the Way: Redefining Civic Engagement for a New Era

SATURDAY, JULY 7 1:45 PM-3:15 PM

- S4.1 1E THEME Poster Session: Identity Politics and Politicized Identities AND 7I Poster
Session: Minority Rights, Language Activism and Intergroup Perceptions
- S4.2 2F The Power of a Word: Social Psychological Processes and Consequences
of Using the Term "Genocide"
- S4.3 3G Individual and Social Context Influences on Intergroup Contact Effects
- S4.4 4D Personality, Political Context, and Leadership
- S4.5 5L Political Combat: Conviction, Attitude Strength, and Authoritarianism
- S4.6 6A Cues in political communication: Persuasion and backlash effects
- S4.7 7D Ideology, Representation and Political Knowledge
- S4.8 8B Experiments in Gender and Political Psychology

■ SESSIONS
by day and time

- S4.9 8C Information Processing and Political Knowledge
S4.10 9C Constructing Ethical Games, Testing Their Psychological Impact

SATURDAY, JULY 7 3:30 PM-5:00 PM

- S5.1 1K THEME Politicizing Religion In Contemporary Indonesia
S5.2 2C Context Matters: Measuring the Impact of Social Ecologies
of Political Violence on Adolescents and Mothers
S5.3 5B Do You See What I See? The Power of Perceptions
S5.4 7B National and European Identity: Foreign policy and decision-making
S5.5 8E Partisanship & Identity
S5.6 9A Book Roundtable: No Citizen Left Behind
S5.7 9F Morality, Justice Sensitivity, and Civil Courage
S5.8 11D Poster Session: New theoretical and methodological developments
AND 9B Poster Session: Civic Development and Civic Education
S5.9 11G Theoretical advances in Ideology, polarization and order
S5.10 12D Working for the Group? The Interplay between Emotions,
Motivations, and Engagement in Protest or Cooperation

SATURDAY, JULY 7 5:00 PM-6:00 PM

- S6.1 JSC Mentoring Tea

SATURDAY, JULY 7 5:30 PM-7:00 PM

- S7.1 Spencer Foundation Sponsored Reception for “New Civics”

SUNDAY, JULY 8 9:00 AM-10:30 AM

- S1.1 1B THEME Emotions as Antecedents and Consequences of Collective Action
S1.2 2P The Rise of Extremism and Political Violence
S1.3 3O Towards Positive Intergroup Relations
S1.4 3B Authoritarianism and Conformity
S1.5 5H Do Ideological Differences Run Deep?
S1.6 6H Politicization, Polarization, and Health Policy Opinion
S1.7 10A Ethnocentrism and National Images

SUNDAY, JULY 8 10:45 AM-12:15 PM

- S2.1 1I THEME Political Impacts of Political Identity: Experimental Approaches
S2.2 2L Understanding power and power motivation: Fighting, Persuading, and Taming
S2.3 5F Conspiracies and Cooperation in Public Opinion
S2.4 5J Religion, Culture, and Issues
S2.5 6B Emotions in political communication and citizens' attitude formation
S2.6 7C Political Discourses, Symbols and Politicized Identities
S2.7 9E How Political Socialization Research Became Civic Engagement Research:
Reflections from 1962 to 2012
S2.8 11B Legitimacy and morality
S2.9 13A Immigration, multiculturalism and political attitudes

SUNDAY, JULY 8 12:30 PM-1:30 PM

S3.1 Keynote Address by Ronald Fisher

SUNDAY, JULY 8 1:45 PM-3:15 PM

S4.1 JSC Publishing Roundtable: Publication Strategies for JSC
S4.2 1M THEME Models of Collective Action
S4.3 2M International Conflicts: an Interstate Perspective
S4.4 5N Liberals are From Mars, Conservatives are From Venus
S4.5 6G Priming
S4.6 7H In-Group Glorification: Emotions, Identity and Youth
S4.7 10B Identity, Decision-making, and Global Processes
S4.8 11F Where do we go from here? Reflections on the POPS Special Issue
S4.9 12A Cooperation in Context: Antecedents and Limits of Tolerance

SUNDAY, JULY 8 3:30 PM-5:00 PM

S5.1 1D THEME History Education and the Construction of Identities
S5.2 2Q Counterterrorism as fear management
S5.3 3E Empirical Tests of Modern Anti-Semitism
S5.4 3F Historical Trends in Political Attitudes and Prejudice
S5.5 5D How People Think About Divisive Issues
S5.6 5A Poster Session: Electoral Behavior, Participation, and Public Opinion AND 8J Poster Session: Political Behavior and Political Communication
S5.7 6K Communication mode, media effects and citizens' attitudes
S5.8 6F Political violence, rhetoric of destruction and citizens' coping strategies
S5.9 11E Political identities, institutions, structures and their relations
S5.10 12F Social Dominance Theory and the Psychology of Inclusion

SUNDAY, JULY 8 5:00 PM-6:00 PM

S6.1 Presidential Address by Bert Klendermans

SUNDAY, JULY 8 6:00 PM-7:00 PM

S7.1 Awards Ceremony

SUNDAY, JULY 8 7:00 PM-8:30 PM

S8.1 Awards Reception

MONDAY, JULY 9 9:00 AM-10:30 AM

M1.1 2H Pathways to Reconciliation: the Contact Hypothesis
M1.2 3I Stereotyping and Discrimination
M1.3 3L Negotiating Group Identity
M1.4 4B Indirect Assessments of Leader Personality
M1.5 5G Advances in Measurement
M1.6 6C Framing
M1.7 9D Democracy and Its Institutions
M1.8 12C Reducing Inequality: The Individual, the Group, and the System
M1.9 2R Resistance to Oppression



Join us on Facebook

YOU WILL BE ABLE TO:

- CHAT with other conference delegates
- VIEW conference updates
- DOWNLOAD and VIEW webcasts
of presentations
- GIVE feedback about the conference

TO FIND US

Search for “International Society of Political
Psychology” on Facebook

OR GO TO

<http://www.facebook.com/ISPPJuniorScholars>

Once you have found our page,
“Like it” and you will join the group!

FRIDAY, JULY 6 9:00 AM-10:30 AM

F1.1 1L THEME The Polarization Potential of Political Identities

Room: Sauganash East

Section: Thematic session: Identity Politics and Politicized Identities

You are either with us, or against us

* *Madeleine Moret*, University of Amsterdam - Ph.D.

People of Color Identification as a Politicized Identity: Examining
Coalition Building Between Racial Minorities

* *Manisha Gupta*, UMass Amherst

Brian Lickel, UMass Amherst

Comparative analysis of the image of the state in consciousness of Russian and French students

* *Olga Sergeevna Deyneka*, St. Petersburg State University

Group dynamics and deliberative processes: Affective and cognitive aspects

* *Luisa Batalha*, The Australian National University

Chair: *Melinda Jackson*, San Jose State University

Discussant: *Jacquelien van Stekelenburg*, VU University

F1.2 2J Justification and Violence: the Perpetrator's Perspective

Room: Bulls Head

Section: Political conflict, violence, and crisis

How do perpetrators justify atrocities?

* *Alette Smeulers*, Tilburg University

Accused by the ICTY: role perceptions against the backdrop of collective realities

* *Mina Rauschenbach*, Geneva Academy of International Humanitarian Law and Human Rights

The Secret Weapon of Optimism

* *Eyal Lewin*, Ariel University Center

Just and Unjust Wars: a survey of experts across the political spectrum

Walter Dorn, Canadian Forces College and Royal Military College of Canada

David R Mandel, Defence Research and Development Canada – Toronto

* *Ryan Wayne Cross*, University of British Columbia – Department of Psychology

Chair: *Alette Smeulers*, Tilburg University

F1.3 3D Cognitive and Affective Processes in Ideology and Prejudice

Room: Mansion House

Section: Intergroup relations

Political Ideology and Construal Levels: Their Effects on Essentialist Thinking about Sexual Orientation

**David Abraham Kalkstein*, New York University

Chadly Stern, New York University

John Jost, New York University

Yaacov Trope, New York University

Reconstruing Intolerance: Abstract Thinking Reduces Conservatives' Prejudice against Non-Normative Groups

**Jamie Luguri*, Yale University

Jaime Lynn Napier, Yale University

John Dovidio, Yale University

Seize and Freeze: Anchoring Perceptions of Societal Danger Reveals the Openness to Experience Cognitive Mechanism

**Ryan Perry*, The University of Auckland

Chris G. Sibley, University of Auckland

John Duckitt, University of Auckland

The Scent Of Bigotry: Environmental Scents Affect Ethnic Prejudice

**Agnieszka Golec de Zavala*, CIS IUL, Portugal

Chair: *Agnieszka Golec de Zavala*, CIS IUL, Portugal

F1.4 5M Is Political Behavior Motivated by Style or Substance?

Room: Shakespeare

Section: Electoral behavior and public opinion

Economic and Cultural Conservatives: Different Dimensions, Different Motivations

**Jeff Brooks*, University of Notre Dame

**Paul Stey*, University of Notre Dame

**Darcia Narvaez*, University of Notre Dame

Inside the mind of a voter.

**Michael Bruter*, LSE

**Sarah Harrison*, LSE

Locating 'personas' in the political field: Towards a heuristic model of values, voting preference and media consumption

**Taylor Burns*, University of Cambridge

**Jose Liht*, University of Cambridge

Mike Ditka's a Republican? The Effect of Celebrity Endorsements on Candidate Evaluation

**Andrew J.W. Civettini*, Knox College

**Beth Miller*, University of Missouri-Kansas City

Chair: *Kristen Lyons*, University of Minnesota

Discussant: *Adam Seth Levine*, University of Michigan

F1.5 5E Threat, Anxiety, and Tone

Room: Western Stage

Section: Electoral behavior and public opinion

Mortal Morality: The Role of Threat in Partisan Worldviews and Moral Judgments.

**Todd K Hartman*, Appalachian State University

**C. Scott Bell*, Appalachian State University

Priming and Presidential Approval: Asymmetric Effects of Positive and Negative Information.

Justin W. Holmes, University of Northern Iowa

**Bas Willem van Doorn*, College of Wooster

The Effect of Anxiety on Learning.

**Stanley Feldman*, Department of Political Science, Stony Brook University (USA)

**Leonie Huddy*, Stony Brook University

Chair: *Carly Jacobs*, University of Nebraska-Lincoln

Discussant: *Carly Jacobs*, University of Nebraska-Lincoln

F1.6 7J Orange Identities: (Dis)continuities across space and time

Room: Lake House

Section: Political culture, identity, and language

The Orange Order and Orangeism in Canada.

**Paul Nesbitt-Larking*, Huron University College

**James White McAuley*, University of Huddersfield

'Blood, Thunder and Traditional Routes: an ethnography of Orangeism'.

**James White McAuley*, University of Huddersfield

**Jonathan Tonge*, University of Liverpool

**Andy Mycock*, University of Huddersfield

Political Socialisation and Cultural Learning in the Orange Order in Northern Ireland.

**James White McAuley*, University of Huddersfield

**Andy Mycock*, University of Huddersfield

**Jonathan Tonge*, University of Liverpool

Chair: *Orla Muldoon*, University of Limerick

Discussant: *Neil Ferguson*, Liverpool Hope University

F1.7 7L What is Radical? Language, Protest, and Conflict

Room: Steamboat

Section: Political culture, identity, and language

Divided by a Common Language: How Authorities Understand the Radicalisation of Muslims.

**Leda Blackwood*, St. Andrews University

Nick Hopkins, University of Dundee
Stephen Reicher, St. Andrews University

Ethnic and National Identification in Turkey: Perceived Threat in the Form of Extremism and Separatism and its Consequences for the Ethnic Minority.

**Yasemin Acar*, Claremont Graduate University

The effect of psychological distance on inter-group perception and interpretation of events: case of Iranians' protest of President Ahmadinejad's re-election.

**Mostafa Salari Rad*, The New School for Social Research
Jeremy Ginges, New School for Social Research

Discussant: *Catarina Kinnvall*, Lund University

F1.8 9H The Development of Citizens

Room: Merchants

Section: Civic engagement and civic development

Becoming a Good Citizen in China: A Survey Study of Chinese Adolescents' Civic Beliefs, Values, and Activities.

Xu Zhao, Harvard Graduate School of Education
**Helen Haste*, Harvard Graduate School of Education
Robert Selman, Harvard Graduate School of Education
Biao Sang, East China Normal University

Moderated mediation approach to assess the impact of identity strength on intergroup trust in post conflict society.

**Ahmet Coymak*, Queen's University Belfast
Evanthia Lyons, Queen's University Belfast
Mirona Gheorghiu, Queen's University Belfast
Ulrike Niens, Queen's University Belfast

National Identity, European Identity, and Attitudes Toward Immigrants Among Adolescents in 24 European Nations.

**Julia Van Alst*, Harvard Graduate School of Education

Self development and paternalistic expectations.

**Romina Paola Bershadsky*, University of Buenos Aires Argentina

FRIDAY, JULY 6 10:45 AM-12:15 PM

F2.1 1G THEME Political Action: from Strikes to Protest Participation

Room: Sauganash East

Section: Thematic session: Identity Politics and Politicized Identities

Willingness to participate in a strike: the role of a worker's social network in worker mobilization.

**Marieke Born*, Radboud University Nijmegen
Agnes Akkerman, Radboud University Nijmegen
Rene Torenvlied, Leiden University

The Evolution of Collective Action in Developing Neighborhoods.

**Jacquelin van Stekelenburg*, VU University

Igor Petrovic, VU University

Wim Pouw, VU University

Natasha Limburg, VU University

Naomi Nederlof, VU University

Political affect and familial identities in Argentina's activism.

**Diego Benegas Loyo*, Universidad Popular Madres de Plaza de Mayo

Explaining how context influences the motivational dynamics of protest participation.

Cristina Gómez Román, Universidad de Santiago de Compostela

Jose Manuel Sabucedo, Universidad de Santiago de Compostela

Monica Alzate, Universidade de Santiago de Compostela.

Mar Durán, Universidad de Santiago de Compostela

**Xiana Vilas*, USC

Chair: *Julia Becker*, University of Marburg

F2.2 2I Psychological and Political Consequences of Terrorism

Room: Mansion House

Section: Political conflict, violence, and crisis

Distress, threat, and support for reconciliation policies: Israeli-Palestinian and Northern Ireland conflicts.

**Daphna Canetti*, University of Haifa

Carmit Rapaport, Technion- Israel Institute of Technology

Orla Muldoon, University of Limerick

Stevan Hobfoll, Rush University Medical Center

The Big Cause Effect: Perspective Taking and Consequence Size Predict Belief in Conspiracy Theories.

**Jan Willem van Prooijen*, Dept. Social and Organizational Psychology, VU University Amsterdam

Eric van Dijk, Leiden University

The Role of Revenge, Denial and Terrorism Distress in Restoring Just World Beliefs.

**Neil Ferguson*, Liverpool Hope University

Shanmukh V. Kamble, Karnatak University

Chair: *Daphna Canetti*, University of Haifa

F2.3 2B Complex Perspectives on Victimhood

Room: Steamboat

Section: Political conflict, violence, and crisis

Perceived Outgroup Sentience and Notions of Justice in Intergroup Conflict: An Investigation from Victim and Perpetrator Perspective.

**Bernhard Leidner*, University of Massachusetts Amherst

Emanuele Castano, New School for Social Research

Jeremy Ginges, New School for Social Research

The Joys and Perils of Victimhood.

**Patricia Natally Slawuta*, New School for Social Research, New York City

Magdalena Bobowik, University of the Basque Country

Noa Schori-Eyal, University of Maryland

Yecheil Klar, Tel Aviv University

Dario Paez, University of the Basque Country

The “aftermath” of terrorism in the Basque Country: Psychosocial impact of the salience of the historical past of collective violence versus the impact of the apologies (a study revised).

**Magdalena Bobowik*, University of the Basque Country

Patricia Natally Slawuta, New School for Social Research, New York City

Dario Paez, University of the Basque Country

Nekane Basabe, University of the Basque Country

Victim group responses to perpetrator's expression of guilt and shame.

**Sabina Cehajic-Clancy*, Sarajevo School of Science and Technology

Rupert Brown, University of Sussex

Chair: *Patricia Natally Slawuta*, New School for Social Research, New York City

Discussant: *Eva G. T. Green*, University of Lausanne

F2.4 3J Group Identity and Prejudice

Room: Shakespeare

Section: Intergroup relations

The Relationship of Blind and Constructive Patriotism, National Identification and National Identity Dimensions with Attitudes towards Kurds in Turkey.

**Banu Cingoz-Ulu*, Middle East Technical University

Nazan Avci, Middle East Technical University

Religious Identification and Interreligious Contacts: A Study of Muslims and Christians in Indonesia and Philippines.

**Agnieszka Kanas*, Radboud University Nijmegen

Peer Scheepers, Radboud University Nijmegen, department of social science research methods

Carl Sterkens, Radboud University Nijmegen

Identity, Threat, and Anti-Hispanic Immigration Attitudes.

**Todd K. Hartman*, Appalachian State University

Joshua Harris, Appalachian State University

“May the best man win” – Actual and perceived ethnic competition as predictors of perceived ethnic threat and discrimination against immigrants.

**Julia Gundlach*, University of Bielefeld

Andreas Zick, University of Bielefeld

Discussant: *Todd K Hartman*, Appalachian State University

F2.5 4E The Political Psychology of the American Presidency

Room: Western Stage

Section: Leadership and political personality

Personality and Presidential Decision Making: Comparing the Personality Profiles of Barack Obama and Franklin D. Roosevelt.

**Andrew Obritsch*, Eastern Illinois Univ. & St. John's Univ. (MN)

**Aubrey Immelman*, St. John's University (MN)

Reviewing the Vice Presidency of George H.W. Bush.

**Anastasia Kucharski*, Harvard University

F2.6 5I Dynasties and Dynamics: Factors Affecting Democratic Attitudes

Room: Merchants

Section: Electoral behavior and public opinion

Explaining the Educational Effect on Democratic Attitudes: Cognitive Development, Class Self-Interest or Socialization to the Official Culture?

**Lenka Drazanova*, Humboldt Universitat zu Berlin

The Difference Similarity Makes: How Descriptive Representation leads to Policy Representation.

**Amir Fairdosi*, University of Chicago

The Dynamic Study of Congressional Party Voting and Constituent Support.

**Emily K. Lynch*, The Ohio State University

Political Dynasties and the 2010 Belgian general election.

**Brenda Van Coppenolle*, LSE

Chair: *Alexandra Bass*, University of Chicago

Discussant: *Alexander George Theodoridis*, University of California, Berkeley

F2.7 7F Narratives, Trauma and Reconciliation

Room: Lake House

Section: Political culture, identity, and language

Narrative and Reconciliation: Towards a model of "progressive narrative transformation."

**Rauf Garagozov*, Center for Strategic Studies

Feeling Ontologically (In)Secure: States, Traumas and the Securitization of Subjectivity.

**Catarina Kinnvall*, Lund University

Metaphorical Stereotyping for Conflict Resolution: redrawing identity through language.

**Dmitry Chernobrov*, St. Andrews University

Chair: *Cristian Tileaga*, Loughborough University

Discussant: *Cristian Tileaga*, Loughborough University

F2.8 8D The Psychology of Political Behavior

Room: American

Section: Political behavior and electoral decision making

It's Not All About Resources: Explaining the Instability of Individual-Level Political Participation Over Time.

**Joanne Miller*, University of Minnesota

**Kyle Saunders*, Colorado State University, Department of Political Science

Political Knowledge, Representation, and the Mass Media.

**Joseph Wachtel*, George Washington University

**Jason Barabas*, Florida State University

Strategic voting in PR-systems: measurement and findings from the 2010 Swedish general election.

**Annika Maria Fredén*, Department of Political Science, Lund University

Exploring the Connections between Health Care Coverage and Political Behavior.

**Carlos Paez*, Florida State University

Jason Barabas, Florida State University

Chair: *William D. Flanders IV*, Florida State University

Discussant: *Beth Miller*, University of Missouri-Kansas City

F2.9 9G The Determinants of Political Participation and Cooperation

Room: Bulls Head

Section: Civic engagement and civic development

"The Daily Grind" and Its Impact on Political Participation.

**Patrick Lown*, Stony Brook University

Benjamin Jordan Newman, Stony Brook University

Josh Johnson, Stony Brook University

Political participation: proselytization, pacific and aggressive participation. Structure and determinants.

**Gisela Isabel Delfino*, University of Buenos Aires

Elena Mercedes Zubieta, Buenos Aires University

Marcela Muratori, Universidad de Buenos Aires

Social inequality and changes in students' attitudes towards political participation.

**Juan Carlos Castillo*, P. Universidad Católica de Chile

Cristián Cox, Pontificia Universidad Católica de Chile

Daniel Miranda, Pontificia Universidad Católica de Chile

Martín Bascope, Pontificia Universidad Católica de Chile

Jorge Escobar, Pontificia Universidad Católica de Chile

■ CONFERENCE DETAILS

FRIDAY JULY 6 • 10:45–12:15, 12:30–1:30, 1:45–3:15

Getting Beyond In-fighting; Resolving Conflict between Conservative and Liberal Political Worldviews to Address World Problems

**William McConochie*, Political Psychology Research, Inc.

Discussant: *Nicholas Valentino*, University of Michigan

FRIDAY, JULY 6 12:30 PM-1:30 PM

F3.1 Keynote Address by Katherine Reynolds

Room: Sauganash East

Section: ISPP 35th Annual Scientific Meeting

F3.2 Political Psychology Editorial Board Luncheon

Room: Wolf Point Prefunction

Section: ISPP 35th Annual Scientific Meeting

FRIDAY, JULY 6 1:45 PM-3:15 PM

F4.1 1A THEME Dynamics and Consequences of Politicized Identities

Room: Sauganash East

Section: Thematic session: Identity Politics and Politicized Identities

Cosmopolitan Identities of German Anti-Nuclear Activists

**Miriam Israela Laufer Katz*, York University

Politicized Collective Identity and Collective Angst Among Tamils in the Diaspora: Fostering Support for Peaceful Protest and Violence to Achieve Group Goals

**Michael Jeremy Adam Wohl*, Carleton University

Michael King, McGill University

Born in the USA: How Immigrant Generation Shapes Meritocracy and Its Relation to Ethnic Identity and Collective Action

**Shaun Wiley*, The College of New Jersey

Kay Deaux, CUNY Graduate Center and New York University

Carolin Hagelskamp, Public Agenda

Chair: *Gerhard Reese*, Friedrich Schiller University Jena, Germany

Discussant: *Bert Kländermans*, Sociology, VU, University of Amsterdam

F4.2 2G The Double Edges of Identity and Religion

Room: Steamboat

Section: Political conflict, violence, and crisis

Radicalization among Muslim immigrants in Western Europe: A Spanish case study

**Noa Schori-Eyal*, University of Maryland

Arie Kruglanski, University of Maryland

Manuel Moyano, University of Granada

Jocelyn Belanger, University of Maryland

Humberto Trujillo, University of Granada

Religion, cooperation and human conflict

**Jeremy Ginges*, New School for Social Research

“One nation, one god, one state”: The relationship between religious practice and national identity in Croatia and Serbia

**Sandra Penic*, University of Lausanne

Dario Spini, University of Lausanne

Margareta Jelic, University of Zagreb

Chair: *Jeremy Ginges*, New School for Social Research

Discussant: *Dunya van Troost*, VU University

F4.3 3C Personality, Ideology, and Prejudice

Room: American

Section: Intergroup relations

An extended meta-analysis on the relation between personality characteristics and prejudice

**Jutta Proch*, Friedrich-Schiller-University of Jena, Germany

Kristin Mitte, Friedrich-Schiller-University of Jena, Germany

Nicole Kämpfe, Friedrich-Schiller-University of Jena, Germany

They Really Know How Prejudiced You Are – or Are Not!

**Sam McFarland*, Western Kentucky University

Does endorsement of hierarchy make you evil? SDO and psychopathy

**Marc Stewart Wilson*, Psychology, Victoria University of Wellington

Chris G. Sibley, University of Auckland

Personality and Political Orientation: Meta-Analysis and test of a Threat-Constraint Model

**Chris G. Sibley*, University of Auckland

Danny Osborne, University of Auckland

John Duckitt, University of Auckland

Chair: *Chris G. Sibley*, University of Auckland

F4.4 3M Dynamic Processes in Intergroup Relations

Room: Merchants

Section: Intergroup relations

Effects of perceived stability of social hierarchy and level of system justification on seeking dependency-oriented help by the low status group.

**Lily Chernyak-Hai*, Netanya Academic College, Israel

**Samer Halabi*, The Academic College of Tel-Aviv-Yaffo

Arie Nadler, Tel-Aviv University

(De) Constructing Gender Identities: System Justification and Traditional Gender Roles.

**Natasza Natalia Marrouch*, NYU

John Jost, New York University

Consequences of Intergroup Emotions: How Emotions Felt Toward One Out-Group Influence Opinions of Other Groups

**Beth Estes*, Vanderbilt University

The Role of Disgust in Dehumanizing Propaganda

**Ceyhan Sunsay*, Indiana University Northwest

Chair: *Beth Estes*, Vanderbilt University

F4.5 4G Narcissism and Politics: The "Specialness" of the Narcissist in Power

Room: Mansion House

Section: Leadership and political personality

Arnold Schwarzenegger: Phallic Narcissist in Power

**Kristen Moody*, The George Washington University

An Exceptional Exception: The Rise and Fall of Italy's Silvio Berlusconi

**Ruthie Pertsis*, The George Washington University

"For Better or for Worse": Wives as Self-Objects

**Jerrold M. Post*, The George Washington University

Chair: *Jerrold M. Post*, The George Washington University

F4.6 7K Political Identities: Prejudices, Patriotism and Conflict

Room: Western Stage

Section: Political culture, identity, and language

Political Identities: From a Vertical to a Horizontal Language.

**Maryse Touboul*, School of Aliveness and Adulthood, George Washington University

Prejudice at the Nexus of Race and Patriotism: Questioning the Patriotism of African Americans

**Laura D. Van Berkel*, University of Kansas

Chris Goode, University of Kansas

Ludwin Molina, University of Kansas

Modeling the Relationship Between Intergroup, Interpersonal and Situational Factors that Contribute to Productive Political Discourse

**Elliot Hansen Weiner*, Metropolitan State University

Chair: *Robert T. Schatz*, Metropolitan State College of Denver

Discussant: *Robert T. Schatz*, Metropolitan State College of Denver

F4.7 8H Political Psychology Worldwide

Room: Shakespeare

Section: Political behavior and electoral decision making

Anger, Anxiety and Voting Behavior in Referendums: The Case of the 2010 Bavarian Smoking Restriction Referendum

**Alexander Glantz*, University of Bamberg, Germany

Harald Schoen, University of Bamberg, Germany

Deconstructing Political Will: The Approach of a Human Rights NGO

**Faraaz Mahomed*, Monterey Institute of International Studies

Mapping the political behaviour of Turkish citizens under the lens of the affective, cognitive and motivational determinants

**Stavroula Chrona*, University of Surrey, United Kingdom

**Tereza Capelos*, University of Surrey

Chair: *Eyal Lewin*, Ariel University Center

Discussant: *Eyal Lewin*, Ariel University Center

F4.8 11A Advances in political cognition

Room: Lake House

Section: New theoretical and methodological developments

Automated Integrative Complexity

**Lucian Gideon Conway*, The University of Montana

Kathrene R. Conway, The University of Montana

Laura Janelle Gornick, University of Montana

Shannon Christine Houck, The University of Montana

Virtue vs. Violence: Comparing Integrative Complexity of Qur'anic Excerpts

Peter Suedfeld, University of British Columbia

**Lianne McLellan*, Defence R&D Canada

James Wesley Moore, Defence Research & Development Canada

The Social Cognition of Anti-Semitism

**Steven K. Baum*, Journal For The Study of Anti-Semitism

**Florette Cohen*, City University New York (USA)

The Meaning of Don't Know

**Delia Dumitrescu*, Universite de Montreal

Chair: *Robert Foels*, University of Connecticut

Discussant: *Robert Foels*, University of Connecticut

F4.9 12B Justice in the World: Antecedents and Consequences of Perceiving, Expressing, and Enacting Justice

Room: Bulls Head

Section: Social inequality and social change

Expressing Belief in a Personal Just World and Deserving a Promotion

**Hélder Alves*, ISCTE-IUL

Isabel Correia, ISCTE- Lisbon University Institute

Cícero Pereira, Instituto de Ciências Sociais da Universidade de Lisboa

Robbie Sutton, University of Kent, UK

Experiences of Discrimination and Regulation Strategies

**Veronique Eicher*, NCCR LIVES, University of Lausanne

Mouna Bakouri, NCCR LIVES, University of Lausanne

Marlène Carvalhosa Barbosa, NCCR LIVES, University of Lausanne

The Power of Fair Procedures: The Effect of Fair Treatment on Subordinates' Perceptions of Power and Hierarchy

**Avital Mentovich*, Ph.D. student for Social Psychology at NYU

Peter Beattie, New York University

Tom Tyler, New York University

Frames of Reference and Justice Restoring Mechanisms

**Purnima Singh*, Department of HUSS, IIT Delhi, Delhi-110016, India

Chair: *Thalia Magioglou*, Maison des sciences de l'Homme, Paris

Discussant: *Jaime Lynn Napier*, Yale University

FRIDAY, JULY 6 3:30 PM-5:00 PM

F5.1 1H THEME Political Identities in Current Movements: Egypt and Iran

Room: Sauganash East

Section: Thematic session: Identity Politics and Politicized Identities

Identity in Egypt's Nuclear Future.

**Maria Rost Rublee*, University of Auckland

Framing Identity in Iran.

**Andrea Grove*, CSU Channel Islands

Discussant: *Steven K. Baum*, Journal for The Study of Anti-Semitism

F5.2 2E Strategic Uses of Emotion and Interpretations in Conflict Resolution

Room: Bulls Head

Section: Political conflict, violence, and crisis

Can Emotion Regulation Change Political Attitudes in Intractable Conflict? From the Laboratory to the Field

Eran Halperin, IDC Herzliya

**Roni Porat*, IDC - Lauder School of Government

**Maya Tamir*, Hebrew University

James Gross, Department of Psychology Stanford University

Promoting Peace by Changing Beliefs about Group Malleability: The Mediating Role of Intergroup Emotions

**Eran Halperin*, IDC Herzliya

Smadar Cohen-Chen, Interdisciplinary Center Herzeliya

Richard Crisp, University of Kent

James Gross, Department of Psychology Stanford University

Carol Dweck, Department of Psychology Stanford University

The impact of collective guilt on conflict resolution. The example of Israeli-Palestinian conflict

**Inna Ferdmane*, Latvian University

Subjective Frames of the Turkish-Kurdish Conflict in Turkey.

**Ozden Melis Ulug*, Queen's University Belfast

Christopher Cohrs, Queen's University Belfast

Chair: *Eran Halperin*, IDC Herzliya

Discussant: *Katie Brown*, The University of Michigan

F5.3 2N Staying Alive: The Political Psychology of Survival and Flourishing in a complex and hostile world

Room: Western Stage

Section: Political conflict, violence, and crisis

"Politics and Ethics in Conceptualizing Infectious Diseases with Psychological Effects: The Case of Lyme Disease"

**Cheryl Koopman*, Stanford University

"Polygyny and Violence Against Women".

**Rose McDermott*, UCSB

A Darkling Plain: Humanity during War

**Kristen Renwick Monroe*, University of California, Irvine

Chair: *Monica C. Schneider*, Miami University of Ohio

Discussant: *James Druckman*, Northwestern University

F5.4 3P Individual and Institutional Aspects of Discrimination

Room: Lake House

Section: Intergroup relations

'Affirmative discrimination': Constructions of discrimination as inequality of process versus outcomes

**Brianne Hastie*, University of South Australia

David Rimmington, University of South Australia

Validating Reaction Time Based Racial Attitude Measures in African American Samples

**Thomas Craemer*, University of Connecticut, Department of Public Policy

**Byron D'Andrea Orey*, Department of Political Science at Jackson State University

Race and the Contingent Nature of Beliefs about the Death Penalty

**Ashley Jardina*, University of Michigan

**Allison Dale-Riddle*, University of Michigan

Chair: *Thomas Craemer*, University of Connecticut, Department of Public Policy

Discussant: *Carly Jacobs*, University of Nebraska-Lincoln

F5.5 12G Poster Session: Social Inequality and Social Change AND 3A Poster Session: Intergroup Relations

Room: Sauganash Foyer

Examining the Relationship between Socioeconomic Status and Academic Achievement among High and Low Performers as Reflected in Dropout Rates

**Calisha Brooks*, Tennessee State University

Positive Marginality and Transnational Activist Identity Development

**Anjali N. Dutt*, University of California, Santa Cruz

Shelly Grabe, University of California, Santa Cruz

Leifa Mayer, University of California, Santa Cruz

Reminders of Community Connection as a Useful Strategy for Shifting Public Opinion on Issues of Intergroup Inequality

**Gregory Dale Boese*, University of Manitoba

Danielle Gaucher, University of Winnipeg

Katherine Starzyk, University of Manitoba

Katelin Neufeld, University of Manitoba

The Efficacy of Social Networks within Mixed-Income Communities: Spatially Mixed, but Socially Isolated?

**Charles John Barlow*, Irving B. Harris Graduate School of Public Policy Studies, The University of Chicago

The Imaginary Localization of Multiculturalism as Normative Basis in the Mind of the Public

**Babette Gekeler*, UCL

The effect of threat, fear and prejudice on solidarity-based collective action

**Fabio Fasoli*, CIT-EC, Center of Excellence Cognitive Interaction Technology, University of Bielefeld, Germany

Lee Shepherd, University of Stirling

Andrea Pereira, University of Geneva

Adela Fofiu, Babes-Bolyai University

Changing the channel: Promoting openness to new information in the context of political conflict

**Justine Elizabeth Calcagno*, The Graduate Center, City University of New York
Demis Errol Glasford, John Jay College & Graduate Center, City University of New York

Relations Between Group-Based Dominance and Opposition to Equality in Low Status Groups

**Nevin Solak*, Middle East Technical University & New York University
John Jost, New York University

Extending Social Dominance to the framework of Interpersonal Power/Interaction Model (IPIM)

**Antonio Aiello*, University of Pisa

Impact of Masculine/Feminine Facial Cues on Punishment for Discriminatory Rhetoric

**Brett Kosterman*, University of Amsterdam

F5.6 4C Dynamics of Leadership, Personality, and Mass Perceptions

Room: Steamboat

Section: Leadership and political personality

Crisis, Disaffection, and Charismatic Populism: Leader Effects in a Local Election

**Guillem Rico*, Universitat Autònoma de Barcelona
Joan Font, CSIC (National Council for Scientific Research)

Observational assessment of verbal and non-verbal interpersonal interaction in the 2008 U.S. vice presidential debate

**Tara A. Latta*, The Family Institute at Northwestern University
**Vickie Bhatia*, Stony Brook University
Lynne M. Knobloch-Fedders, The Family Institute at Northwestern University

Politicians' uniquely simple personalities: Cross-cultural replication and explanation of the political simplification effect

**Lukas Otto*, University of Koblenz-Landau

Winning Faces Vary By Ideology: Evolutionary Psychology and the Role of Candidate Facial Traits in Democratic Elections

**Lasse Laustsen*, Department of Political Science, Aarhus University
Michael Bang Petersen, University of Aarhus

Chair: *Guillem Rico*, Universitat Autònoma de Barcelona

Discussant: *Aubrey Immelman*, St. John's University (MN)

F5.7 5C New Directions in the Study of Voting

Room: Shakespeare

Section: Electoral behavior and public opinion

Do leaders and parties assessments dampen political trust? Order effects in political trust reports in Great Britain

**Diana Elena Burlacu*, Central European University
**Tim Hanson*, TNS-BMRB, London

Do voters choose the lesser evil? How much do parties lose in highly corrupted countries?

**Diana Elena Burlacu*, Central European University

Overcoming Memory Loss: The Effect of Reinforcement on Memory for Campaign Information

**Beth Miller*, University of Missouri-Kansas City

Why do people vote for unsuccessful parties? A prospect-theory response

**Delia Dumitrescu*, Université de Montréal

Chair: *Ben Woodson*, Stony Brook University - Political Science

Discussant: *Bas Willem van Doorn*, College of Wooster

F5.8 6D Political deliberation and citizens' attitudes

Room: American

Section: Political communication

What shall we think?! Group polarization in deliberations over an unfamiliar issue

**Nicole Kronberger*, Johannes Kepler University Linz

Peter Holtz, Johannes Kepler University, Linz, Austria

Wolfgang Wagner, Johannes Kepler University, Linz, Austria

The structure of non-Muslim Australians' beliefs about Muslim immigrants and immigration to Australia before and after deliberative engagement

**D. Conor Seyle*, Issues Deliberation Australia/America

Toula Skiadas, Issues Deliberation Australia/America

Pamela Ryan, Issues Deliberation Australia/America

Motives for Active Participation in Political Blogs – A Qualitative and Quantitative Analysis of 11 German Blogs

**Kathrin Greuling*, University of Koblenz-Landau, Institute for Management

Thomas Kilian, University of Koblenz-Landau, Institute for Management

The Flexible Deliberation Model of Political Tolerance

**Erika D Price*, Loyola University Chicago

Chair: *Todd K Hartman*, Appalachian State University

Discussant: *Charles Daniel Myers*, University of Michigan

F5.9 7E Social, Civic and Community Identity

Room: Mansion House

Section: Political culture, identity, and language

Colombia's Raizal People: the Complexity of Created Identity

**Kristina Emma Thalhammer*, St. Olaf College

**Kristell Caballero-Saucedo*, St. Olaf College

Representations and social belonging: the formation of Community and Social Identity

**Gordon Sammut*, Department of Psychology, University of Malta

State image as a factor of civic identity

**Maria Volynskaia*, St. Petersburg State University

How global processes influence identity development of Russian citizens

**Natalia Sveshnikova*, St. Petersburg State University

Chair: *Natalia Kovalyova*, UNT Dallas

Discussant: *Natalia Kovalyova*, UNT Dallas

F5.10 12E Economically Vulnerable Groups in a Marketized World

Room: Merchants

Section: Social inequality and social change

Poor Consumers: The Industrial Construction of Class

**Lori Young*, University of Pennsylvania

The Financial Crisis and Government Responses to Wage Setting for Vulnerable Workers in Ireland

**Michelle O'Sullivan*, University of Limerick

**Juliet McMahon*, University of Limerick

The Explanatory Power of Institutional Anomie Theory for Understanding Outgroup Devaluations in Neo Liberal (Marketized) Societies

**Andreas Hoevermann*, University of Bielefeld, Germany

**Eva Maria Groß*, IKG, Universität Bielefeld

**Andreas Zick*, University of Bielefeld

Chair: *Jason Lavelle Griffin*, Washington State University

Discussant: *Jason Lavelle Griffin*, Washington State University

FRIDAY, JULY 6 5:00 PM-6:00 PM

F6.1 Junior Scholar's Social Hour

Room: Bar area

Section: ISPP 35th Annual Scientific Meeting

FRIDAY, JULY 6 6:00 PM-9:00 PM

F7.1 Opening Reception

Room: Petterino's

Section: ISPP 35th Annual Scientific Meeting

SATURDAY, JULY 7 9:00 AM-10:30 AM

S1.1 Roundtable of Editors at Political Psychology

Room: Lake House

Section: ISPP 35th Annual Scientific Meeting

Organizer

**Alex Mintz*, Lauder School of Government, IDC

S1.2 1C THEME Forging Identities in Different National Contexts

Room: Sauganash East

Section: Thematic session: Identity Politics and Politicized Identities

Forty Shades of Green: political identities and division within the national group

**Orla Muldoon*, University of Limerick

Anca Minescu, University of Limerick

**Aisling O'Donnell*, University of Limerick

**Stephen Reicher*, St. Andrews University

The Prototypical American: The Role of National Symbols in American Ethnocentrism

**Richard Cho*, Stony Brook University

**Milton Lodge*, Stony Brook University

**Ben Woodson*, Stony Brook University - Political Science

From Social to Political Identity: Latino Identity, Issue Attitudes, and Partisanship

**Angel Saavedra Cisneros*, Clarkson University

Uncertainty-Identification Processes in the Dual Identification Context

**Jiin Jung*, Claremont Graduate University

Michael A Hogg, Claremont Graduate University

Hoon-Seok Choi, Sung Kyun Kwan University

Chair: *Ozden Melis Ulug*, Queen's University Belfast

Discussant: *Rezarta Bilali*, University of Massachusetts Boston

S1.3 2A Coping with the Effects of Violence

Room: Steamboat

Section: Political conflict, violence, and crisis

Conflict: Psychological perspectives on reconstruction and recovery

**Eve Binks*, Liverpool Hope University

The influence of chronic terrorism and war-related threat on immunity and inflammation

**Daphna Canetti*, University of Haifa

Eric Russ, Rush University Medical Center

Judith Luborsky, Rush Medical University Center

Stevan Hobfoll, Rush University Medical Center

Vengeance for the 9/11 attacks feeds continued support for vengeful acts

**Daniel Wisneski*, University of Illinois at Chicago

Linda J. Skitka, University of Illinois at Chicago

Peter Liberman, Queens College

Chair: *Eve Binks*, Liverpool Hope University

S1.4 3H Advances in Intergroup Contact Research

Room: American

Section: Intergroup relations

Testing The Contact Hypothesis Among Fulbright Pakistani Students In the U.S

**Gulnaz Anjum*, The New School

Silvia Fernandez, The New School

**Emanuele Castano*, New School for Social Research

Mudassar Aziz, Quaid-iAzam University

Racial integration study: A social intervention at the University of Cape Town

**Caroline Kim*, University of Cape Town

Who Benefits from Imagined Intergroup Contact? Contact Experiences Moderate the Effects of Imagined Contact on Intergroup Bias

**Dieta Kuchenbrandt*, University of Bielefeld

Friederike Eyssel, University of Bielefeld

Kristina Spuling, Bielefeld University

Chair: *Dieta Kuchenbrandt*, University of Bielefeld

Discussant: *Oliver Christ*, University of Marburg

S1.5 3N Morality, Religiosity, Values, and Ideology

Room: Mansion House

Section: Intergroup relations

Reexamining the Moral Foundations of Liberals and Conservatives: A Coalitional/Evolutionary Psychology Perspective

**Jeff Scott Sinn*, Winthrop University

Matt W. Hayes, Winthrop University

Religiosity, System Justification and Opposition to Same-Sex Marriage

**Jojanneke van der Toorn*, Yale University

John Jost, New York University

Dominic Packer, Lehigh University

Jay Van Bavel, New York University

Social dominance orientation and values. A comparison between civilian and military students
Marcela Muratori, Universidad de Buenos Aires
**Gisela Isabel Delfino*, University of Buenos Aires
Elena Mercedes Zubieta, Buenos Aires University

Who is to Blame? The Impact of SDO and Agreement with Cameron's Speech on Perceived Causes and Ethnocentrism during the English Riots of 2011
**Nicole Fasel*, University of Lausanne
Oriane Sarrasin, University of Lausanne
Eva G. T. Green, University of Lausanne
Eric Mayor, University of Neuchâtel

Chair: *Oriane Sarrasin*, University of Lausanne

Discussant: *Christopher Weber*, Louisiana State University

S1.6 6I Scandal and negativity in political communication: Rhetoric and effects

Room: Bulls Head

Section: Political communication

Don't trust the politician! Information processing under (dis)trust conditions
**Lungile Senanelo Nyathi*, University of Bielefeld

Negativity in Televised Debates: Assessing the Impact of Attacking Statements
**Jürgen Maier*, U of Koblenz-Landau

Emotion Management in Political Scandal: Evoking Forgiveness
**Monika Verbalyte*, FU Berlin

Managing Blame in the MPs' Expenses Scandal: a Study of Political Accounts
**Tereza Capelos*, University of Surrey

Discussant: *Michaela Maier*, University of Koblenz-Landau, Communication Psychology, Germany

S1.7 8G Cognition, Cues, and Certainty

Room: Shakespeare

Section: Political behavior and electoral decision making

The uncertainty paradox: Feelings of threat moderate the effect of uncertainty on political tolerance
**Ingrid Johnsen Haas*, The Ohio State University
William Cunningham, Ohio State University

Cognitive Politicization and Political Action: Pathways of Political Interest and Political Competence to Political Action
**Frank Reichert*, Christian-Albrechts-Universität zu Kiel, Institut für Psychologie

Political Cynicism Reconsidered: An Exploratory Study on the Conceptualization of Different Types of



Cynicism.

**Sanne Afra Maria Rijkhoff*, Washington State University

The same Cue, but different Effects: Individual Differences in Cognitive Abilities and Ideology

**Bert Bakker*, Ph.D. scholar

Chair: *Ingrid Johnsen Haas*, The Ohio State University

Discussants: Nathanael Gratiyas Sumaktoyo, Loyola University Chicago

Nathanael Sumaktoyo, Department of Psychology, University of Indonesia

S1.8 8F Experiments and Experimental Approaches

Room: Western Stage

Section: Political behavior and electoral decision making

Analyzing Gender: How Sample Characteristics Affect Experimental Outcomes

**Yanna Krupnikov*, Indiana University

Nichole M. Bauer, Indiana University

How Moral Foundations Shape Character Trait Attributions

**Scott Clifford*, Florida State University

Epistemic Threat and Belief Structure

**Joseph A. Vitriol*, University of Minnesota, Twin-Cities

Michal Reifen Tagar, Department of Psychology, University of Minnesota, USA

Christopher Federico, Department of Psychology, University of Minnesota

Using Electroencephalography to Measure Inhibition in Political Ideologues

**Dane Wendell*, Loyola University Chicago

**Richard E. Matland*, Loyola University Chicago

**Robert G. Morrison*, Loyola University Chicago

Chair: *Jennifer Jerit*, Florida State University

Discussants: *Thomas J. Leeper*, Northwestern University

G. Scott Morgan, Drew University

S1.9 13B Acculturation, marginalisation and wellbeing

Room: Merchants

Section: Migration and acculturation

Ex-convict women in Turkey; Marginalization and Social Exclusion

**Munise Emek*, Istanbul University

**Nihal Birtek*, Istanbul University

My Days in Solitary Confinement: A Cross-Cultural Analysis of Care-giving Resources and Policies

**Frauke Schnell*, West Chester University

**Jasmin Tahmaseb*, West Chester University

**Jacqueline Sullivan*, West Chester University

The feasibility and necessity of studying acculturation of migrant children in China
**Yunjiao Erica Gao*, Department of Applied social studies, City University of Hong Kong

Chair: *Diego Benegas Loyo*, Universidad Popular Madres de Plaza de Mayo

Discussant: *Thalia Magioglou*, Maison des sciences de l'Homme, Paris

SATURDAY, JULY 7 10:45 AM-12:15 PM

S2.1 JSC Career Development Roundtable: Strategies for successful and effective collaborations

Room: Steamboat

Section: ISPP 35th Annual Scientific Meeting

Presenters: **Lene Aaroe*, Department of Political Science, University of Aarhus

**Delia Dumitrescu*, Universite de Montreal

**Rose McDermott*, UCSB

**Jennifer Jerit*, Florida State University

**Eran Halperin*, IDC Herzliya

S2.2 1J THEME Political Motherhood

Room: Sauganash East

Section: Thematic session: Identity Politics and Politicized Identities

Politicized parent identity and its relation to gender identity and collective action

**Carrie Langner*, California Polytechnic State University

Women's political double bind: Toward a psychological theory of maternal politics

**Grace Deason*, University of Wisconsin - La Crosse

Voter and candidate identity: The role of motherhood in political campaigns

**Jill Greenlee*, Brandeis University

S2.3 2D New Directions in Terrorism Research

Room: Lake House

Section: Political conflict, violence, and crisis

Terrorist Behavior and Investigative Decision Making

**Margaret Ann Wilson*, University of Liverpool

Co-operation and competition in terrorist groups

**Martha Crenshaw*, Stanford University

Five things I have learned about terrorism since 9/11

**Clark McCauley*, Bryn Mawr College

Reactions to terrorism

**Leonie Huddy*, Stony Brook University



The political consequences of terrorism

**Stanley Feldman*, Department of Political Science, Stony Brook University (USA)

Chair: *Margaret Ann Wilson*, University of Liverpool

S2.4 13C Poster Session: Acculturation, identity and immigration AND 20 Poster Session: Pathways to Reconciliation

Room: Sauganash Foyer

Acculturation strategies and temporal perspective among international students

**Mariya Chayinska*, University of Milano – Bicocca

Silvia Mari, University of Milano-Bicocca

Identity and Political Attitudes of Cuban Immigrants.

**Rebecca Kala Rosen*, University of Chicago

Kimberly Rios, University of Chicago

Recategorization as peacebuilding tool. Experiences from Rwanda and Zanzibar

**Sigrun Marie Moss*, The Norwegian University of Science and Technology, Trondheim, Norway

The Buffering Role of Social Identity in Contexts of Political Conflict: Changes in Adolescence

**Christine E. Merrilees*, University of Notre Dame

Laura K. Taylor, University of Notre Dame

Ed Cairns, University of Ulster

Marcie Goeke-Morey, Catholic University

Peter Shirlow, Queen's University Belfast

E. Mark Cummings, University of Notre Dame

Protracted Intergroup Conflict and Adolescent Prosocial Behaviors

**Laura K. Taylor*, University of Notre Dame

Christine E. Merrilees, University of Notre Dame

Ed Cairns, University of Ulster

Marcie Goeke-Morey, Catholic University

Peter Shirlow, Queen's University Belfast

E. Mark Cummings, University of Notre Dame

S2.5 3K Ideological Dynamics under Threat and Competition

Room: American

Section: Intergroup relations

On the interplay between dispositions and situations: priming dangerous and competitive worldviews activates the effects of RWA and SDO on punitive attitudes

**Monica M. Gerber*, London School of Economics and Political Science

Right-Wing Authoritarianism and Social Dominance Orientation as Predictors of Political Tolerance

**Jarret T. Crawford*, Psychology Department, The College of New Jersey

Jane M. Pilanski, The College of New Jersey

We have seen the enemy: Social Dominance Orientation and Right Wing Authoritarianism under intergroup threat

**Kristin Henkel*, Central Connecticut State University

Felicia Pratto, University of Connecticut

Studies on the interaction between group identity and social dominance orientation

**Hector Carvacho*, Universität Bielefeld

Anne-Katrin Henseler, Universität Bielefeld

Andreas Zick, University of Bielefeld

Caroline Kocik, Universität Bielefeld

Chair: *Antonio Aiello*, University of Pisa

Discussant: *Frank Asbrock*, University of Marburg

S2.6 4F Multiple Psychological Bases of Elite Decision Making in Diverse Contexts

Room: Mansion House

Section: Leadership and political personality

Syndromes of Polythink: The Israeli Delegation at Camp David 2000

**Alex Mintz*, Lauder School of Government, IDC

Shaul Mishal, Tel Aviv University

**Nadav Morag*, Naval Postgraduate School

The Poliheuristic Theory and Issue Salience: An Experimental Design and Test

**Kai Oppermann*, University of Cologne

**Steven B. Redd*, University of Wisconsin-Milwaukee

Syria's War and Peace Decision Making

**Ori Barzel*, Lauder School of Government, Diplomacy & Strategy, IDC

**Maya Stockman*, Lauder School of Government, Diplomacy & Strategy, IDC

Chair: *Alex Mintz*, Lauder School of Government, IDC

Discussant: *C. Scott Bell*, Appalachian State University

S2.7 5K Personality and Emotion

Room: Shakespeare

Section: Electoral behavior and public opinion

Does Openness Always Matter? Political Sophistication Moderates the Relationship between Openness and Political Attitudes

**Danny Osborne*, University of Auckland

Chris G. Sibley, University of Auckland

Stability and Change in Personality Traits and Party Identification

**Bert Bakker*, Ph.D. scholar

David Hopmann, Assistant Professor



Mikael Persson, Göteborg University

Personality's contribution to understanding party choice

**Martina Zandonella*, SORA - Institute for Social Research and Analysis

Eva Zeglövits, University of Vienna, Department of Methods in the Social Sciences

Chair: *Melissa A. Koenig*, University of Minnesota

Discussant: *Kristen D. Deppe*, University of Nebraska-Lincoln

S2.8 6E Political knowledge, deliberation and engagement

Room: Bulls Head

Section: Political communication

Common and Uncommon Knowledge in Political Deliberation

**Charles Daniel Myers*, University of Michigan

False Learning: Humor, Irony, and Political Knowledge

**Katie Brown*, The University of Michigan

Diana Betz, University of Michigan

Scott Campbell, University of Michigan

Nojin Kwak, University of Michigan

Strong Attitudes and Biased Political Engagement

**Thomas J. Leeper*, Northwestern University

Voices of Reason: The Influence of Diverse Deliberation on Strong and Weak Partisans

**Samara Mani Klar*, Northwestern University

Chair: *Toby Bolsen*, Georgia State University

Discussant: *John Brehm*, University of Chicago

S2.9 8A Advances in the Study of Emotions and Politics

Room: Western Stage

Section: Political behavior and electoral decision making

Effects of Emotional Responses to Political Information on Social Sharing Behavior

**David Redlawsk*, Rutgers University

William Cohen, Carnegie Mellon University

Doug Pierce, Rutgers University

Ramnath Balasubramanian, Carnegie Mellon University

Tae Yano, Carnegie Mellon University

A Framework for the Study of Emotion, Valence Affect, and Politics

**Ben Woodson*, Stony Brook University - Political Science

Emotional Language in Politics

**Stephen Utych*, Vanderbilt University
Feeling Europe: The Impact of Affect on EU-Related Attitudes.
**Monika Verbalyte*, FU Berlin

Chair: *Scott Clifford*, Florida State University
Discussant: *Alexander George Theodoridis*, University of California, Berkeley

S2.10 9I Youth Leading the Way: Redefining Civic Engagement for a New Era

Room: Merchants

Section: Civic engagement and civic development

Redefining Civic Action

**Meira Levinson*, Harvard Graduate School of Education

'It's Not Just About Getting Them to Vote': A More Realistic Definition of Civic Engagement

**Helen Haste*, Harvard Graduate School of Education

Transitional Justice, Legacies of Authoritarianism, and a Failing Democracy: Civic Culture Among Guatemala's "Postwar" Generation

**Michelle J. Bellino*, Harvard Graduate School of Education

Deliberative Capacity in the Political and Civic Sphere

**Seraina Pedrini*, University of Zurich

Chair: *Meira Levinson*, Harvard Graduate School of Education

SATURDAY, JULY 7 12:30 PM-1:30 PM

S3.1 Keynote Address by Felicia Pratto

Room: Sauganash East

Section: ISPP 35th Annual Scientific Meeting

SATURDAY, JULY 7 1:45 PM-3:15 PM

S4.1 1E THEME Poster Session: Identity Politics and Politicized Identities AND 7I Poster Session: Minority Rights, Language Activism and Intergroup Perceptions

Room: Sauganash Foyer

Positive Portrayals of Feminist Men Increase Men's Solidarity with Feminists and Collective Action Intentions

**Shaun Wiley*, The College of New Jersey

Ruhi Srinivasan, The College of New Jersey

Elizabeth Finke, The College of New Jersey

Joseph Firmhaber, The College of New Jersey

Alyssa Shilinsky, The College of New Jersey

Predictors of Strength of Social Identity in Northern Ireland: The Role of Sectarian Conflict, Relative Deprivation, and Religiosity

**Marcie Goeke-Morey*, Catholic University of America

Ed Cairns, University of Ulster



Laura K. Taylor, University of Notre Dame
Christine E. Merrilees, University of Notre Dame
Peter Shirlow, Queen's University Belfast
E. Mark Cummings, University of Notre Dame

Precursors of Civic Engagement in a Diverse Community
**Oksana Malanchuk*, University of Michigan

The Effect of Social Power on Emotion Suppression
**Carrie Langner*, California Polytechnic State University

Fifth Column sentiments toward Muslims: Social Dominance Orientation and its legitimizing myths
**Paul Hindriks*, Utrecht University, ERCOMER
Maykel Verkuyten, Faculty of Social Sciences, University of Utrecht
Marcel Coenders, Utrecht University

Political Correctness and Language Activism Survey Instrument: Validation and Relationship to Daily Stress
**Erin Strauts*, Social Psychology, University of Connecticut
Hart Blanton, Social Psychology, University of Connecticut

Identity talk through photo elicitation: Examining issues of entitlement and accountability in participants' talk of photographic representations of Irishness
**Carmel Joyce*, University of Limerick
Clifford Stevenson, University of Limerick

S4.2 2F The Power of a Word: Social Psychological Processes and Consequences of Using the Term "Genocide"

Room: Western Stage

Section: Political conflict, violence, and crisis

National Narrative and Social Psychological Influences in the Turkish Denial of the Armenian Massacres as Genocide
**Rezarta Bilali*, University of Massachusetts Boston

What is Genocide? The Impact of Prototypes on Perceptions of Suffering
**Lucas Mazur*, Clark University
Johanna Ray Vollhardt, Clark University

What's in a Word? Implications of the "Genocide" Label on Collective Memory, National Identity, and Reparative Action
**Tugce Kurtis*, University of Kansas
Glenn Adams, University of Kansas

Chair: *Johanna Ray Vollhardt*, Clark University

Discussant: *Orla Muldoon*, University of Limerick

S4.3 3G Individual and Social Context Influences on Intergroup Contact Effects

Room: American

Section: Intergroup relations

Contextual effect of intergroup contact: The role of tolerant ingroup norms

**Oliver Christ*, University of Marburg
Miles Hewstone, University of Oxford
Nicole Tausch, St. Andrews University
Hermann Swart, Stellenbosch University
Ananthi Al Ramiah, University of Oxford
Katharina Schmid, University of Oxford
Ulrich Wagner, University of Marburg

Socioeconomic status and identity strategies among Palestinian Muslims and Christians citizens of Israel

**Serene Mjally-Knani*, Ben Gurion University

Differential effects of intergroup contact for authoritarians and social dominators: A Dual Process Model perspective

**Frank Asbrock*, University of Marburg
Oliver Christ, University of Marburg
John Duckitt, University of Auckland
Chris G. Sibley, University of Auckland

“Imagine meeting a gypsy...” – The effects of imagined contact for authoritarians

**Lisa Gutenbrunner*, University of Marburg
Frank Asbrock, University of Marburg
Ulrich Wagner, University of Marburg

Chair: *Frank Asbrock*, University of Marburg

Discussant: *Chris G. Sibley*, University of Auckland

S4.4 4D Personality, Political Context, and Leadership

Room: Merchants

Section: Leadership and political personality

Motive Congruence, Leader Personality and Democratic Reform in Burma

**Susan Marlene Williamson*, University of Connecticut

Office, Policy or Popularity? Motivations for presidential action in parliamentary and semi-presidential systems

**Philipp Köker*, University College London

Unlocking Coalition Governance in Europe: The Effect of Prime Ministers' Leadership Style on Government Behavior

**Hava Karakas Keles*, Syracuse University
**Margaret G. Hermann*, Moynihan Institute of Global Affairs, Maxwell School, Syracuse University



Chair: *Susan Marlene Williamson*, University of Connecticut

S4.5 5L Political Combat: Conviction, Attitude Strength, and Authoritarianism

Room: Mansion House

Section: Electoral behavior and public opinion

Argumentativeness and Self-monitoring Trait Expectations on Student Candidates in Electoral Marketplace

**Reysa Aretha Nasroen*, Crisis Center, Faculty of Psychology, University of Indonesia

The Proposition 8 Conundrum: A Qualitative Exploration of Pro-8, Pro-Obama Voting

**Brian Tilley*, National University

Zeroing in on the Right: Education and the Partisan Expression of Authoritarianism

**Christopher Federico*, Department of Psychology, University of Minnesota

Michal Reifen Tagar, Department of Psychology, University of Minnesota, USA

Dimensions of Policy Preferences across Latinos, Blacks, and Whites and Their Political Consequences

**Christopher David Johnston*, SUNY-Stony Brook

**Angel Saavedra Cisneros*, Clarkson University

Chair: *Thomas Julian Wood*, University of Chicago

Discussant: *Elizabeth Suhay*, Lafayette College

S4.6 6A Cues in political communication: Persuasion and backlash effects

Room: Bulls Head

Section: Political communication

Political Cues, Racial Cues, and the Stigmatization of Mental Illness

**Monique L. Lyle*, Vanderbilt University

The Court of Public Opinion: Responses to Contradictory Cues from the Media and Supreme Court

**Michael Zilis*, University of Michigan

How Cross-Pressured Voters are Influenced by Wedge Issue Messages

**Morten Pettersson*, Department of Political Science, Aarhus University

Measuring the impact of identity and economic party cues on citizens support for European integration

**Michaela Maier*, University of Koblenz-Landau, Communication Psychology, Germany

Silke Adam, University of Bern, IKMB, Switzerland

Andrea Retzbach, University of Koblenz-Landau, Communication Psychology, Germany

Chair: *Michael Bang Petersen*, University of Aarhus

Discussant: *Beth Miller*, University of Missouri-Kansas City

S4.7 7D Ideology, Representation and Political Knowledge

Room: Steamboat

Section: Political culture, identity, and language

Criteria for Negativity in Political Discourse.

**Anastasia Kucharski*, Harvard University

Go With What You Know: Partisanship, Political Knowledge, and Selective Viewership of Presidential Events

**Brian Harrison*, Northwestern University

The Morality of Representation: Constituent Moral Foundations and Position-taking in Congress

**Bradley Jones*, University of Wisconsin, Madison

Tomkins' Polarity Theory revisited: How Humanism and Normativism shape political ideology

**Artur Nilsson*, Lund University

John Jost, New York University

Chair: *Sarah Harrison*, LSE

Discussant: *Michael Bruter*, LSE

S4.8 8B Experiments in Gender and Political Psychology

Room: Lake House

Section: Political behavior and electoral decision making

Objects don't Object: The Disruptive Function of Self-Objectification for Women's Gender-Based Collective Action

**Rachel M. Calogero*, Virginia Wesleyan College

Testing the Accessibility of Party and Gender Stereotypes

**Monica C. Schneider*, Miami University of Ohio

**Angela Lynne Bos*, College of Wooster

Gender, Emotional Reactions to Threat, and Policy Preferences

**Erin Cassese*, West Virginia University

**Rebecca Hannagan*, Northern Illinois University

Women Don't Run: Gender Differences in Candidate Entry

**Kristin Kanthak*, University of Pittsburgh

**Jonathan Woon*, University of Pittsburgh

Chairs: *Monica C. Schneider*, Miami University of Ohio

Angela Lynne Bos, College of Wooster

Discussants: *Rose McDermott*, UCSB

Grace Deason, University of Wisconsin - La Crosse

S4.9 8C Information Processing and Political Knowledge

Room: Shakespeare

Section: Political behavior and electoral decision making



Disentangling Networks: The Multiple Roles of Networks in Influencing Individuals' Knowledge and Resistance to Persuasion

**Lindsey Clark Levitan*, Stony Brook University

Political Identity and Engagement among Political Independents

**Samara Mani Klar*, Northwestern University

How Candidate Race Conditions Voter Responses to Negative Ads

**Spencer Piston*, University of Michigan

Don't read all about it! : How Cognitive Dissonance and Affective Intelligence compete in our understanding of political information processing

**Alexander James Hammond*, University of Essex

Chair: *Carlos Paez*, Florida State University

Discussants: *Jennifer Jerit*, Florida State University

Scott Clifford, Florida State University

S4.10 9C Constructing Ethical Games, Testing Their Psychological Impact

Room: Sauganash East

Section: Civic engagement and civic development

Moral dilemmas: philosophical illustrations

**Joanna Scott*, Eastern Michigan University

Constructing Ethical Games.

**Kristen Renwick Monroe*, University of California, Irvine

Discussants: *Catarina Kinnvall*, Lund University

Lina H. Kreidie, University of California, Irvine

SATURDAY, JULY 7 3:30 PM-5:00 PM

S5.1 1K THEME Politicising Religion In Contemporary Indonesia

Room: Sauganash East

Section: Thematic session: Identity Politics and Politicized Identities

Jihad as justification: national-survey evidence of belief in violent jihad as a mediating factor for sacred violence and terrorism in indonesia

**Hamdi Muluk*, Department of Psychology - University of Indonesia

**Nathanael Sumaktoyo*, Department of Psychology, University of Indonesia

**Dhyah Madya Ruth*, Lazuardi Birru Foundation

Understanding Politicized Religion In Contemporary Indonesia: A Case study of Khilafa-Sharia Movement

**Tutut Chusniyah*, State University of Malang

Radicalization of Jihad doctrine as Motivation to Join Terror Action: A Study of Bali Bombing Terrorist in Indonesia

**Mirra Noor Milla*, Islamic State University Sultan Syarif Kasim Riau Indonesia

A case study of behavioral integrity of Islamic political leader in Indonesia

**Cornelia Istiani*, Department of Psychology Bina Nusantara University, Indonesia

Chair: *Hamdi Muluk*, Department of Psychology - University of Indonesia

Discussant: *Jerome Braun*, Independent Scholar

S5.2 2C Context Matters: Measuring the Impact of Social Ecologies of Political Violence on Adolescents and Mothers

Room: American

Section: Political conflict, violence, and crisis

Identifying Profiles of Risk for Youth in Contexts of Political Violence

**Christine E. Merrilees*, University of Notre Dame

Laura K. Taylor, University of Notre Dame

Marcie Goeke-Morey, Catholic University

Ed Cairns, University of Ulster

Peter Shirlow, Queen's University Belfast

E. Mark Cummings, University of Notre Dame

Segregation and Youth's Intergroup Behaviour and Implicit Attitudes in Conflicted Societies

**Shelley McKeown*, University of Ulster

Ed Cairns, University of Ulster

Political Violence and Child Adjustment: A Four-Wave Test of the Trajectories of Emotional Insecurity about Community

**E. Mark Cummings*, University of Notre Dame

Laura K. Taylor, University of Notre Dame

Christine E. Merrilees, University of Notre Dame

Marcie Goeke-Morey, Catholic University

Peter Shirlow, Queen's University Belfast

Ed Cairns, University of Ulster

Crime and Attitudes toward the Police in Post-Accord Belfast

**Peter Shirlow*, Queen's University Belfast

Rebecca Etkin, University of Notre Dame

Laura K. Taylor, University of Notre Dame

Christine E. Merrilees, University of Notre Dame

Marcie Goeke-Morey, Catholic University

Andrea Campbell, University of Ulster

Ed Cairns, University of Ulster

E. Mark Cummings, University of Notre Dame

Chair: *Laura K. Taylor*, University of Notre Dame

Discussant: *Linda R. Tropp*, University of Massachusetts Amherst



S5.3 5B Do You See What I See? The Power of Perceptions

Room: Mansion House

Section: Electoral behavior and public opinion

Shaping what we do by shaping how we think others think: The perception of the National Front in the 2012 French presidential election

**Isabelle Goncalves Portelinha*, London School of Economics and Political Science
Guy Elcheiroth, University of Lausanne

The Accuracy of Mass Perception: Perceived versus Actual Political Polarization

**Lori Bougher*, University of Cambridge

The Politicization of the U.S. Supreme Court and the Three Key Properties of Perceived Legitimacy

**Ben Woodson*, Stony Brook University - Political Science

Under Pressure: The Polarizing Effect of Expected Social Interaction with a Fellow Partisan

**Eric Groenendyk*, University of Memphis

Chair: *Jayme Neiman*, University of Nebraska-Lincoln

Discussants: *Justin W. Holmes*, University of Northern Iowa

Scott Clifford, Florida State University

S5.4 7B National and European Identity: Foreign policy and decision-making

Room: Steamboat

Section: Political culture, identity, and language

Aspects of national identification and their impact on attitudes toward outgroups

**Robert T. Schatz*, Metropolitan State College of Denver

Economic Wealth as “Narcissistic stuffing”: Aspects of National Identity in Contemporary Germany and the Holocaust

**Katharina Rothe*, University of Leipzig

Oliver Decker, University of Leipzig

‘Constraint’ and lay foreign policy decision making: The dilemmatic nature of Irish neutrality

**Emma O’Dwyer*, Queen’s University Belfast

Evanthia Lyons, Queen’s University Belfast

Christopher Cohrs, Queen’s University Belfast

Feeling European? Mass European identity in the 27 member states - results of a mass panel study

**Sarah Harrison*, LSE

**Michael Bruter*, LSE

Chair: *Horst-Alfred Heinrich*, University of Passau

Discussant: *Gordon Sammut*, Department of Psychology, University of Malta

S5.5 8E Partisanship & Identity

Room: Shakespeare

Section: Political behavior and electoral decision making

Partisans as Bayesians: Exploring Perceptual Biases in Factual Belief Updating

**William D. Flanders IV*, Florida State University

**Jason Barabas*, Florida State University

It's My Party: Exploring Partisan Intensity Through the Lens of Implicit Party Identity

**Alexander George Theodoridis*, University of California, Berkeley

The Effects of Social Networks on Information Processing and Attitudinal Bias

**Lindsey Clark Levitan*, Stony Brook University

**Julie Wronski*, Stony Brook University

Are Liberals Really More Complex than Conservatives?: Interactions Between Topic Domain and Ideology

**Lucian Gideon Conway*, The University of Montana

Chair: *Jason Barabas*, Florida State University

Discussants: *Julie Wronski*, Stony Brook University

Delia Dumitrescu, Universite de Montreal

S5.6 9A Book Roundtable: No Citizen Left Behind

Room: Bulls Head

Section: Civic engagement and civic development

Roundtable Participant

**Cathy Cohen*, University of Chicago

Roundtable Participant

**Reuel Rogers*, Northwestern University

Roundtable Participant

**Diana Hess*, Spencer Foundation

Chair: *Helen Haste*, Harvard Graduate School of Education

S5.7 9F Morality, Justice Sensitivity, and Civil Courage

Room: Lake House

Section: Civic engagement and civic development

Emotional determinants of civil courage: Why some intervene, while others stand and watch

**Anna Halmburger*, University of Koblenz-Landau

Anna Baumert, University of Koblenz-Landau

Manfred Schmitt, University of Koblenz-Landau



The German “Wutbürger” - How justice sensitivity accounts for interindividual differences in political activism

**Tobias Rothmund*, University of Koblenz-Landau

Anna Baumert, University of Koblenz-Landau

Understanding Morally Motivated Behavioral Intentions: A Matter of Consequence or Conscience?

**Linda J. Skitka*, University of Illinois at Chicago

Daniel Wisneski, University of Illinois at Chicago

When “should” matters more than “could”: Obligation mediates moral conviction’s effects on activism

**G. Scott Morgan*, Drew University

Linda J. Skitka, University of Illinois at Chicago

Discussant: *Spencer Piston*, University of Michigan

5.8 11D Poster Session: New theoretical and methodological developments AND 9B Poster Session: Civic Development and Civic Education

Room: Sauganash Foyer

A Modest Proposal for an International Database on Conspiracy Theories

**Godefrida Petit*, Leiden University

New forms of political education for young politicians

**Alexander Ivanovich Yuriev*, St. Petersburg State University

RWA and SDO Differentially Moderate the Effects of Political Message Framing on Candidate Support

**Jarret T. Crawford*, Psychology Department, The College of New Jersey

Civic Skills and the Civic and Political Engagement of Young People

**David Bourgeois*, Saint Mary’s University

**Jim Cameron*, Saint Mary’s University

How identity shapes the nature of civic participation in adolescents

**Tenelle Joan Porter*, Stanford University

Parissa Jahromi, Stanford University

William Damon, Stanford University

Reshuffling Democracy: A Q-method study of stakeholders’ perceptions about the governance of Costa Rica’s electricity sector

**Sergio Guillen*, University of Costa Rica

5.9 11G Theoretical advances in Ideology, polarization and order

Room: Merchants

Section: New theoretical and methodological developments

Ideological Asymmetry in the Relationship Between Needs for Certainty and Order and Political Engagement

**Christopher Federico*, Department of Psychology, University of Minnesota

Emily Fisher, University of Minnesota
Grace Deason, University of Wisconsin - La Crosse

Political Moderates are Better at Threat Detection
**Robert Foels*, University of Connecticut
Jessica Kang, University of Connecticut
Atilla Cidam, University of Connecticut
Felicia Pratto, University of Connecticut

Tomkins' Polarity Theory and the differences between Humanism and Normativism
**Artur Nilsson*, Lund University
John Jost, New York University

Discussant: *Yioryos Nardis*, University of Michigan

S5.10 12D Working for the Group? The Interplay between Emotions, Motivations, and Engagement in Protest or Cooperation

Room: Western Stage

Section: Social inequality and social change

Affective Mediators of Distinct Responses to Relative Deprivation: Distinguishing Between Anger, Fear, Gratitude, and Sadness

**Danny Osborne*, University of Auckland
Heather J. Smith, Sonoma University
Yuen J. Huo, University of California, Los Angeles

Emotion, Value and Power in Protest, How Demonstration Issues Shape Emotion

**Dunya van Troost*, VU University

System Justification Theory and Political Support for Government Subsidies of Child Care

**Sven van de Wetering*, University of the Fraser Valley
Andrea Hughes, Department of Psychology, University of the Fraser Valley

Leaders' Decisions to Sanction and the Role of Emotions in Social Dilemmas

**Sanne Afra Maria Rijkhoff*, Washington State University
Erik W. De Kwaadsteniet, Leiden University
Eric van Dijk, Leiden University

Chair: *Diego Benegas Loyo*, Universidad Popular Madres de Plaza de Mayo

SATURDAY, JULY 7 5:00 PM-6:00 PM

S6.1 JSC Mentoring Tea

Room: Sauganash Foyer

Section: ISPP 35th Annual Scientific Meeting

SATURDAY, JULY 7 5:30 PM-7:00 PM

S7.1 Spencer Foundation Sponsored Reception for "New Civics"

Room: Edgewater



Section: ISPP 35th Annual Scientific Meeting

SUNDAY, JULY 8 9:00 AM-10:30 AM

S1.1 1B THEME Emotions as Antecedents and Consequences of Collective Action

Room: Sauganash East

Section: Thematic session: Identity Politics and Politicized Identities

“We’re Mad as Hell and We’re Not Going to Take it Anymore”: Anger Self-Stereotyping and Collective Action

**Diana Leonard*, University of California, Santa Barbara

Wesley G. Moons, University of California Davis

Diane Mackie, University of California, Santa Barbara

Eliot R. Smith, Indiana University, Bloomington

‘This will Bring Shame upon our Nation’: The Role of Anticipated Group-Based Emotions on Collective Action

**Shepherd Lee*, Stirling University

Russell Spears, Cardiff University

Tony Manstead, Cardiff university

Emotional Consequences of Collective Action Participation: Differentiating Self-Directed and Outgroup Directed Emotions

**Julia Becker*, University of Marburg

Nicole Tausch, St. Andrews University

Ulrich Wagner, University of Marburg

Emotional Reactions to Success and Failure of Collective Action as Predictors of Future Action Intentions: A Longitudinal Investigation in the Context of Student Protests in Germany

**Nicole Tausch*, St. Andrews University

Julia Becker, University of Marburg

Chairs: *Nicole Tausch*, St. Andrews University

Julia Becker, University of Marburg

Discussant: *Leda Blackwood*, St. Andrews University

S1.2 2P The Rise of Extremism and Political Violence

Room: Mansion House

Section: Political conflict, violence, and crisis

Community support or contagion? A test of two theories of extremism in the Israeli-Palestinian conflict

**Janice R. Adelman*, NSI, Inc.

Jeff Victoroff, University of Southern California Keck School of Medicine

Extreme Similarities? Comparing Integrative Complexity, Power Imagery, and Values Across Extremist Groups

**Carson Kenneth Logan*, University of British Columbia

Ryan Wayne Cross, University of British Columbia--Department of Psychology

Peter Suedfeld, University of British Columbia

Violent Values - Exploring the Relationship between Human Values and Violent Attitudes

**Ralph Sundberg*, Department of Peace and Conflict Research, Uppsala University

Is Evil Born or Made? The Case of London Riots

**Patricia Nataly Slawuta*, New School for Social Research, New York City

Monica M. Gerber, London School of Economics and Political Science

Emanuele Castano, New School for Social Research

“Politicized Identities and the Birth of Modern Terrorism”

**Anna Geifman*, Boston University

Chair: *Janice R. Adelman*, NSI, Inc.

Discussant: *Nathan Kalmoe*, University of Michigan, Ann Arbor

S1.3 30 Towards Positive Intergroup Relations

Room: Bulls Head

Section: Intergroup relations

Empathy and Attitudes Towards Similar and Dissimilar Outgroup Members at the Example of Immigrants

**Alexa Bankert*, Stony Brook University

Improving Tolerance with Future Time Perspective: A Longitudinal Analysis

**Davide Morselli*, Swiss National Centre of Competence in Research LIVES, University of Lausanne

Opening the backdoor to “Super Spreading Activation Theory”: The effect of humor on support for minority rights

**Katie Brown*, The University of Michigan

Diana Betz, University of Michigan

When intergroup contact leads to respect

**Benjamin Liersch*, Intitute for Interdisciplinary Research on Conflict and Violence

Dieta Kuchenbrandt, University of Bielefeld

Chair: *Benjamin Liersch*, Intitute for Interdisciplinary Research on Conflict and Violence

S1.4 3B Authoritarianism and Conformity

Room: Shakespeare

Section: Intergroup relations

The Value of Education Moderates the Association between Education and Authoritarianism

**Mark J. Brandt*, DePaul University

PJ Henry, NYU Abu Dhabi

Right and Left wing authoritarianism, Social dominance, Political Ideology: A tentative model



**Edgardo Daniel Etchezahar*, University of Buenos Aires
**Nelida Cervone*, Universidad de Buenos Aires

How many factors make up authoritarianism?

**Philip T. Dunwoody*, Juniata College
**Friedrich Funke*, Friedrich Schiller University of Jena
Alyssa Beck, Juniata College
Lyndsey Gianella, Juniata College
Sarah Trescher, Juniata College

Anti-Semitism and Conformity – When Jews disturb our imagination of an homogenous society

**Michael Mueller*, University of Bielefeld
Andreas Zick, University of Bielefeld

Discussant: *Friedrich Funke*, Friedrich Schiller University of Jena

S1.5 5H Do Ideological Differences Run Deep?

Room: Western Stage

Section: Electoral behavior and public opinion

Progressive Opinion and Gay Genes: Understanding the Politics of Biological Explanations for Sexual Orientation

**Elizabeth Suhay*, Lafayette College
**Jeremiah Garretson*, SUNY Stony Brook

The Deep Structure of Ideological Partisanship in the United States

**Jon David Miller*, Institute for Social Research/University of Michigan

The role of ideological categorization in political judgment

**Ingrid Johnsen Haas*, The Ohio State University
Russell H. Fazio, The Ohio State University
Christopher R. Jones, University of Illinois, Urbana-Champaign

Using Electromyography to Measure the Valence of Non-Conscious Emotional Responses Underlying Political Attitudes

**Carly Jacobs*, University of Nebraska-Lincoln
Amanda Balzer, University of Nebraska-Lincoln
Kristen D. Deppe, University of Nebraska-Lincoln
Michael W. Wagner, University of Nebraska-Lincoln
John R. Hibbing, University of Nebraska-Lincoln
Kevin Smith, University of Nebraska

Chair: *John Jost*, New York University

Discussant: *Jeff Brooks*, University of Notre Dame

S1.6 6H Politicization, Polarization, and Health Policy Opinion

Room: American

Section: Political communication

Framing the Political Debate over Sugar-Sweetened Beverage Taxes

**Colleen L. Barry*, Yale University School of Public Health

Framing Obesity's Consequences to Shape Partisans' Evaluations of Obesity as a Public Policy Issue

**Sarah E. Gollust*, University of Minnesota

Who Cares if the Bucket Leaks: Sensitivity to Efficiency Loss Among Supporters and Opponents of Redistribution

**Julia Lynch*, University of Pennsylvania

Mass Polarization: The Effects of Issue Importance and the Information Environment

**Thomas J. Leeper*, Northwestern University

Chair: *Joanne Miller*, University of Minnesota

Discussant: *Joanne Miller*, University of Minnesota

S1.7 10A Ethnocentrism and National Images

Room: Lake House

Section: International relations, globalization, macropolitical issues

Security, Ethnocentrism, and Attitude toward Globalization: An International Test of the Multiculturalism Hypothesis

**Jim Cameron*, Saint Mary's University

Lucie Kocum, Saint Mary's University

John Berry, Queen's University

National Images of North Korea: How Do South Koreans View North Korea?

**Sang Sin Lee*, Seoul National University

The images of the U.S. and the EU among Egyptians: Analyzing regional reactions on international political actions in the Middle East

**Friederike Sadowski*, University of Bielefeld, Germany

Chair: *A. Burcu Bayram*, Ohio State University/MacEwan University

Discussant: *Aaron Rapport*, Georgia State University

SUNDAY, JULY 8 10:45 AM-12:15 PM

S2.1 1I THEME Political Impacts of Political Identity: Experimental Approaches

Room: Sauganash East

Section: Thematic session: Identity Politics and Politicized Identities

The Influence of Competing Identities on Political Preferences: An Experimental Study

**Samara Mani Klar*, Northwestern University

"I Disrespectfully Agree": Partisan-ideological identity alignment and behavioral polarization in the American electorate



**Lilliana Mason*, Stony Brook University

Second-Generation/American Identity Influences on Foreign Policy Attitudes: An Experimental Approach

**Melinda Jackson*, San Jose State University
Karthika Sasikumar, San Jose State University

Why Do Some Whites Favor Black Candidates?

**Jennifer Chudy*, University of Michigan
**Joshua Shipper*, University of Michigan

Chair: *Melinda Jackson*, San Jose State University

Discussant: *Leonie Huddy*, Stony Brook University

S2.2 2L Understanding power and power motivation: Fighting, Persuading, and Taming
Room: Bulls Head

Section: Political conflict, violence, and crisis

Power motive imagery and voting for war/peace in the U.S. Senate

**Amy Richardson*, University of Michigan

"I implore you my White friend": How high implicit power African Americans move Whites to take action for racial equality

**Ruth Ditlmann*, Yale University

Khrushchev Visits the Bolshoi: [More than] a Footnote to the Cuban Missile Crisis

**David Winter*, University of Michigan

Discussant: *Jennifer Chudy*, University of Michigan

S2.3 5F Conspiracies and Cooperation in Public Opinion

Room: Merchants

Section: Electoral behavior and public opinion

Representation of Power in Russia: Transformation of the Hierarchy of Needs

**Igor Yu Kiselev*, Yaroslavl State University (Russia)
Anna G. Smirnova, Yaroslavl State University

The Conspiratorial Style of Mass Public Opinion

Eric Oliver, University of Chicago
**Thomas Julian Wood*, University of Chicago

The Giving Hand of Multiculturalists: Multiculturalism and International Cooperation

**A. Burcu Bayram*, Ohio State University/MacEwan University

Opinion and Military Service

**Troy Allan Schnack*, Fletcher School, Tufts University

Chair: *Julia Elad-Strenger*, Ben Gurion University of the Negev, Israel

Discussant: *Bradley Jones*, University of Wisconsin, Madison

S2.4 5J Religion, Culture, and Issues

Room: Steamboat

Section: Electoral behavior and public opinion

Crowding Out Culture: Scandinavians and Americans Agree on Social Welfare in the Face of Minimal Cues

**Lene Aaroe*, Department of Political Science, University of Aarhus

**Michael Bang Petersen*, University of Aarhus

Heralding the Authoritarian? Parents' Religiosity and Authoritarianism and Children's Selective Trust in Authorities

**Michal Reifen Tagar*, Department of Psychology, University of Minnesota, USA

Kristen Lyons, University of Minnesota

Melissa A. Koenig, University of Minnesota

Christopher Federico, Department of Psychology, University of Minnesota

Mixing Water and Oil: Can Self-declared Religiosity and Secular Positions Go Together in Political Campaign?

**Nathanael Gratias Sumaktoyo*, Loyola University Chicago

Victor C. Ottati, Loyola University Chicago

Vinaya Untoro, Pancasila University, Jakarta

Religion as catalyst or restraint of radical right voting?

**Tim Immerzeel*, Political Sociology

Eva Jaspers, Sociology

Marcel Lubbers, Sociology

Chair: *Justin W. Holmes*, University of Northern Iowa

Discussant: *Michael W. Wagner*, University of Nebraska-Lincoln

S2.5 6B Emotions in political communication and citizens' attitude formation

Room: Western Stage

Section: Political communication

Emotional Appeals in Political Rhetoric: The United States and Germany Compared

**Caterina Rost*, University of Washington

Examining the salience of emotive stimuli in presidential public appeals on perceptions of risk

**Jose D. Villalobos*, University of Texas at El Paso

Cigdem V. Sirin, University of Texas at El Paso

Networks and the Social Structure of Discrete Emotional Reactions

**Christopher Weber*, Louisiana State University

**Jackson Voss*, Louisiana State University

When Peers Disagree about Politics: The Role of Identity and Emotion in Political Cross-Pressure

**Elizabeth Suhay*, Lafayette College

Chair: *Tereza Capelos*, University of Surrey

Discussant: *Andrew J.W. Civettini*, Knox College

S2.6 7C Political Discourses, Symbols and Politicized Identities

Room: American

Section: Political culture, identity, and language

Can New Political Identities Be Forged out of Old Symbolic Resources?

**Natalia Kovalyova*, UNT Dallas

Reactions to Conspiracy Theories and Paedophilic Networks: Convictions, Public Investigations and Lingering Rumours

**Godefrida Petit*, Leiden University

Romantic Liberalism: An Alternative Perspective on Core Liberal Values and Disrespect in the Muhammad Cartoons Controversy

**Gina Gustavsson*, Department of Government, Uppsala University, Sweden

Talking (long-term) unemployment: Ideological dilemmas of entitlement, rights and responsibilities

Cristian Tileaga, Loughborough University

**Kendra Gilbert*, University of East London

Discussant: *Dmitry Chernobrov*, St. Andrews University

S2.7 9E How Political Socialization Research Became Civic Engagement Research: Reflections from 1962 to 2012

Room: Shakespeare

Section: Civic engagement and civic development

Early History of Political Socialization and Civic Engagement : 1962-1999

**Judith Torney-Purta*, University of Maryland

Post-Communist Countries Entering Studies of Civic Education/Engagement: 1994-2012

**Barbara Malak-Minkiewicz*, International Association for the Evaluation of Educational Achievement (IEA)

Civic Engagement Research Entering a New Phase: 1997-2012

**Molly Andolina*, DePaul University

New Analysis Methods for Large Scale Political Attitude Studies: 2004-2012

**Carolyn Barber*, University of Missouri, Kansas City

S2.8 11B Legitimacy and morality

Room: Mansion House

Section: New theoretical and methodological developments

Crime, Trust and the Legitimacy of Legal Institutions: A Comparative European Analysis

**Jonathan Jackson*, London School of Economics

Mike Hough, Institute for Criminal Policy Research, Birkbeck, University of London

Ben Bradford, University of Oxford

Katrin Hohl, LSE

Tia Pooler, LSE

Jouni Kuha, LSE

Forecasting Fair Experiences with the Courts: Do Procedural Justice Expectations Legitimate?

**Joseph Hamm*, University of Nebraska-Lincoln

Brian Bornstein, University of Nebraska-Lincoln

Mitchel Herian, University of Nebraska-Lincoln

Mapping the Moral Permit to Harm: Construction and Validation of the Delegitimization Scale

**Andrew Pilecki*, University of California, Santa Cruz

Phillip L. Hammack, University of California, Santa Cruz

Daniel Bar-Tal, Tel Aviv University

Eran Halperin, IDC Herzliya

The Application of Moral Psychology to Issues of Contentious Politics: A Theoretical Sketch

**Jason Lavelle Griffin*, Washington State University

Chair: *Leda Blackwood*, St. Andrews University

Discussant: *Leda Blackwood*, St. Andrews University

S2.9 13A Immigration, multiculturalism and political attitudes

Room: Lake House

Section: Migration and acculturation

The role of Intergroup Differentiation and Inclusion in Public Engagement with Multiculturalism

**Babette Gekeler*, UCL

Transnational political activities and acculturation attitudes among Senegalese immigrants

**Eva G. T. Green*, University of Lausanne

Oriane Sarrasin, University of Lausanne

Jenny Maggi, University of Geneva

“Reasonable suspicion” about tough immigration legislation: Enforcing laws or racial domination?

**Sahana Mukherjee*, University of Kansas

Ludwin Molina, University of Kansas

Glenn Adams, University of Kansas

Chair: *Oriane Sarrasin*, University of Lausanne

SUNDAY, JULY 8 12:30 PM-1:30 PM

S3.1 Keynote Address by Ronald Fisher

Room: Sauganash East

Section: ISPP 35th Annual Scientific Meeting

SUNDAY, JULY 8 1:45 PM-3:15 PM

S4.1 JSC Publishing Roundtable: Publication Strategies for JSC

Room: Mansion House

Section: ISPP 35th Annual Scientific Meeting

S4.2 1M THEME Models of Collective Action

Room: Sauganash East

Section: Thematic session: Identity Politics and Politicized Identities

Moral obligation and collective action

**Xiana Vilas, USC*

Jose Manuel Sabucedo, Universidad de Santiago de Compostela

Monica Alzate, Universidade de Santiago de Compostela.

Mar Durán, Universidad de Santiago de Compostela

Cristina Gómez Román, Universidad de Santiago de Compostela

Seeing is believing: Communication modality, anger, and support for action on behalf of out-groups

**Demis Errol Glasford, John Jay College & Graduate Center, City University of New York*

Political Activism and Striving for Immortality

**Julia Elad-Strenger, Ben Gurion University of the Negev, Israel*

Chair: *Nicole Tausch, VU University Amsterdam*

Discussant: *Nicole Tausch, St. Andrews University*

S4.3 2M International Conflicts: an Interstate Perspective

Room: American

Section: Political conflict, violence, and crisis

Forecasting Conflict Outcomes between Iran and Israel over the Iranian Nuclear Program

**Ryan Wayne Cross, University of British Columbia--Department of Psychology*

Peter Suedfeld, University of British Columbia

Israeli Support for a Preemptive Strike on Iran Increases When International Backing of Israel Decreases

**Gilad Hirschberger, IDC Herzliya*

Tom Pyszczynski, University of Colorado, Colorado Springs

Motivation to Regulate Emotion in Political-Conflict Decision Making: The Role of Accountability and Beliefs about Emotions

**Carly Wayne, IDC Herzliya*

Eran Halperin, IDC Herzliya

Roni Porat, IDC - Lauder School of Government
Maya Tamir, Hebrew University

The Middle East from peaceful demonstrations and liberal demands to armed conflicts and fundamentalists reign

**Talal Alali*, university of Edinburgh/university of Kuwait

Chair: *Ryan Wayne Cross*, University of British Columbia--Department of Psychology

S4.4 5N Liberals are From Mars, Conservatives are From Venus

Room: Western Stage

Section: Electoral behavior and public opinion

A Real or Imagined Majority? Conservatives Perceive Greater Consensus within their Ranks than do Liberals

**Chadly Stern*, New York University

John Jost, New York University

Tessa West, New York University, Department of Psychology

Nicholas O. Rule, University of Toronto

Disgust and Threat: The Difference Within and Between Ideological Groups

**Kristen D. Deppe*, University of Nebraska-Lincoln

**Karl Giuseffi*, University of Nebraska-Lincoln

Phenylthiocarbamide Detection and Political Ideology

**Jayne Neiman*, University of Nebraska-Lincoln

Moral Conviction and Ideological Consistency

**Michal Reifen Tagar*, Department of Psychology, University of Minnesota, USA

Christopher Federico, Department of Psychology, University of Minnesota

Chair: *Andrew J.W. Civettini*, Knox College

Discussant: *Michael Bang Petersen*, University of Aarhus

S4.5 6G Priming

Room: Bulls Head

Section: Political communication

Race Priming After Obama

**Nicholas Valentino*, University of Michigan

**L. Matthew Vandenbroek*, University of Texas at Austin

Priming Gender: How Campaign Communication Reinforces Stereotypes and Reduces Support for Female Candidates

**Nichole M Bauer*, Indiana University

The Nation as motivation: American cues increase the desire for power

**Travis J. Carter*, University of Chicago Booth School of Business
Melissa J. Ferguson, Cornell University
Ran Hassin, Hebrew University

Chair: *Elizabeth Suhay*, Lafayette College

Discussant: *Christopher Weber*, Louisiana State University

S4.6 7H In-Group Glorification: Emotions, Identity and Youth
Room: Steamboat

Section: Political culture, identity, and language

How do we construct our social identity?

**Horst-Alfred Heinrich*, University of Passau

Political Identity of Russian Youth: What Do They Think about Russia

**Antonina Selezneva*, Moscow State University

Psychology of political culture of contemporary Russian youth

**Maria Solovyeva*, St. Petersburg State University

Chair: *Maria Volynskaia*, St. Petersburg State University

Discussant: *Maria Volynskaia*, St. Petersburg State University

S4.7 10B Identity, Decision-making, and Global Processes
Room: Merchants

Section: International relations, globalization, macropolitical issues

How International Law Obligates? International Identity and Legal Obligation under Anarchy

**A. Burcu Bayram*, Ohio State University/MacEwan University

Mapping correlates of moral engagement: sociocognitive versus just war rationales for the use of force

**Abram Trosky*, Boston University

War Contested National Resilience

**Eyal Lewin*, Ariel University Center

Behavioral implications of fractal organization in human systems

**D. Conor Seyle*, One Earth Future Foundation

Marcel Arsenault, One Earth Future Foundation

Chair: *Gerhard Reese*, Friedrich Schiller University Jena, Germany

Discussant: *Thalia Magioglou*, Maison des sciences de l'Homme, Paris

S4.8 11F Where do we go from here? Reflections on the POPS Special Issue
Room: Lake House

Section: New theoretical and methodological developments

Where do we go from here?

**Rose McDermott*, UCSB

Where do we go from here?

**Alexander George Theodoridis*, University of California, Berkeley

Where do we go from here?

**Paul Nesbitt-Larking*, Huron University College

**Catarina Kinnvall*, Lund University

Where do we go from here?

**Katherine Jane Reynolds*, Australian National University

Where do we go from here?

**Phillip L. Hammack*, University of California, Santa Cruz

Chair: *Helen Haste*, Harvard Graduate School of Education

S4.9 12A Cooperation in Context: Antecedents and Limits of Tolerance

Room: Shakespeare

Section: Social inequality and social change

Towards a Contextualized Understanding of Tolerance

**Marjoka Van Doorn*, Vrije Universiteit Amsterdam, Netherlands

Shared Spaces and Intergroup Relations

**Purnima Singh*, Department of HUSS, IIT Delhi, Delhi-110016, India

Is True Tolerance Possible? Explicit Discrimination among the Ethnically Tolerant

**Boris Bizumic*, The Australian National University

Amanda Kenny, The Australian National University

Chair: *Purnima Singh*, Department of HUSS, IIT Delhi, Delhi-110016, India

Discussant: *Johanna Ray Vollhardt*, Clark University

SUNDAY, JULY 8 3:30 PM-5:00 PM

S5.1 1D THEME History Education and the Construction of Identities

Room: Sauganash East

Section: Thematic session: Identity Politics and Politicized Identities

Historical conceptions about the own nation

**Mario M. Carretero*, Universidad Autonoma

Cesar Lopez, Autonoma University, Madrid, Spain

The relationship between young people's thinking about the nature of historical knowledge and how

they use the past to talk about their identities and lives
**Elizabeth Dawes Duraisingh, HGSE*

The intersection of historical understanding and ethical reflection during early adolescence: A place where time is squared
**Michelle J. Bellino, Harvard Graduate School of Education*
Robert Selman, Harvard Graduate School of Education

The future shapes the present: scenarios, metaphors and civic action
**Helen Haste, Harvard Graduate School of Education*
Amy Hogan, University of Bath

Chair: *Mario M. Carretero, Universidad Autonoma*

Discussant: *Meira Levinson, Harvard Graduate School of Education*

S5.2 2Q Counterterrorism as fear management

Room: American

Section: Political conflict, violence, and crisis

Resilience to Terror and Counterterrorism Programs
**Jerrold M. Post, The George Washington University*

Resiliency in the Face of Terrorism and Mass Casualty: Keys to Our Understanding of Thriving, Surviving, and Making it to the Next Day
**Stevan Hobfoll, Rush University Medical Center*

Making Sense of Terrorism: The Role of Attributions in Responses to Terrorism
**Mark Dechesne, University of Leiden - Campus the Hague*

A Terror Management Theory Perspective on Terrorist and Counter-Terrorist Violence and Psychological Forces that Promote Peace
**Tom Pyszczynski, University of Colorado, Colorado Springs*

S5.3 3E Empirical Tests of Modern Anti-Semitism

Room: Shakespeare

Section: Intergroup relations

The Many Manifestations of Modern Anti-Semitism: Real World Evidence
**Lee Jussim, Rutgers University NB*

Mental Short Cuts to prejudice
**Steven K. Baum, Journal for The Study of Anti-Semitism*

Anti-Semitism in America and Europe: What do the Data Mean? Why Can't Jews Take "Yes" for an Answer?
**Jerome Chanes, CUNY Graduate Center*

Anti-Semitism and Opposition to Israel: Is there a connection?

**Florette Cohen*, CUNY College of Staten Island

Chair: *Florette Cohen*, CUNY College of Staten Island

S5.4 3F Historical Trends in Political Attitudes and Prejudice

Room: Western Stage

Section: Intergroup relations

A decade of Group-Focused Enmity – roots and patterns of outgroup devaluation in Germany

**Andreas Zick*, University of Bielefeld

Beate Küpper, University of Applied Sciences Niederrhein

Andreas Hoevermann, University of Bielefeld, Germany

Xenophobia in Poland, United Kingdom and USA: Changes between 1995 and 2005

**Marek Drogoz*, Warsaw School of Social Sciences and Humanities

Marcin Yszkiewicz, Warsaw School of Social Sciences and Humanities

Social Group Polarization in the U.S.: Attitude Trends and Structure

**Christopher Muste*, University of Montana

Stereotype Threat and the 2008 US Presidential Election

**John Transue*, University of Illinois - Springfield

Chair: *John Transue*, University of Illinois - Springfield

S5.5 5D How People Think About Divisive Issues

Room: Merchants

Section: Electoral behavior and public opinion

A Comparative Perspective on How Political Elites Influence Attitudes on Climate Change

**Jacob Sohlberg*, Lund University

Heated debate: the role of political values in conflict over anthropogenic climate change

**Alexandra Bass*, University of Chicago

The interaction of individuals' immigration attitudes and contextual factors in shaping voting behavior in Switzerland

**Robert Baur*, University of Lausanne

Eva G. T. Green, University of Lausanne

Marc Helbling, Wissenschaftszentrum Berlin für Sozialforschung

"Ivan, rapist and soon to be Swiss!" Impact of gender cues in anti-immigration posters

**Oriane Sarrasin*, University of Lausanne

Nicole Fasel, University of Lausanne

Eva G. T. Green, University of Lausanne

Rémi Schweizer, Swiss Graduate School of Public Administration

Chair: *Emily K. Lynch*, The Ohio State University

Discussant: *Yanna Krupnikov*, Indiana University

S5.6 5A Poster Session: Electoral Behavior, Participation, and Public Opinion AND 8J Poster Session: Political Behavior and Political Communication

Room: Sauganash Foyer

Political and Religious Factors in Belief Acceptance

**Jorge Mendoza*, SUNY Stony Brook

**Emilio J. Lobato*, University of Central Florida

Valerie K. Sims, University of Central Florida

Matthew Chin, University of Central Florida

Predicting Future Political Outcomes: Markets, Polls, and Experts Collide

**Justin Cheng*, Loyola University Chicago

Emotional Responses and Policy Preferences for Use of Robotics by the Military

**Rebecca Hannagan*, Northern Illinois University

**Jake Kenney*, Northern Illinois University

Morality's grip on politics: Moral foundations strengthen and weaken coherence between moral and factual beliefs

**Brittany Liu*, University of California, Irvine

Peter Ditto, University of California-Irvine

Jesse Graham, University of Southern California

Jonathan Haidt, University of Virginia

Ravi Iyer, University Of Southern California

Spassena Koleva, University of Southern California

Overconfidence in partisan politics: Ideological correlates of self-enhancement bias, belief bias, and logical reasoning performance

**Sean Wojcik*, University of California, Irvine

Peter Ditto, University of California-Irvine

Ravi Iyer, University Of Southern California

Spassena Koleva, University of Southern California

Jonathan Haidt, University of Virginia

Jesse Graham, University of Virginia

Matt Motyl, University of Virginia

Public Risk Perceptions of Climate Change: Can we improve risk communication with value congruent framing?

**Isabel Rossen*, Ph.D. student

The Boundaries of Racial Loyalty: Blame, Exit, and Social Identity in the Black Body Politic

**Nyron N. Crawford*, Ohio State University

S5.7 6K Communication mode, media effects and citizens' attitudes

Room: Lake House

Section: Political communication

Dynamics of Persuasion in Response to Events, Pseudo-events, and Issues

**John Brehm*, University of Chicago

News Exposure, Trust in the EU and European Parliament Election Turnout

**Yioryos Nardis*, University of Michigan

Mode of Communication Changes Perceptions of Political Communication

**Juliana Schroeder*, University of Chicago

Nicholas Epley, Chicago Booth

The Effect of Typefaces such as Arial and Courier on Attitude Measures of Authoritarianism

**John K. Donahue*, Hocking College

Chair: *Anna Halmburger*, University of Koblenz-Landau

Discussant: *Delia Dumitrescu*, Universite de Montreal

S5.8 6F Political violence, rhetoric of destruction and citizens' coping strategies

Room: Steamboat

Section: Political communication

The Lone Wolf behind the Norwegian Tragedy

**Siri M. Neset*, Norwegian Institute of Foreign Affairs

Daniel Heradstveit, Norwegian Institute of International Affairs (NUPI)

Matt Bonham, Maxwell School of Syracuse University

The Impact of Media Use and Individual Differences in Coping with Crisis

**Amy E. Jaspersen*, UTSA

**Mary McNaughton-Cassill*, UTSA

Ideologies and Idols of Destruction: School Shooters as Projection Figures and Role Models on Web

**Nils Christian Böckler*, University of Bielefeld; Institute for Interdisciplinary Research on Conflict and Violence

Thorsten Seeger, University of Bielefeld, Institute for Interdisciplinary Research on Conflict and Violence

Chair: *Ingrid Johnsen Haas*, The Ohio State University

Discussant: *Catarina P. Thomson*, Texas A&M University

S5.9 11E Political identities, institutions, structures and their relations

Room: Mansion House

Section: New theoretical and methodological developments

On unidentified dynamics of identity politics/politicized identities

**Aydan Gülerce*, Bogazici University

Social and Political Activism as Psychological Traits

**William McConochie*, Political Psychology Research, Inc.

Public Trust and Confidence in State Courts

**Joseph Hamm*, University of Nebraska-Lincoln

Lisa PytlíkZillig, University of Nebraska-Public Policy Center

Mitchel Herian, University of Nebraska-Lincoln

Brian Bornstein, University of Nebraska-Lincoln

Alan Tomkins, University of Nebraska-Public Policy Center

Lesa Hoffman, University of Nebraska-Lincoln

The Fractal management in public policy

**Inga Sergeevna Burikova*, St. Petersburg State University

Bringing the Person Back In: Boundaries, Perceptions, and the Measurement of Racial Context

**Cara Wong*, University of Illinois, Urbana-Champaign

Chair: *Leda Blackwood*, St. Andrews University

S5.10 12F Social Dominance Theory and the Psychology of Inclusion

Room: Bulls Head

Section: Social inequality and social change

Beyond Me and Mine: Low Social Dominance Orientation and Inclusiveness

**Felicia Pratto*, University of Connecticut

Andrew Lee Stewart, University of Connecticut

Robert Foels, University of Connecticut

Kristin Henkel, Central Connecticut State University

Fouad Bou Zeineddine, University of Connecticut

Davide Morselli, Swiss National Centre of Competence in Research LIVES, University of Lausanne

Social Dominance and Counter Dominance Orientation Scales (SDO/CDO): Testing Measurement Invariance

**Davide Morselli*, Swiss National Centre of Competence in Research LIVES, University of Lausanne

**Felicia Pratto*, University of Connecticut

Fouad Bou Zeineddine, University of Connecticut

**Maria Aranda*, University of Jaen

Andrew Lee Stewart, University of Connecticut

**Atilla Cidam*, University of Connecticut

**Robert Foels*, University of Connecticut

Kevin Durrheim, University of KwaZulu-Natal

Antonio Aiello, University of Pisa

Veronique Eicher, NCCR LIVES, University of Lausanne

Laurent Licata, Université Libre de Bruxelles (ULB)

Ines Meyer, University of Cape Town

Nebojsa Petrovic, University of Belgrade

Rim Saab, Cardiff University

Joseph Sweetman, Cardiff University

■ CONFERENCE DETAILS
SUNDAY JULY 8 • 3:30–6:00,
MONDAY JULY 9 • 9:00–10:30

How SDO and Entitativity Relate to Political Orientation and Engagement: Evidence from an Italian Sardinian Sample

**Antonio Aiello*, University of Pisa

Protesting to Support Protests: Ideology and Identity Predict International Support for the Arab Uprisings

**Andrew Lee Stewart*, University of Connecticut

Felicia Pratto, University of Connecticut

Fouad Bou Zeineddine, University of Connecticut

Robert Foels, University of Connecticut

Antonio Aiello, University of Pisa

Maria Aranda, University of Jaen

Atilla Cidam, University of Connecticut

I-Ching Lee, National Cheng-Chi University

**Liu Li*, Beijing Normal University

Orla Muldoon, University of Limerick

Nebojsa Petrovic, University of Belgrade

**Francesca Prati*, University of Bologna

SUNDAY, JULY 8 5:00 PM-6:00 PM

S6.1 Presidential Address by Bert Kländermans

Room: Sauganash East

Section: ISPP 35th Annual Scientific Meeting

SUNDAY, JULY 8 6:00 PM-7:00 PM

S7.1 Awards Ceremony

Room: Sauganash East

Section: ISPP 35th Annual Scientific Meeting

SUNDAY, JULY 8 7:00 PM-8:30 PM

S8.1 Awards Reception

Room: Sauganash Foyer

Section: ISPP 35th Annual Scientific Meeting

MONDAY, JULY 9 9:00 AM-10:30 AM

M1.1 2H Pathways to Reconciliation: the Contact Hypothesis

Room: Merchants

Section: Political conflict, violence, and crisis

Attitudes of Israeli-Jewish elite members to reconciliation with the Palestinians

**Yehudith Auerbach*, Bar Ilan University

The contribution of dialogue encounters to the development of coexistence orientation among Jews and Palestinians

**Maor Shani*, Bremen International Graduate School of Social Sciences (BIGSSS), Germany

Intergroup Contact and Post-Conflict Reconciliation: Studies in South Africa and Northern Ireland

*Thomas Christopher O'Brien, University of Massachusetts, Amherst
Linda R. Tropp, University of Massachusetts Amherst
Diala Hawi, University of Massachusetts, Amherst

Chair: *Thomas Christopher O'Brien*, University of Massachusetts, Amherst

Discussant: *Marjoka Van Doorn*, Vrije Universiteit Amsterdam, Netherlands

M1.2 3I Stereotyping and Discrimination

Room: Shakespeare

Section: Intergroup relations

Conservative Gaydar: Ideology and the Motivated Correction of Sexual Orientation Judgments

**Chadly Stern*, New York University
Tessa West, New York University, Department of Psychology
John Jost, New York University
Nicholas O. Rule, University of Toronto

Effects of women's political attitudes on hiring decisions

**Magda M. Formanowicz*, Warsaw School of Social Sciences and Humanities
Mikolaj Winiewski, University of Warsaw
Agata Golasa, Warsaw School of Social Sciences and Humanities

Kicking them while they're down: The effects of perceived warmth and social status on punitive intuitions

**Carolyn Côté-Lussier*, London School of Economics

The essential woman and the made man

**Lauren Katharine Ruth*, Yale University
Jojanneke van der Toorn, Yale University
Anna Newheiser, Yale University
Jaime Lynn Napier, Yale University

Chair: *Jojanneke van der Toorn*, Yale University

M1.3 3L Negotiating Group Identity

Room: Steamboat

Section: Intergroup relations

American Muslims Reflecting on Islam and Terrorism

**Pia Knigge*, Auburn University Montgomery
**Edin Mujkic*, Auburn University

Negotiating Ethnic Identities in multicultural Singapore: Through the lens of a mixed ethnicity Singaporean

**Geetha Reddy*, University of Surrey
**Iika Gleibs*, University of Exeter

Threat perception, ethnic identity and national identification among Kurds in Turkey: Testing two models

**Elif Celebi*, Istanbul ehir University

**Talha Köse*, Istanbul ehir University

**Maykel Verkuyten*, Faculty of Social Sciences, University of Utrecht

Effects of Perceived Security of Hierarchy, Apology and Level of Group Categorization on Seeking Assistance from the High Status Group

**Samer Halabi*, The Academic College of Tel-Aviv-Yaffo

Arie Nadler, Tel-Aviv University

Adi Sagi, The Academic College of Tel-Aviv-Yaffo

Sami Hamdan, The Academic College of Tel-Aviv-Yaffo

Chair: *Samer Halabi*, The Academic College of Tel-Aviv-Yaffo

Discussant: *Ashley Jardina*, University of Michigan

M1.4 4B Indirect Assessments of Leader Personality

Room: Mansion House

Section: Leadership and political personality

Containing North Korea: The Psychological Profile of Kim Jong Il

**Aubrey Immelman*, St. John's University (MN)

Possession of Power as a Principal Factor in Manifestation of Politician's Personality: Empirical Researches of Russian Politician's Psychological Traits

**Irina Samuylova*, St. Petersburg State University, Faculty of Psychology, Department of Political Psychology

Psychological and biographical features of modern Russian political elite representatives

**Vera Trofimova*, Lomonosov Moscow State University, faculty of Political Science, department of Political Psychology

The Political Personality of Republican Presidential Candidate Mitt Romney

**Aubrey Immelman*, St. John's University (MN)

Chair: *Vera Trofimova*, Lomonosov Moscow State University, faculty of Political Science, department of Political Psychology

M1.5 5G Advances in Measurement

Room: Sauganash East

Section: Electoral behavior and public opinion

Topic vs. Population: When Will "College Sophomores" be Better Experimental Subjects Than Adults?

**Yanna Krupnikov*, Indiana University

Adam Seth Levine, University of Michigan

The measurement of partisanship as a social identity

**Martin Rosema*, University of Twente
Leonie Huddy, Stony Brook University

Social Identities and Measurement Problems: Order Effects in Question Batteries
**Christopher Muste*, University of Montana

Improving quality of life: A new paradox on wellbeing and wealth
**Romina Paola Bershadsky*, University of Buenos Aires Argentina
**Felix Agustin Ferro*, TEA

Chair: *Stanley Feldman*, Department of Political Science, Stony Brook University (USA)

Discussant: *Stanley Feldman*, Department of Political Science, Stony Brook University (USA)

M1.6 6C Framing

Room: American

Section: Political communication

Motivating Action on Energy in the U.S
**Toby Bolsen*, Georgia State University
James Druckman, Northwestern University
Fay Lomax Cook, Director of the Institute for Policy Research, Northwestern University

Do Different Cuts in the Welfare State Share the Same Argumentative Frame? A Methodology for Comparing Retrenchment.
**Ashley Thornton*, Graduate Institute of International and Development Studies, Geneva, Switzerland

The portrayal of refugees in Canadian newspapers: The impact of the Tamil refugee incident
**Stelian Medianu*, The University of Western Ontario
**Alina Sutter*, University of Zurich
**Victoria M. Esses*, The University of Western Ontario

A Call to Arms: Mobilizing Voting with Violent Metaphors
**Nathan Kalmoe*, University of Michigan, Ann Arbor

Chair: *Jacob Sohlberg*, Lund University

Discussant: *Thomas J. Leeper*, Northwestern University

M1.7 9D Democracy and Its Institutions

Room: Lake House

Section: Civic engagement and civic development

Democratic - Undemocratic Orientation Scale
**Jorge Antonio Biglieri*, Universidad de Buenos Aires
**Paula Quattrocchi*, Universidad de Buenos Aires

Dimensions and Patterns of the Citizenship Role in Democracy
**Orit Ichilov*, Tel-Aviv University

GR-communications as small resonant influences

**Maria Pushkina*, Science Centre of Political Consult, St. Petersburg State University

Blueprint for Political Organization Free of Power Corruption

**Olek Netzer*, NONE

M1.8 12C Reducing Inequality: The Individual, the Group, and the System

Room: Bulls Head

Section: Social inequality and social change

Not That There's Anything Wrong with That: Effects of Personalized Appeals on Marriage Equality Campaigns

**Brian Harrison*, Northwestern University

Melissa Michelson, Menlo College

We Are The World – So What Do We Do? Determinants of Behavioral Responses Against Global Inequality

**Gerhard Reese*, Friedrich Schiller University Jena, Germany

Anne Berthold, Friedrich Schiller University Jena, Germany

Melanie C. Steffens, Friedrich Schiller University Jena, Germany

When Do Americans Support Downward Economic Redistribution?

**Spencer Piston*, University of Michigan

Inequality and Political Trust. How Objective and Subjective Inequality Affects Latin American Democracies

**Juan Carlos Castillo*, P. Universidad Catolica de Chile

Sonja Zmerli, Goethe-University Frankfurt am Main

Chair: *Gerhard Reese*, Friedrich Schiller University Jena, Germany

Discussant: *Erin Hennes*, New York University

M1.9 2R Resistance to Oppression

Room: Western Stage

Section: Political conflict, violence, and crisis

A transnational trans-level power basis model of value preference patterns

**Fouad Bou Zeineddine*, *Felicia Pratto*, *Colin W. Leach*, *Robert Foels*, *Andrew L. Stewart*, *Antonio Aiello*, *Atilla Idam*, *Veronique Eicher*, *Liu Li*, *Davide Morselli*, *Orla Muldoon*, *Francesca Prati*

Attributional Complexity and System Condemnation by Occupy Wall Street Protestors

**Rob Foels*, *Kate Jassin*

Dominance and emotions in the context of the Arab uprisings

**Veronique Eicher*, *Felicia Pratto*, *Davide Morselli*, *Fouad Bou Zeineddine*, *Rob Foels*

The antecedents of a “protester” in the Basque Country: Moderating role of counter-dominance orientation

**Magdalena Bobowik, Felicia Pratto, Fouad Bou Zeineddine, Dario Paez and Nekane Basabe*

Chairs: *Fouad Bou Zeineddine and Felicia Pratto*, University of Connecticut

MONDAY, JULY 9 10:45 AM-12:15 PM

M2.1 2K Perpetuating and Overcoming Oppression and War: Bridging Collective Representations, Political Rhetoric, and Psychological Processes

Room: Mansion House

Section: Political conflict, violence, and crisis

Delegitimization and the moral justification of counterterrorism policy: An analysis of post-9/11 political discourse in the United States

**Andrew Pilecki*, University of California, Santa Cruz

Phillip L. Hammack, University of California, Santa Cruz

Moral (mis-)engagement: Moral self-image and third party's support for war

**Rezarta Bilali*, University of Massachusetts Boston

Colin W. Leach, University of Connecticut

We feel your pain, and we've been there, too: Expressions of solidarity between minority groups in India

**Rashmi Nair*, Clark University

Johanna Ray Vollhardt, Clark University

Opening the floodgates: Voice and silence in collective memory of historical racism

**Phia Salter*, Texas A&M University

Glenn Adams, University of Kansas

Chair: *Rezarta Bilali*, University of Massachusetts Boston

M2.2 4A Leadership and Conceptions of the Political

Room: Steamboat

Section: Leadership and political personality

Neocons as Liberals? Beliefs about 'Leadership' as a Differentiating Variable

**Aaron Rapport*, Georgia State University

Populist Leaders and their Effects on Democratic Attitudes

**Mariana Rodriguez*, Vanderbilt University

The peculiarities of perception of the leaders in the mass media

**Nadezda Vinogradova*, Moscow State University

The Rise of the Nazis as an Example of Sadistic Carnival

**Jerome Braun*, Independent Scholar

Chair: *Aaron Rapport*, Georgia State University

Discussant: *Eyal Lewin*, Ariel University Center

M2.3 6J Scandalization, intimidation and personalization? Investigating coverage and reception of politicians in the media

Room: Shakespeare

Section: Political communication

Remembering more but believing less? Effects of personalized media coverage on memory and trust

**Lukas Otto*, University of Koblenz-Landau

**Michaela Maier*, University of Koblenz-Landau, Communication Psychology, Germany

Silke Adam, University of Bern, IKMB, Switzerland

Framing the Scandal: How the Press Covered the Plagiarism Scandal of the German Ministry of Defense

**Carolyn Jansen*, University of Koblenz-Landau, Department of Political Science

**Jürgen Maier*, U of Koblenz-Landau

On the impact of political scandals on lay persons' justice evaluations and trust

**Anna Halmburger*, University of Koblenz-Landau

Tobias Rothmund, University of Koblenz-Landau

Anna Baumert, University of Koblenz-Landau

Manfred Schmitt, University of Koblenz-Landau

Chair: *Lukas Otto*, University of Koblenz-Landau

Discussants: *Monika Verbalyte*, FU Berlin

Michael W. Wagner, University of Nebraska-Lincoln

M2.4 7A Narratives, Memory and Borders

Room: Merchants

Section: Political culture, identity, and language

Conceptions of memory, political science, and coming to terms with the communist past

**Cristian Tileaga*, Loughborough University

National, Regional and Political Identities in Three Groups of Respondents. Historical Images and Symbols

**Tatiana Evgenyeva*, Moscow State University, Department of Political Science

The powerful Mothers' Association of North East India: Beyond motherhood

**iLiTo Hekishe Achumi*, JawaharLal Nehru University

Chair: *Catarina Kinnvall*, Lund University

M2.5 7G Democracy, Ideology and Rights

Room: Western Stage

Section: Political culture, identity, and language

Examining Ethnic and Religious Identity Associations within the Alevi Community in Turkey
**Cigdem V. Sirin*, University of Texas at El Paso

For Allah and Country: The Impact of Dual Systems on Women's Rights in Turkey
**Erin Hennes*, New York University
Nevin Solak, Middle East Technical University
Gizem Sürenkök, Cornell University
John Jost, New York University

Justice as respect for difference – a closer look at the Romanian society progress in democratizing the public sphere
**Mirela Ghita-Nemes*, Babes-Bolyai University

The Power of Ideology: Theocracy and Democracy in Iran
**Tabassom Fanaian*, University of Oslo - Master Student

Chair: *Kristina Emma Thalhammer*, St. Olaf College

Discussant: *Kristina Emma Thalhammer*, St. Olaf College

M2.6 8I Awareness, Affect, and Attitudes

Room: Bulls Head

Section: Political behavior and electoral decision making

How Do You Like Me Now? An Experiment on Public Opinion and the Likability Heuristic
**Douglas Ahler*, University of California, Berkeley

Political Competences and Political Action: On the Mediation of Political Knowledge
**Frank Reichert*, Christian-Albrechts-Universität zu Kiel, Institut für Psychologie

The Level of Political Awareness of Youth in Georgia
**Guguli Magradze*, Tbilisi State University
**Medea Despotashvili*, Ivane Javakhishvili Tbilisi State University

Chair: *Sanne Afra Maria Rijkhoff*, Washington State University

Discussant: *Ingrid Johnsen Haas*, The Ohio State University

MONDAY, JULY 9 12:30 PM-2:00 PM

M3.1 ISPP Business Meeting

Room: Sauganash East

Section: ISPP 35th Annual Scientific Meeting

INDEX OF PRESENTERS

Presenter Surname	First Name	Institution
Aaroe	Lene	Department of Political Science, University of Aarhus
Acar	Yasemin	Claremont Graduate University
Achumi	iLiTo Hekishe	JawaharLal Nehru University
Adelman	Janice R.	NSI, Inc.
Ahler	Douglas	University of California, Berkeley
Aiello	Antonio	University of Pisa
Alali	Talal	university of Edinbrugh/university of Kuwait
Alves	Hélder	ISCTE-IUL
Andolina	Molly	DePaul University
Anjum	Gulnaz	The New School
Aranda	Maria	University of Jaen
Asbrock	Frank	University of Marburg
Auerbach	Yehudith	Bar Ilan University
Bakker	Bert	Ph.D. scholar
Bankert	Alexa	Stony Brook University
Barabas	Jason	Florida State University
Barber	Carolyn	University of Missouri, Kansas City
Barlow	Charles John	Irving B. Harris Graduate School of Public Policy Studies, The University of Chicago
Barry	Colleen L	Yale University School of Public Health
Barzel	Ori	Lauder School of Government, Diplomacy & Strategy, IDC
Bass	Alexandra	University of Chicago
Batalha	Luisa	The Australian National University
Bauer	Nichole M	Indiana University
Baum	Steven K.	Journal for the Study of Antisemitism
Baur	Robert	University of Lausanne
Bayram	A. Burcu	Ohio State University/MacEwan University
Becker	Julia	University of Marburg
Bell	C. Scott	Appalachian State University
Bellino	Michelle J	Harvard Graduate School of Education
Benegas Loyo	Diego	Universidad Popular Madres de Plaza de Mayo
Bershadsky	Romina Paola	University of Buenos Aires Argentina
Bhatia	Vickie	Stony Brook University
Biglieri	Jorge Antonio	Universidad de Buenos Aires
Bilali	Rezarta	University of Massachusetts Boston
Bilali	Rezarta	University of Massachusetts Boston
Binks	Eve	Liverpool Hope University
Birtek	Nihal	Istanbul University
Bizumic	Boris	The Australian National University
Blackwood	Leda	St. Andrews University

Email

leneaaroe@ps.au.dk
 yasemin.acar@cgu.edu
 ilitophoebe@gmail.com
 jadelman@nsiteam.com
 dahler@berkeley.edu
 antonio.aiello@sp.unipi.it
 dr.alali.talal@gmail.com
 havga@yahoo.com
 mandolin@depaul.edu
 gulnaz_anjum@fulbrightmail.org
 maranda81@gmail.com
 asbrock@staff.uni-marburg.de
 yehudit.auerbach@biu.ac.il
 bakker@sam.sdu.dk
 alexa.bankert@gmail.com
 jason.barabas@fsu.edu
 barberce@umkc.edu
 cjbarlow@uchicago.edu

 colleen.barry@yale.edu
 barzel.ori@post.idc.ac.il
 bass@uchicago.edu
 Luisa.Batalha@anu.edu.au
 nmbauer@indiana.edu
 skbaum@comcast.net
 robert.baur@unil.ch
 bayram.3@osu.edu
 beckerj2@staff.uni-marburg.de
 bellcs@appstate.edu
 mjb033@mail.harvard.edu
 dab310@gmail.com
 romina@medsrl.com.ar
 vickiebhatia@gmail.com
 jabiglieri@gmail.com
 Rezarta.Bilali@umb.edu
 rezartabilali@gmail.com
 binkse@hope.ac.uk
 nbirtek@gmail.com
 boris.bizumic@anu.edu.au
 lmb11@st-andrews.ac.uk

Panel

S2.1, S2.4
 F1.7
 M2.4
 S1.2
 M2.6
 F5.5, S2.5, S5.10
 S4.3
 F4.9
 S2.7
 S1.4
 S5.10
 S2.5, S4.3
 M1.1
 S1.7, S2.7
 S1.3
 F2.8, S5.5
 S2.7
 F5.5

 S1.6
 S2.6
 F2.6, S5.5
 F1.1
 S1.8, S4.5
 F4.8, F5.1, S5.3
 S5.5
 S1.7, S2.3, S4.7
 F2.1, S1.1
 F1.5, S2.6
 S2.10, S5.1
 F2.1, S1.9, S5.10
 M1.5, F1.8
 F5.6
 M1.7
 S4.2
 M2.1, S1.2
 S1.3
 S1.9
 S4.9
 F1.7, S1.1, S2.8, S5.9

Bobowik	Magdalena	University of the Basque Country
Boese	Gregory Dale	University of Manitoba
Bolsen	Toby	Georgia State University
Born	Marieke	Radboud University Nijmegen
Bos	Angela Lynne	College of Wooster
Bou Zeineddine	Fouad	University of Connecticut
Bougher	Lori	University of Cambridge
Bourgeois	David	Saint Mary's University
Brandt	Mark J	DePaul University
Braun	Jerome	Independent Scholar
Brehm	John	University of Chicago
Brooks	Calisha	Tennessee State University
Brooks	Jeff	University of Notre Dame
Brown	Katie	The University of Michigan
Bruter	Michael	LSE
Burikova	Inga Sergeevna	St. Petersburg State University
Burlacu	Diana Elena	Central European University
Burns	Taylor	University of Cambridge
Böckler	Nils Christian	University of Bielefeld; Institute for Interdisciplinary Research on Conflict and Violence
Caballero-Saucedo	Kristell	St. Olaf College
Calcagno	Justine Elizabeth	The Graduate Center, City University of New York
Calogero	Rachel M.	Virginia Wesleyan College
Cameron	Jim	Saint Mary's University
Canetti	Daphna	University of Haifa
Capelos	Tereza	University of Surrey
Carretero	Mario M	Universidad Autonoma
Carter	Travis J	University of Chicago Booth School of Business
Carvacho	Hector	Universität Bielefeld
Cassese	Erin	West Virginia University
Castano	Emanuele	New School for Social Research
Castillo	Juan Carlos	P. Universidad Catolica de Chile
Cehajic-Clancy	Sabina	Sarajevo School of Science and Technology
Celebi	Elif	Istanbul ehir University
Cervone	Nelida	Universidad de Buenos Aires
Chanes	Jerome	CUNY Graduate Center
Chayinska	Mariya	University of Milano – Bicocca
Cheng	Justin	Loyola University Chicago
Chernobrov	Dmitry	St. Andrews University
Chernyak-Hai	Lily	Netanya Academic College, Israel
Cho	Richard	Stony Brook University
Christ	Oliver	University of Marburg
Chrona	Stavroura	University of Surrey, United Kingdom
Chudy	Jennifer	University of Michigan

magdalena.bobowik@ehu.es	F2.3, M1.9
umboeseg@cc.umanitoba.ca	F5.5
tobybolsen@gmail.com	M1.6, S2.8
m.born@fm.ru.nl	F2.1
abos@wooster.edu	S4.8
b.zeineddine@uconn.edu	S5.10, M1.9
ldb30@cam.ac.uk	S5.3
david.bourgeois@smu.ca	S5.8
mbrandt5@depaul.edu	S1.4
j12braun@gmail.com	M2.2, S5.1
jjbrehm@uchicago.edu	S2.8, S5.7
calisha.brooks@yahoo.com	F5.5
jbrooks1@nd.edu	F1.4, S1.5
katiebro@umich.edu	F5.2, S1.3, S2.8
M.Bruter@lse.ac.uk	F1.4, S4.7, S5.4
burikova@cspdom.ru	S5.9
burlacu_diana-elena@ceu-budapest.edu	F5.7
burns.taylor@gmail.com	F1.4
nils.boeckler@uni-bielefeld.de	S5.8
caballer@stolaf.edu	F5.9
jcalcagno@gc.cuny.edu	F5.5
rcalogero@vwc.edu	S4.8
jim.cameron@smu.ca	S1.7, S5.8
dcanetti@poli.haifa.ac.il	F2.2, S1.3
t.capelos@surrey.ac.uk	F4.7, S1.6, S2.5
mario.carretero@uam.es	S5.1
travis.carter@gmail.com	S4.5
hscarvac@uc.cl	S2.5
erin.cassese@mail.wvu.edu	S4.8
castanoe@newschool.edu	F2.3, S1.2, S1.4
jcastillov@puc.cl	M1.8, F2.9
cehajic.sabina@gmail.com	F2.3
elifcelebi@sehir.edu.tr	M1.3
n_cervone@uolsinectis.com.ar	S1.4
chanes@yu.edu	S5.3
m.chayinska@campus.unimib.it	S2.4
jcheng@luc.edu	S5.6
dc54@st-andrews.ac.uk	F2.7, S2.6
lilycher@netanya.ac.il	F4.4
richard.cho@stonybrook.edu	S1.2
christ@staff.uni-marburg.de	S1.4, S4.3
s.chrona@surrey.ac.uk	F4.7
jchudy@umich.edu	S2.1, S2.2

Chusniyah	Tutut	State University of Malang
Cidam	Atilla	University of Connecticut
Cingoz-Ulu	Banu	Middle East Technical University
Civettini	Andrew J.W.	Knox College
Clifford	Scott	Florida State University
Cohen	Cathy	University of Chicago
Cohen	Florette	City University New York (USA)
Cohen	Florette	CUNY College of Staten Island
Conway	Lucian Gideon	The University of Montana
Çoymak	Ahmet	Queen's University Belfast
Craemer	Thomas	University of Connecticut, Department of Public Policy
Crawford	Jarret T.	Psychology Department, The College of New Jersey
Crawford	Nyron N.	Ohio State University
Crenshaw	Martha	Stanford University
Cross	Ryan Wayne	University of British Columbia--Department of Psychology
Cummings	E. Mark	University of Notre Dame
Côté-Lussier	Carolyn	London School of Economics
Dale-Riddle	Allison	University of Michigan
Dawes Duraisingh	Elizabeth	HGSE
Deason	Grace	University of Wisconsin - La Crosse
Dechesne	Mark	University of Leiden - Campus the Hague
Delfino	Gisela Isabel	University of Buenos Aires
Deppe	Kristen D.	University of Nebraska-Lincoln
Despotashvili	Medea	Ivane Javakhishvili Tbilisi State University
Deyneka	Olga Sergeevna	St. Peterburg State University
Ditlmann	Ruth	Yale University
Donahue	John K.	Hocking College
Drazanova	Lenka	Humboldt Universitat zu Berlin
Drogosz	Marek	Warsaw School of Social Sciences and Humanities
Dumitrescu	Delia	Universite de Montreal
Dunwoody	Philip T.	Juniata College
Dutt	Anjali N	University of California, Santa Cruz
Eicher	Veronique	NCCR LIVES, University of Lausanne
Elad-Strenger	Julia	Ben Gurion University of the Negev, Israel
emek	munise	Istanbul University
Esses	Victoria M.	The University of Western Ontario
Estes	Beth	Vanderbilt University
Etchezahar	Edgardo Daniel	University of Buenos Aires
Evgenyeva	Tatiana	Moscow State University, Department of Political Science
Fairdosi	Amir	University of Chicago
Fanaian	Tabassom	University of Oslo - Master Student
Fasel	Nicole	University of Lausanne
Fasoli	Fabio	CIT-EC, Center of Excellence Cognitive Interaction Technology, University of Bielefeld, Germany

tututchusniah@yahoo.com	S5.1
atilla.cidam@uconn.edu	S5.10, S5.9
banucingoz@gmail.com	F2.4
acivetti@knox.edu	F1.4, S2.5, S4.4
sclifford@fsu.edu	S1.8, S2.9, S4.9, S5.3
cjcohen@uchicago.edu	S5.6
florettec@gmail.com	F4.8
florette.cohen@csi.cuny.edu	S5.3
luke.conway@umontana.edu	F4.8, S5.5
acoymak01@qub.ac.uk	F1.8
thomas.craemer@uconn.edu	F5.4
crawford@tcnj.edu	S2.5, S5.8
crawford.574@osu.edu	S5.6
crenshaw@stanford.edu	S2.3
ryan.w.cross@gmail.com	F1.2, S1.2, S4.3
ecumming@nd.edu	S2.4, S4.1, S5.2
c.cote-lussier@lse.ac.uk	M1.2
daleal@umich.edu	F5.4
ead275@mail.harvard.edu	S5.1
gdeason@uwilax.edu	S2.2, S4.8, S5.9
m.dechesne@cdh.leidenuniv.nl	S5.2
giseladelfino@yahoo.com.ar	F2.9, S1.5
kd.anderson@huskers.unl.edu	S1.5, S2.7, S4.4
medeadesp@yahoo.com	M2.6
odeineka@yahoo.com	F1.1
Ruth.Ditlmann@yale.edu	S2.2
johnkdonahue@gmail.com	S5.7
lenka.drazanova@hu-berlin.de	F2.6
md@swps.edu.pl	S5.4
delia.dumitrescu@umontreal.ca	F4.8, F5.7, S2.1, S5.5, S5.7
dunwoody@juniata.edu	S1.4
adutt@ucsc.edu	F5.5
Veronique.Eicher@unil.ch	F4.9, S5.10, M1.9
juliasrenger@gmail.com	S2.3, S4.2
muniseemek@gmail.com	S1.9
vesses@uwo.ca	M1.6
beth.a.estes@vanderbilt.edu	F4.4
edgardoetchezahar@psi.uba.ar	S1.4
etv133@mail.ru	M2.4
amirfairdosi@uchicago.edu	F2.6
philosophos_a2z@yahoo.com	M2.5
nicole.fasel@unil.ch	S1.5, S5.5
ffasoli@cit-ec.uni-bielefeld.de	F5.5

Federico	Christopher	Department of Psychology, University of Minnesota
Feldman	Stanley	Department of Political Science, Stony Brook University (USA)
Ferdmane	Inna	Latvian University
Ferguson	Neil	Liverpool Hope University
Ferro	Felix Agustin	TEA
Flanders IV	William D	Florida State University
Foels	Robert	University of Connecticut
Formanowicz	Magda M.	Warsaw School of Social Sciences and Humanities
Fredén	Annika Maria	Department of Political Science, Lund University
Funke	Friedrich	Friedrich Schiller University of Jena
Gao	Yunjiao Erica	Department of Applied social studies, City University of Hong Kong
Garagozov	Rauf	Center for Strategic Studies
Garretson	Jeremiah	SUNY Stony Brook
Geifman	Anna	Boston University
Gekeler	Babette	UCL
Gerber	Monica M.	London School of Economics and Political Science
Ghita-Nemes	Mirela	Babes-Bolyai University
Gilbert	Kendra	University of East London
Ginges	Jeremy	New School for Social Research
Giuseffi	Karl	University of Nebraska-Lincoln
Glantz	Alexander	University of Bamberg, Germany
Glasford	Demis Errol	John Jay College & Graduate Center, City University of New York
Gleibs	Ilka	University of Exeter
Goeke-Morey	Marcie	Catholic University of America
Golec de Zavala	Agnieszka	CIS IUL, Portugal
Gollust	Sarah E.	University of Minnesota
Goncalves Portelinha	Isabelle	London School of Economics and Political Science
Green	Eva G. T.	University of Lausanne
Greenlee	Jill	Brandeis University
Greuling	Kathrin	University of Koblenz-Landau, Institute for Management
Griffin	Jason Lavelle	Washington State University
Groenendyk	Eric	University of Memphis
Grove	Andrea	CSU Channel Islands
Groß	Eva Maria	IKG, Universität Bielefeld
Guillen	Sergio	University of Costa Rica
Gundlach	Julia	University of Bielefeld
Gupta	Manisha	UMass Amherst
Gustavsson	Gina	Department of Government, Uppsala University, Sweden
Gutenbrunner	Lisa	University of Marburg
Gülerce	Aydan	Bogazici University
Haas	Ingrid Johnsen	The Ohio State University
Halabi	Samer	The Academic College of Tel-Aviv-Yaffo
Halmburger	Anna	University of Koblenz-Landau
Halperin	Erin	IDC Herzliya

federico@umn.edu	S1.8, S2.4, S4.4, S4.5, S5.9
stanley.feldman@sunysb.edu	M1.5, F1.5, S2.3
inna.ferdmane@gmail.com	F5.2
fergusn@hope.ac.uk	F1.6, F2.2
agusferro@hotmail.com	M1.5
wdf09@fsu.edu	F2.8, S5.5
robert.foels@uconn.edu	F4.8, S5.10, S5.9, M1.9
magdalena.formanowicz@swps.edu.pl	M1.2
annika.freden@svet.lu.se	F2.8
sff@uni-jena.de	S1.4
yjgao5@student.cityu.edu.hk	S1.9
rgaragozov@gmail.com	F2.7
jtgarretson@notes.cc.sunysb.edu	S1.5
annageifman@hotmail.com	S1.2
babettegekeler@gmail.com	F5.5, S2.9
m.m.gerber@lse.ac.uk	S1.2, S2.5
mirelaghitanemes@yahoo.com	M2.5
k.s.gilbert@uel.ac.uk	S2.6
jeremyginges@gmail.com	F4.2
karl.giuseffi@huskers.unl.edu	S4.4
alexander.glantz@uni-bamberg.de	F4.7
dglasford@jjay.cuny.edu	F5.5, S4.2
I.H.Gleibs@exeter.ac.uk	M1.3
marciegm@gmail.com	S4.1
agnieszka.golec@gmail.com	F1.3
sgollust@umn.edu	S1.6
isabellegoncalves@gmail.com	S5.3
eva.green@unil.ch	F2.3, S1.5, S2.9, S5.5
greenlee@brandeis.edu	S2.2
greuling@uni-koblenz.de	F5.8
jason_griffin@wsu.edu	F5.10, S2.8
grnendyk@memphis.edu	S5.3
andrea.grove@csuci.edu	F5.1
eva_maria.gross@uni-bielefeld.de	F5.10
garudasofia@yahoo.com	S5.8
julia.gundlach@uni-bielefeld.de	F2.4
manisha@psych.umass.edu	F1.1
gina.gustavsson@statsvet.uu.se	S2.6
gutenbru@staff.uni-marburg.de	S4.3
aydan.gulcerce@gmail.com	S5.9
haas.271@osu.edu	M2.6, S1.5, S1.7, S5.8
halabisa@mta.ac.il	M1.3, F4.4
halmburger@uni-landau.de	M2.3, S5.7
eranh75@hotmail.com	F5.2

Hamm	Joseph	University of Nebraska-Lincoln
Hammack	Phillip L	University of California, Santa Cruz
Hammond	Alexander James	University of Essex
Hannagan	Rebecca	Northern Illinois University
Hanson	Tim	TNS-BMRB, London
Harrison	Brian	Northwestern University
Harrison	Sarah	LSE
Hartman	Todd K	Appalachian State University
Haste	Helen	Harvard Graduate School of Education
Hastie	Brianne	University of South Australia
Heinrich	Horst-Alfred	University of Passau
Henkel	Kristin	Central Connecticut State University
Hennes	Erin	New York University
Hermann	Margaret G.	Moynihan Institute of Global Affairs, Maxwell School, Syracuse University
Hess	Diana	Spencer Foundation
Hirschberger	Gilad	IDC Herzliya
Hobfoll	Stevan	Rush University Medical Center
Hoevermann	Andreas	University of Bielefeld, Germany
Huddy	Leonie	Stony Brook University
Ichilov	Orit	Tel-Aviv University
Immelman	Aubrey	St. John's University (MN)
Immerzeel	Tim	Political Sociology
Istiani	Cornelia	Department of Psychology Bina Nusantara University, Indonesia
Jackson	Jonathan	London School of Economics
Jackson	Melinda	San Jose State University
Jacobs	Carly	University of Nebraska-Lincoln
Jansen	Carolin	University of Koblenz-Landau, Department of Political Science
Jardina	Ashley	University of Michigan
Jaspersen	Amy E	UTSA
Johnston	Christopher David	SUNY-Stony Brook
Jones	Bradley	University of Wisconsin, Madison
Joyce	Carmel	University of Limerick
Jung	Jiin	Claremont Graduate University
Jussim	Lee	Rutgers University NB
Kalkstein	David Abraham	New York University
Kalmoe	Nathan	University of Michigan, Ann Arbor
Kanas	Agnieszka	Radboud University Nijmegen
Kanthak	Kristin	University of Pittsburgh
Karakas Keles	Hava	Syracuse University
Katz	Miriam Israela Laufer	York University
Kenney	Jake	Northern Illinois University
Kim	Caroline	University of Cape Town
Kinnvall	Catarina	Lund University

joe.hamm@hotmail.com	S2.8, S5.9
hammack@ucsc.edu	M2.1, S2.8, S4.8
ajhamm@Essex.ac.uk	S4.9
rhannaga@niu.edu	S4.8, S5.6
tim.hanson@tns-bmrb.co.uk	F5.7
bharrison@u.northwestern.edu	M1.8, S4.7
S.L.Harrison@lse.ac.uk	F1.4, S4.7, S5.4
hartmantk@appstate.edu	F1.5, F2.4, F5.8
helhaste@aol.com	F1.8, S2.10, S4.8, S5.1, S5.6
brianne.hastie@unisa.edu.au	F5.4
Horst-Alfred.Heinrich@uni-passau.de	S4.6, S5.4
kristin.henkel@gmail.com	S2.5, S5.10
eph231@nyu.edu	M1.8, M2.5
mgherman@maxwell.syr.edu	S4.4
dhess@spencer.org	S5.6
hirschg@gmail.com	S4.3
Stevan_Hobfoll@rush.edu	F2.2, S5.2
ah935902@gmx.de	F5.10, S5.4
leonie.huddy@sunysb.edu	M1.5, F1.5, S2.1, S2.3
ichilov@post.tau.ac.il	M1.7
aimmelman@csbsju.edu	M1.4, F2.5, F5.6
t.immerzeel@uu.nl	S2.4
istiani_c@yahoo.com	S5.1
j.p.jackson@lse.ac.uk	S2.8
Melinda.Jackson@sjsu.edu	F1.1, S2.1
cjacobs@huskers.unl.edu	F1.5, F5.4, S1.5
jansenc@uni-landau.de	M2.3
ajardina@umich.edu	M1.3, F5.4
amy.jasperson@utsa.edu	S5.8
johncd1@gmail.com	S4.5
bmjones3@wisc.edu	S2.3, S4.7
carmeljoyce@hotmail.com	S4.1
jiin.jung@cgu.edu	S1.2
jussim@rci.rutgers.edu	S5.3
dak414@nyu.edu	F1.3
kalmoe@umich.edu	M1.6, S1.2
a.kanas@maw.ru.nl	F2.4
kanthak@pitt.edu	S4.8
hkarakas@maxwell.syr.edu	S4.4
m.il.katz@gmail.com	F4.1
j_kenney14@sbcglobal.net	S5.6
caroline_kim@mail.harvard.edu	S1.4
catarina.kinnvall@svet.lu.se	M2.4, F1.7, F2.7, S4.10, S4.8

INDEX

of conference presenters

Kiselev	Igor Yu	Yaroslavl State University (Russia)
Klar	Samara Mani	Northwestern University
Knigge	Pia	Auburn University Montgomery
Koopman	Cheryl	Stanford University
Kosterman	Brett	University of Amsterdam
Kovalyova	Natalia	UNT Dallas
Kronberger	Nicole	Johannes Kepler University Linz
Krupnikov	Yanna	Indiana University
Kucharski	Anastasia	Harvard University
Kuchenbrandt	Dieta	University of Bielefeld
Kurtis	Tugce	University of Kansas
Köker	Philipp	University College London
Köse	Talha	Istanbul ehir University
Langner	Carrie	California Polytechnic State University
Latta	Tara A.	The Family Institute at Northwestern University
Laustsen	Lasse	Department of Political Science, Aarhus University
Lee	Sang Sin	Seoul National University
Lee	Shepherd	Stirling University
Leeper	Thomas J.	Northwestern University
Leidner	Bernhard	University of Massachusetts Amherst
Leonard	Diana	University of California, Santa Barbara
Levinson	Meira	Harvard Graduate School of Education
Levitan	Lindsey Clark	Stony Brook University
Lewin	Eyal	Ariel University Center
Li	Liu	Beijing Normal University
Liersch	Benjamin	Institute for Interdisciplinary Research on Conflict and Violence
Liht	Jose	University of Cambridge
Liu	Brittany	University of California, Irvine
Lobato	Emilio J	University of Central Florida
Lodge	Milton	Stony Brook University
Logan	Carson Kenneth	University of British Columbia
Lown	Patrick	Stony Brook University
Luguri	Jamie	Yale University
Lyle	Monique L	Vanderbilt University
Lynch	Emily K	The Ohio State University
Lynch	Julia	University of Pennsylvania
Magradze	Guguli	Tbilisi State University
Mahomed	Faraaz	Monterey Institute of International Studies
Maier	Jürgen	U of Koblenz-Landau
Maier	Michaela	University of Koblenz-Landau, Communication Psychology, Germany
Malak-Minkiewicz	Barbara	International Association for the Evaluation of Educational Achievement (IEA)
Malanchuk	Oksana	University of Michigan
Marrouch	Natasza Natalia	NYU

kisselev@univ.uniyar.ac.ru	S2.3
samara@u.northwestern.edu	S2.1, S2.8, S4.9
pknigge@aum.edu	M1.3
koopman@stanford.edu	F5.3
b.d.kosterman@uva.nl	F5.5
natashakovalyova@hotmail.com	S2.6
nicole.kronberger@jku.at	F5.8
ykrupnik@indiana.edu	M1.5, S1.8, S5.5
kucharski.a@gmail.com	F2.5, S4.7
dkuchenb@cit-ec.uni-bielefeld.de	S1.3, S1.4
tugcekurtis@gmail.com	S4.2
philipp.koker.09@ucl.ac.uk	S4.4
talhako@yahoo.com	M1.3
clangner@calpoly.edu	S2.2, S4.1
taralatta2008@u.northwestern.edu	F5.6
ll@ps.au.dk	F5.6
sslee2310@gmail.com	S1.7
lee.shepherd@stir.ac.uk	S1.1
thosjleeper@gmail.com	M1.6, S1.6, S1.8, S2.8
bleidner@psych.umass.edu	F2.3
diana.leonard@psych.ucsb.edu	S1.1
meira_levinson@harvard.edu	S2.10, S5.1
lindsey.levitan@stonybrook.edu	S4.9, S5.5
lewin1212@gmail.com	M2.2, F1.2, F4.7, S4.7
l.liu@bnu.edu.cn	S5.10
bliersch@uni-bielefeld.de	S1.3
joseliht@gmail.com	F1.4
b.liu@uci.edu	S5.6
emiliol1985@knights.ucf.edu	S5.6
milton.lodge@StonyBrook.edu	S1.2
carsonklogan@gmail.com	S1.2
patrick.lown@stonybrook.edu	F2.9
jamie.luguri@yale.edu	F1.3
monique.l.lyle@vanderbilt.edu	S4.6
lynch.379@osu.edu	F2.6, S5.5
jflynch@sas.upenn.edu	S1.6
gugulimagradze@yahoo.com	M2.6
faraazmahomed@gmail.com	F4.7
maierj@uni-landau.de	M2.3, S1.6
mmaier@uni-landau.de	M2.3, S1.6, S4.6
b.malak@iea.nl	S2.7
oksana@umich.edu	S4.1
natamarr@gmail.com	F4.4

Mason	Lilliana	Stony Brook University
Matland	Richard E	Loyola University Chicago
Mazur	Lucas	Clark University
McAuley	James White	University of Huddersfield
McCauley	Clark	Bryn Mawr College
McConochie	William	Political Psychology Research, Inc.
McDermott	Rose	UCSB
McFarland	Sam	Western Kentucky University
McKeown	Shelley	University of Ulster
McLellan	Lianne	Defence R&D Canada
McMahon	Juliet	University of Limerick
McNaughton-Cassill	Mary	UTSA
Medianu	Stelian	The University of Western Ontario
Mendoza	Jorge	SUNY Stony Brook
Mentovich	Avital	Ph.D. student for Social Psychology at NYU
Merrilees	Christine E	University of Notre Dame
Milla	Mirra Noor	Islamic State University Sultan Syarif Kasim Riau Indonesia
Miller	Beth	University of Missouri-Kansas City
Miller	Joanne	University of Minnesota
Miller	Jon David	Institute for Social Research/University of Michigan
Mintz	Alex	Lauder School of Government, IDC
Mjally-Knani	Serene	Ben Gurion University
Monroe	Kristen Renwick	University of California, Irvine
Moody	Kristen	The George Washington University
Morag	Nadav	Naval Postgraduate School
Moret	Madeleine	University of Amsterdam - Ph.D.
Morgan	G. Scott	Drew University
Morrison	Robert G	Loyola University Chicago
Morselli	Davide	Swiss National Centre of Competence in Research LIVES, University of Lausanne
Moss	Sigrun Marie	The Norwegian University of Science and Technology, Trondheim, Norway
Mueller	Michael	University of Bielefeld
Mujkic	Edin	Auburn University
Mukherjee	Sahana	University of Kansas
Muldoon	Orla	University of Limerick
Muluk	Hamdi	Department of Psychology - University of Indonesia
Muste	Christopher	University of Montana
Mycok	Andy	University of Huddersfield
Myers	Charles Daniel	University of Michigan
Nair	Rashmi	Clark University
Nardis	Yioryos	University of Michigan
Narvaez	Darcia	University of Notre Dame
Nasroen	Reysa Aretha	Crisis Center, Faculty of Psychology, University of Indonesia

lillianahall@gmail.com	S2.1
rmatlan@luc.edu	S1.8
lmazur@clarku.edu	S4.2
j.w.mcauley@hud.ac.uk	F1.6
cmccaule@brynawr.edu	S2.3
Bill@Politicalpsychologyresearch.com	F2.9, S5.9
rmcdermott@polsci.ucsb.edu	F5.3, S2.1, S4.8
sam.mcfarland@wku.edu	F4.3
shelleymckeown@googlemail.com	S5.2
lianne.mclellan@gmail.com	F4.8
juliette.mcmahon@ul.ie	F5.10
mary.mcnaughtoncassill@utsa.edu	S5.8
smedianu@uwo.ca	M1.6
jorge.mendoza@stonybrook.edu	S5.6
mentovich@nyu.edu	F4.9
cmerrile@nd.edu	S2.4, S4.1, S5.2
mnmilla@gmail.com	S5.1
millerel@umkc.edu	F1.4, F2.8, F5.7, S4.6
jomiller@umn.edu	F2.8, S1.6
jondmiller@umich.edu	S1.5
mintz.alex@idc.ac.il	S1.1, S2.6
mkserene@yahoo.com	S4.3
krmonroe@uci.edu	F5.3, S4.10
krmoody@gmail.com	F4.5
nmorag@nps.edu	S2.6
m.moret@uva.nl	F1.1
smorgan@drew.edu	S1.8, S5.7
rmorrison@luc.edu	S1.8
davide.morselli@unil.ch	S1.3, S5.10
sigrun.marie.moss@svt.ntnu.no	S2.4
michael.mueller12@uni-bielefeld.de	S1.4
emujkic@aum.edu	M1.3
sahana@ku.edu	S2.9
orla.muldoon@ul.ie	F1.6, F2.2, S1.2, S4.2, S5.10
hammuluk@yahoo.com	S5.1
chris.muste@mso.umt.edu	M1.5, S5.4
a.j.mycok@hud.ac.uk	F1.6
myerscd@umich.edu	F5.8, S2.8
rashminair84@gmail.com	M2.1
yiorios@umich.edu	S5.7, S5.9
dnarvaez@nd.edu	F1.4
arethanasroen@hotmail.com	S4.5

Neiman	Jayne	University of Nebraska-Lincoln
Nesbitt-Larking	Paul	Huron University College
Neset	Siri M.	Norwegian Institute of Foreign Affairs
Netzer	Olek	NONE
Nilsson	Artur	Lund University
Nyathi	Lungile Senanelo	University of Bielefeld
O'Brien	Thomas Christopher	University of Massachusetts, Amherst
O'donnell	Aisling	University of Limerick
O'Dwyer	Emma	Queen's University Belfast
O'Sullivan	Michelle	University of Limerick
Obritsch	Andrew	Eastern Illinois Univ. & St. John's Univ. (MN)
Oppermann	Kai	University of Cologne
Orey	Byron D'Andra	Department of Political Science at Jackson State University
Osborne	Danny	University of Auckland
Otto	Lukas	University of Koblenz-Landau
Paez	Carlos	Florida State University
Pedrini	Seraina	University of Zurich
Penic	Sandra	University of Lausanne
Perry	Ryan	The University of Auckland
Pertsis	Ruthie	The George Washington University
Petersen	Michael Bang	University of Aarhus
Petit	Godefrida	Leiden University
Petterson	Morten	Department of Political Science, Aarhus University
Pilecki	Andrew	University of California, Santa Cruz
Piston	Spencer	University of Michigan
Porat	Roni	IDC - Lauder School of Government
Porter	Tenelle Joan	Stanford University
Post	Jerrold M.	The George Washington University
Prati	Francesca	University of Bologna
Pratto	Felicia	University of Connecticut
Price	Erika D	Loyola University Chicago
Proch	Jutta	Friedrich-Schiller-University of Jena, Germany
Pushkina	Maria	Science Centre of Political Consult, St. Petersburg State University
Pyszczynski	Tom	University of Colorado, Colorado Springs
Quattrocchi	Paula	Universidad de Buenos Aires
Rapport	Aaron	Georgia State University
Rauschenbach	Mina	Geneva Academy of International Humanitarian Law and Human rights
Redd	Steven B.	University of Wisconsin-Milwaukee
Reddy	Geetha	University of Surrey
Redlawsk	David	Rutgers University
Reese	Gerhard	Friedrich Schiller University Jena, Germany
Reicher	Stephen	St. Andrews University
Reichert	Frank	Christian-Albrechts-Universität zu Kiel, Institut für Psychologie
Reifen Tagar	Michal	Department of Psychology, University of Minnesota, USA

Jlneiman@hotmail.com	S4.4, S5.3
pnesbitt@huron.uwo.ca	F1.6, S4.8
sne@nupi.no	S5.8
olek.netzer134@gmail.com	M1.7
artunilsson@gmail.com	S4.7, S5.9
l.nyathi@uni-bielefeld.de	S1.6
tcobrien@psych.umass.edu	M1.1
aisling.o'donnell@ul.ie	S1.2
eodwyer01@qub.ac.uk	S5.4
michelle.osullivan@ul.ie	F5.10
amobritsch@eiu.edu	F2.5
kai.oppermann@uni-koeln.de	S2.6
byron.d.orey@jsums.edu	F5.4
d.osborne@auckland.ac.nz	F4.3, S2.7, S5.10
otto@uni-landau.de	M2.3, F5.6
cap10h@my.fsu.edu	F2.8, S4.9
pedrini@ipz.uzh.ch	S2.10
sandra.penic@unil.ch	F4.2
r.perry@auckland.ac.nz	F1.3
rpertsis@gwmail.gwu.edu	F4.5
michael@ps.au.dk	F5.6, S2.4, S4.4, S4.6
g.m.petit@umail.leidenuniv.nl	S2.6, S5.8
pettersson@ps.au.dk	S4.6
apilecki@ucsc.edu	M2.1, S2.8
spiston@umich.edu	M1.8, S4.9, S5.7
porat.roni@gmail.com	F5.2, S4.3
tenellep@stanford.edu	S5.8
jmpost@pol-psych.com	F4.5, S5.2
francesca.prati@unibo.it	S5.10
felicia.pratto@uconn.edu	S2.5, S5.10, S5.9
erikadprice@gmail.com	F5.8
jutta.proch@uni-jena.de	F4.3
mashap@mail.ru	M1.7
tpyszczzy@uccs.edu	S4.3, S5.2
paula.quattrocchi@gmail.com	M1.7
arapport@gsu.edu	M2.2, S1.7
minarau@bluewin.ch	F1.2
sredd@uwm.edu	S2.6
gr00047@surrey.ac.uk	M1.3
redlawsk@rutgers.edu	S2.9
gerhard.reese@uni-jena.de	M1.8, F4.1, S4.7
sdr@st-andrew's.ac.uk	S1.2
reichert@psychologie.uni-kiel.de	M2.6, S1.7
reife014@umn.edu	S1.8, S2.4, S4.4, S4.5

Reynolds	Katherine Jane	Australian National University
Richardson	Amy	University of Michigan
Rico	Guillem	Universitat Autònoma de Barcelona
Rijkhoff	Sanne Afra Maria	Washington State University
Rodriguez	Mariana	Vanderbilt University
Rogers	Reuel	Northwestern University
Rosema	Martin	University of Twente
Rosen	Rebecca Kala	University of Chicago
Rossen	Isabel	Ph.D. student
Rost	Caterina	University of Washington
Rothe	Katharina	University of Leipzig
Rothmund	Tobias	University of Koblenz-Landau
Rublee	Maria Rost	University of Auckland
Ruth	Dhyah Madya	Lazuardi Birru Foundation
Ruth	Lauren Katharine	Yale University
Saavedra Cisneros	Angel	Clarkson University
Sadowski	Friederike	University of Bielefeld, Germany
Salari Rad	Mostafa	The New School for Social Research
Salter	Phia	Texas A&M University
Sammot	Gordon	Department of Psychology, University of Malta
Samuylova	Irina	St. Petersburg State University, Faculty of Psychology, Department of Political Psychology
Sarrasin	Oriane	University of Lausanne
Saunders	Kyle	Colorado State University, Department of Political Science
Schatz	Robert T	Metropolitan State College of Denver
Schnack	Troy Allan	Fletcher School, Tufts University
Schneider	Monica C	Miami University of Ohio
Schnell	Frauke	West Chester University
Schori-Eyal	Noa	University of Maryland
Schroeder	Juliana	University of Chicago
Scott	Joanna	Eastern Michigan University
Selezneva	Antonina	Moscow State University
Seyle	D. Conor	One Earth Future Foundation
Seyle	D. Conor	Issues Deliberation Australia/America
Shani	Maor	Bremen International Graduate School of Social Sciences (BIGSSS), Germany
Shipper	Joshua	University of Michigan
Shirlow	Peter	Queen's University Belfast
Sibley	Chris G.	University of Auckland
Singh	Purnima	Department of HUSS, IIT Delhi, Delhi-110016, India
Sinn	Jeff Scott	Winthrop University
Sirin	Cigdem V.	University of Texas at El Paso
Skitka	Linda J.	University of Illinois at Chicago
Slawuta	Patricia Nataly	New School for Social Research, New York City

katherine.reynolds@anu.edu.au	S4.8
amykrich@umich.edu	S2.2
guillem.rico@uab.es	F5.6
sannerijkhoff@gmail.com	M2.6, S1.7, S5.10
mariana.rodriquez@vanderbilt.edu	M2.2
r-rogers@northwestern.edu	S5.6
m.rosema@utwente.nl	M1.5
rkrosen@uchicago.edu	S2.4
rossei01@student.uwa.edu.au	S5.6
crost@uw.edu	S2.5
k.rothe@uni-leipzig.de	S5.4
rothmund@uni-landau.de	M2.3, S5.7
m.rublee@auckland.ac.nz	F5.1
hamdim@ui.ac.id	S5.1
lauren.ruth@yale.edu	M1.2
asaavedracis@gmail.com	S1.2, S4.5
friederike.sadowski@uni-bielefeld.de	S1.7
salarirad@gmail.com	F1.7
psalter@tamu.edu	M2.1
gordon.sammud@um.edu.mt	F5.9, S5.4
samiral@mail.ru	M1.4
oriane.sarrasin@unil.ch	S1.5, S2.9, S5.5
klsaun@gmail.com	F2.8
schatz@mscd.edu	F4.6, S5.4
taschnack@gmail.com	S2.3
mschneider@muohio.edu	F5.3, S4.8
fschnell@wcupa.edu	S1.9
nschori@umd.edu	F2.3, F4.2
jschroe1@chicagobooth.edu	S5.7
jscott@emich.edu	S4.10
ntonina@mail.ru	S4.6
dcseyle@oneearthfuture.org	S4.7
conor@ida.org.au	F5.8
m.shani@jacobs-university.de	M1.1
jshipper@umich.edu	S2.1
p.shirlow@qub.ac.uk	S2.4, S4.1, S5.2
c.sibley@auckland.ac.nz	F1.3, F4.3, S2.7, S4.3
purnima125@hotmail.com	F4.9, S4.9
sinnj@winthrop.edu	S1.5
csirinvilalobos@utep.edu	M2.5, S2.5
lskitka@uic.edu	S1.3, S5.7
slawp642@newschool.edu	F2.3, S1.2

Smeulers	Alette	Tilburg University
Sohlberg	Jacob	Lund University
Solak	Nevin	Middle East Technical University & New York University
Solovyeva	Maria	St. Petersburg State University
Stern	Chadly	New York University
Stewart	Andrew Lee	University of Connecticut
Stey	Paul	University of Notre Dame
Stockman	Maya	Lauder School of Government, Diplomacy & Strategy, IDC
Strauts	Erin	Social Psychology, University of Connecticut
Suhay	Elizabeth	Lafayette College
Sullivan	Jacqueline	West Chester University
Sumaktoyo	Nathanael Gratias	Loyola University Chicago
Sumaktoyo	Nathanael	Department of Psychology, University of Indonesia
Sundberg	Ralph	Department of Peace and Conflict Research, Uppsala University
Sunsay	Ceyhun	Indiana University Northwest
Sutter	Alina	University of Zurich
Sveshnikova	Natalia	St. Petersburg State University
Tahmaseb	Jasmin	West Chester University
Tamir	Maya	Hebrew University
Tausch	Nicole	St. Andrews University
Taylor	Laura K.	University of Notre Dame
Thalhammer	Kristina Emma	St. Olaf College
Theodoridis	Alexander George	University of California, Berkeley
Thornton	Ashley	Graduate Institute of International and Development Studies, Geneva, Switzerland
Tileaga	Cristian	Loughborough University
Tilley	Brian	National University
Tonge	Jonathan	University of Liverpool
Torney-Purta	Judith	University of Maryland
Touboul	Maryse	School of Aliveness and Adulthood, George Washington University
Transue	John	University of Illinois - Springfield
Trofimova	Vera	Lomonosov Moscow State University, faculty of Political Science, Department of Political Psychology
Trosky	Abram	Boston University
Ulug	Ozden Melis	Queen's University Belfast
Utych	Stephen	Vanderbilt University
Valentino	Nicholas	University of Michigan
Van Alst	Julia	Harvard Graduate School of Education
Van Berkel	Laura D	University of Kansas
Van Coppenolle	Brenda	LSE
van de Wetering	Sven	University of the Fraser Valley
van der Toorn	Jojanneke	Yale University
van Doorn	Bas Willem	College of Wooster
Van Doorn	Marjoka	Vrije Universiteit Amsterdam, Netherlands

a.l.smeulers@tilburguniversity.edu	F1.2
jacob.sohlberg@svet.lu.se	M1.6, S5.5
ns2361@nyu.edu	F5.5
snau@mail.ru	S4.6
cds330@nyu.edu	M1.2, F1.3, S4.4
andrew.stewart@uconn.edu	S5.10
pstey@nd.edu	F1.4
mayastockman07@gmail.com	S2.6
erin.straubs@uconn.edu	S4.1
suhaye@lafayette.edu	S1.5, S2.5, S4.5
jtahmasebmconatha@wcupa.edu	S1.9
nsumaktoyo@luc.edu	S1.7, S2.4
nathan.3073@gmail.com	S1.7, S5.1
ralph.sundberg@pcr.uu.se	S1.2
csunsay@iun.edu	F4.4
alina.sutter@uzh.ch	M1.6
sonias@rambler.ru	F5.9
jtahmaseb@wcupa.edu	S1.9
tamirm@mscc.huji.ac.il	F5.2, S4.3
nt20@st-andrews.ac.uk	S1.1, S4.2, S4.3
ltaylo12@nd.edu	S2.4, S4.1, S5.2
kris@anderthal.us	F5.9
theodoridis@berkeley.edu	F2.6, S2.9, S4.8, S5.5
ashley.thornton@graduateinstitute.ch	M1.6
c.tileaga@lboro.ac.uk	M2.4, F2.7, S2.6
btilley@nu.edu	S4.5
j.tonge@liverpool.ac.uk	F1.6
jtputra@umd.edu	S2.7
marysetouboul@hotmail.com	F4.6
john.e.transue@gmail.com	S5.4
tvera@mail.ru	M1.4
atrosky@bu.edu	S4.7
melisulug@yahoo.com	F5.2, S1.2
stephen.m.utyck@vanderbilt.edu	S2.9
nvalenti@umich.edu	F2.9, S4.5
jhv550@mail.harvard.edu	F1.8
vanberkel@ku.edu	F4.6
B.K.Van-Coppenolle@lse.ac.uk	F2.6
svend.vandewetering@ufv.ca	S5.10
j.vandertoorn@yale.edu	M1.2, S1.5
bvandoorn@wooster.edu	F1.5, F5.7
m.van.doorn@vu.nl	M1.1, S4.9

INDEX

of conference presenters

van Prooijen	Jan Willem	Dept. Social and Organizational Psychology, VU University Amsterdam
van Stekelenburg	Jacquelien	VU University
van Troost	Dunya	VU University
Vandenbroek	L. Matthew	University of Texas at Austin
Verbalyte	Monika	FU Berlin
Verkuyten	Maykel	Faculty of Social Sciences, University of Utrecht
Vilas	Xiana	USC
Villalobos	Jose D.	University of Texas at El Paso
Vinogradova	Nadezda	Moscow State University
Vitriol	Joseph A	University of Minnesota, Twin-Cities
Volynskaia	Maria	St. Petersburg State University
Voss	Jackson	Louisiana State University
Wachtel	Joseph	George Washington University
Wayne	Carly	IDC Herzliya
Weber	Christopher	Louisiana State University
Weiner	Elliot Hansen	Metropolitan State University
Wendell	Dane	Loyola University Chicago
Wiley	Shaun	The College of New Jersey
Williamson	Susan Marlene	University of Connecticut
Wilson	Marc Stewart	Psychology, Victoria University of Wellington
Wilson	Margaret Ann	University of Liverpool
Winter	David	University of Michigan
Wisneski	Daniel	University of Illinois at Chicago
Wohl	Michael Jeremy Adam	Carleton University
Wojcik	Sean	University of California, Irvine
Wong	Cara	University of Illinois, Urbana-Champaign
Wood	Thomas Julian	University of Chicago
Woodson	Ben	Stony Brook University - Political Science
Woon	Jonathan	University of Pittsburgh
Wronski	Julie	Stony Brook University
Young	Lori	University of Pennsylvania
Yuriev	Alexander Ivanovich	St. Petersburg State University
Zandonella	Martina	SORA - Institute for Social Research and Analysis
Zick	Andreas	University of Bielefeld
Zick	Andreas	University of Bielefeld
Zilis	Michael	University of Michigan
Sheehy-Skeffington	Jennifer	Harvard University
Sheikh	Hammad	New School for Social Research
Shestopal	Elena	Moscow State University, Political Science Department
Shkreli	Etrit	Bilkent University
Sibley	Chris G.	University of Auckland
Sidanius	James	Harvard University
Simai	Szilvia	University of Campinas

j.w.van.prooijen@vu.nl	F2.2
j.van.stekelenburg@vu.nl	F1.1, F2.1
d.m.m.van.troost@vu.nl	F4.2, S5.10
lmvandenbroek@utexas.edu	S4.5
melodija@zedat.fu-berlin.de	M2.3, S1.6, S2.9
m.verkuyten@uu.nl	M1.3
xiana.vilas@usc.es	F2.1, S4.2
jdviollobos2@utep.edu	S2.5
nadivinogradova@gmail.com	M2.2
joevitriol@gmail.com	S1.8
maria.volynskaya@gmail.com	F5.9, S4.6
jvoss1@tigers.lsu.edu	S2.5
jwachtel@gwu.edu	F2.8
carlywayne@gmail.com	S4.3
crweber@lsu.edu	S1.5, S2.5, S4.5
weinel@metrostate.edu	F4.6
dwendell@luc.edu	S1.8
swiley@tcnj.edu	F4.1, S4.1
susanwilco@gmail.com	S4.4
marc.wilson@vuw.ac.nz	F4.3
maw@liv.ac.uk	S2.3
dgwinter@umich.edu	S2.2
dwisne2@uic.edu	S1.3, S5.7
michael_wohl@carleton.ca	F4.1
swojcik@uci.edu	S5.6
carawong@illinois..du	S5.9
tomwood@uchicago.edu	S2.3, S4.5
benjamin.woodson@gmail.com	F5.7, S1.2, S2.9, S5.3
woon@pitt.edu	S4.8
jewlesann@gmail.com	S5.5
lyoung@asc.upenn.edu	F5.10
yuriev@robotek.ru	S5.8
mz@sora.at	S2.7
zick@uni-bielefeld.de	F2.4, F5.10, S1.4, S2.5
andreas.zick@uni-bielefeld.de	S5.4
zilisma@umich.edu	S4.6
jsheehy@fas.harvard.edu	M5.5
hammadsheikh79@gmail.com	U4.1
shestop0505@rambler.ru	Su4.5
xanhippic@gmail.com	S6.5
c.sibley@auckland.ac.nz	Su2.11, Su5.2
sidanius@wjh.harvard.edu	M5.5, U2.3, U4.5, Su4.9, Su5.1
szilvia.simai@gmail.com	Su1.7

INDEX

of conference presenters

Simon	Bernd	University of Kiel
Sinkkonen	Teemu	Finnish Institute of International Affairs
Sirin	Cigdem V.	University of Texas at El Paso
Slawuta	Patricia Natally	New School for Social Research, New York City
Slothuus	Rune	University of Aarhus
Smeekes	Anouk	Faculty of Social and Behavioral Sciences, Utrecht University
Sofuoglu	Murat	Ekopolitik (Center for Economic and Social Research)
Solomon	Johanna	University of CA, Irvine
Somer-Topcu	Zeynep	Vanderbilt University
Sommer	Udi	Tel Aviv University
Sood	Gaurav	Stanford
Srinivas	Tulasi	Emerson College
Srour	Anan	Ben Gurion University
Stahel	Lea	Queen's University of Belfast
Statman	James M	Abt Associates
Staub	Ervin	University of Massachusetts at Amherst
Steinmetz	Stephanie	University of Amsterdam
Stellmacher	Jost	Fachbereich Psychologie, Philipps-Universität Marburg (Germany)
Stepick	Alex	Florida International University, Miami, Florida, USA
Stewart	Andrew Lee	University of Connecticut
Strelets	Ilya	Moscow State University, Political Science Department
Stuart	Avelie	Murdoch University
Subasic	Emina	Australian National University
Suedfeld	Peter	University of British Columbia
Sunsay	Ceyhun	St. Mary's College of Maryland
Sutton	Robbie	University of Kent, UK
Talha	Köse	Istanbul Sehir University
Tanya	Bahar	Okan University
Tasdemir	Nagihan	METU
Taylor	Laura Kathryn	University of Notre Dame
Thayer	Adin	Karuna Center for Peacebuilding
Theiss-Morse	Elizabeth	University of Nebraska-Lincoln
Theodoridis	Alexander George	University of California, Berkeley
Thiel	Stephanie	University of Konstanz, Germany
Thies	Cameron G	University of Iowa
Thorisdottir	Hulda	University of Iceland
Tileaga	Cristian	Loughborough University
Titov	Victor	Lomonosov MSU
Titova	Vlada	St. Petersburg State Pediatric Medical Academy

simon@psychologie.uni-kiel.de	M4.11, U1.11, S3.8
teemu.sinkkonen@fiia.fi	S6.1
csirinvillalobos@utep.edu	M2.7, M4.10, Su2.9
slawp642@newschool.edu	M1.4, S4.1
slothuus@ps.au.dk	M1.8, S3.7
anouksmeekes@gmail.com	U2.8, S6.3
msofuoglu@ekopolitik.org	Su5.8
j.a.solomon@gmail.com	M2.7, Su1.1
z.somer@vanderbilt.edu	U4.7
udis@post.tau.ac.il	M5.6
gsood07@gmail.com	U4.8
Tulasi_Srinivas@emerson.edu	S6.10
anansrour@gmail.com	S5.4
leastahel@bluemail.ch	U3.1
jmstatman@gmail.com	Su4.10, S6.10
estaub@psych.umass.edu	M5.1, S2.8, Su4.1
s.m.steinmetz@uva.nl	Su5.4
stellmac@staff.uni-marburg.de	M4.9
stepick@fiu.edu	Su1.8
andrew.stewart@uconn.edu	M5.5, U2.3
sagitol@mail.ru	Su2.6
a.stuart@murdoch.edu.au	M3.2
emina.subasic@anu.edu.au	M1.5
psuedfeld@psych.ubc.ca	M1.11, M5.1, S2.8
csunsay@smcm.edu	Su2.3
r.sutton@kent.ac.uk	M5.2, S1.10, Su2.5, S4.1, Su5.11
talhakose@sehir.edu.tr	M2.7, U2.8, S3.6
bahar.tanyas@okan.edu.tr	M4.2
nagihan@metu.edu.tr	M2.7
ltaylor12@nd.edu	S3.1, S4.1
adinth@comcast.net	Su4.1
etheissmorse1@unl.edu	Su2.7, Su5.7
theodoridis@berkeley.edu	Su1.5, S3.4, Su4.6
stephanie.thiel@uni-konstanz.de	U1.4
cameron-thies@uiowa.edu	M5.11
huldat@gmail.com	M4.7, Su1.11, S3.7
c.tileaga@lboro.ac.uk	M1.9, Su1.7, Su4.7
titov-msu@mail.ru	Su4.7
vivlan2001@mail.ru	M3.2

INDEX

of conference presenters

Torkington	Kate	Universidade do Algarve, Portugal / Lancaster University
Tredoux	Colin	University of Cape Town
Triga	Vasiliki	Centre for Democracy Studies Aarau (ZDA), University of Zurich
Trofimova	Vera	Moscow State University by Lomonosov, faculty of Political Science, Department of Political Psychology
Trojanovskiy	Roman	City Mental Hospital №3 of I.I.Skvortsova-Stepanova, St. Petersburg
TSE	Thomas	The Chinese University of Hong Kong
Tsirogianni	Stavroula	Methodology Institute, London School of Economics
Turam	Berna	Northeastern University
Turgeon	Mathieu	Universidade de Brasilia
Türken	Salman	Psychology Dept., University of Oslo
Tüscher	Thomas	University of Lausanne
Ulug	Ozden Melis	Queen's University Belfast
Uyan Semerci	Pinar	Istanbul Bilgi University
Uzelgun	Mehmet Ali	Lisbon University Institute (ISCTE-IUL), Centro de Investigação e Intervenção Social (CIS)
Valencia	Jose Francisco	University of the Basque Country
Valentino	Nicholas	University of Michigan
Valkeapää	Annuikka	University of Helsinki
Van Acker	Kaat	University of Leuven, Belgium
Van Coppenolle	Brenda	LSE
van de Wetering	Sven	University of the Fraser Valley
Van der Linden	Nicolas	Université Libre de Bruxelles (ULB)
van der Noll	Jolanda	Bremen International Graduate School of Social Sciences
van der Toorn	Jojanneke	Yale University
van Dommelen	Andrea	University of Sydney
van Doorn	Bas Willem	College of Wooster
Van Doorn	Marjoka	Vrije Universiteit Amsterdam, Netherlands
van Meurs	Nathalie	Middlesex University
van Stekelenburg	Jacquelien	VU University
van Stralen	Cornelis Johannes	Brazilian Association of Political Psychology/ Federal University of Minas Gerais
van Troost	Dunya	Leiden University
Varadi	Luca	Humboldt Universität zu Berlin, BGSS
Vasiutynskiy	Vadym Olexandrovych	Institute of Social and Political Psychology
Veit	Susanne	Social Science Research Center Berlin (WZB)
Vieille	Stephanie	The University of Western Ontario
Vieno	Alessio	University of Padova, Department of Developmental and Social Psychology

ktorking@ualg.pt	Su1.7
colin.tredoux@uct.ac.za	S5.5
vasiliki.trigka@zda.uzh.ch	M5.3
tvera@mail.ru	Su2.6
rrtr@rambler.ru	M3.2
kctse@cuhk.edu.hk	M4.5
s.tsirogianni@lse.ac.uk	S2.7, Su5.11
b.turam@neu.edu	U1.6
turgeon@unb.br	Su5.4
salman.turken@psykologi.uio.no	S2.7
Thomas.Tuscher@unil.ch	U4.7
melisulug@yahoo.com	Su2.4
pinaru@bilgi.edu.tr	M4.8, S3.8
mali.uzelgun@iscte.pt	Su4.8
pspvagaj@ss.ehu.es	M2.9, U2.5, U4.2, Su5.6, S6.4
nvalenti@umich.edu	U2.7, Su2.1, Su5.6
annukka.valkeapaa@helsinki.fi	M4.10
kaat.vanacker@psy.kuleuven.be	U2.8, S3.3, Su5.7, S6.3
B.K.Van-Coppenolle@lse.ac.uk	Su5.4
sven.vandewetering@ufv.ca	Su1.10
nivdlind@ulb.ac.be	M4.11, U2.1
j.vandernoll@jacobs-university.de	S4.1, S6.5
j.vandertoorn@yale.edu	Su1.11
avan5733@uni.sydney.edu.au	Su1.3
bvandoorn@wooster.edu	M2.6, Su1.5
m.van.doorn@vu.nl	U2.4
n.van-meurs@mdx.ac.uk	U1.10
j.van.stekelenburg@vu.nl	M4.11, U1.11, U2.4, Su4.11, S5.11, S6.9
stralen@medicina.ufmg.br	M1.10
dunyavantroost@gmail.com	S6.9
varadiluca@gmail.com	Su4.3
tytarenko@voliacable.com	S3.10
veit@wzb.eu	M4.9, S5.3
svieille@uwo.ca	Su2.10
alessio.vieno@unipd.it	M3.2

INDEX

of conference presenters

Villalobos	Jose D.	University of Texas at El Paso
Vinogradova	Nadezda	Moscow State University
Vlastou	Filyra	Paris Descartes
Vollhardt	Johanna Ray	Clark University
Voyer	Benjamin Gilles	London School of Economics
Wagner	Ulrich	University of Marburg
Wahab	Wiaam	University of East London
Walker	Alexandra Clare	Australian National University
Ware	Robert Bruce	Southern Illinois University Edwardsville
Wason	Kshitija	IIT Delhi, India
Weber	Rebecca Anne	University of Lyon
Welschen	Saskia	VU University Amsterdam
Wenink	Eriijn	Leiden University
Westwood	Sean Jeremy	Stanford University
Whitehead	Kevin	University of the Witwatersrand
Wilson	Katherine J.	School of Psychology, University of Kent
Wilson	Margaret Ann	University of Liverpool
Winiewski	Mikolaj	University of Warsaw
Woessner	Matthew	Penn State Harrisburg
Wronski	Julie	Stony Brook University
Wuerfel	Kirsten	Queen's University Belfast
Yarkoni	Ayala York	Lauder School of Government, IDC Herzliya, Israel
Yavcan	Basak	University of Pittsburgh
Yazıcı	Ayla	President of İstanbul Psikanaliz Eğitim, Araştırma ve Geliştirme Dern
Yildiz	Aslan Ali	ERCOMER, Utrecht University
Yuriev	Alexander Ivanovich	St. Petersburg State University
Zack	Astrid Julia	Queen's University, Belfast
Zaiser	Erica Kristin	University of Kent
Zandonella	Martina	SORA - Institute for Social Research and Analysis
Zartner	Dana	Tulane University
Zezeļj	Iris	Faculty of philosophy, Belgrade
Zick	Andreas	University of Bielefeld
Zorin	Vassily	Chelyabinsk State University
Zubieta	Elena Mercedes	Buenos Aires University
Zuma	Buhle	University of Cape Town, South Africa

jdவில்லalobos2@utep.edu	M4.10, S3.5, S6.6
nadivinogradova@gmail.com	Su2.6
filyra.vlastou@gmail.com	U2.2
JVollhardt@clarku.edu	M1.1, M2.2, M5.1, U3.1
b.voyer@lse.ac.uk	M5.7, U4.6
wagner1@staff.uni-marburg.de	S2.2, S5.5
wiaam.wahab@hotmail.com	Su3.3
alexandrawalk@gmail.com	S3.9
antinomy@sbcglobal.net	M5.2, U2.2, Su4.7
wason.k@gmail.com	S3.6
rebecca.weber@univ-lyon2.fr	Su2.9
s.i.welschen@vu.nl	M4.5
e.g.wenink@fsw.leidenuniv.nl	S4.1
seanjw@stanford.edu	S2.5
kwhitehead11@gmail.com	S3.2
kw265@kent.ac.uk	M5.2
maw@liv.ac.uk	U1.5, S5.2
mikk@psych.uw.edu.pl	M1.4, Su1.3
mcw10@psu.edu	M4.5
jewlesann@gmail.com	S3.7, S5.11
wuerfelkirsten@googlemail.com	Su2.8
yarkoniayala@gmail.com	Su1.2
bay4@pitt.edu	Su4.5, S6.8
ayyaz@superonline.com	Su5.8
A.A.Yildiz@uu.nl	S5.3
yuriev@robotek.ru	S2.11
azack01@qub.ac.uk	S2.6
ez25@kent.ac.uk	U3.1
mz@sora.at	S3.4
zartner@tulane.edu	Su2.10, Su4.8
izezelj@f.bg.ac.rs	M1.11, Su1.3
zick@uni-bielefeld.de	U4.3, Su1.4, S3.1, S5.6
vaszarin@mail.ru	Su2.6
ezubieta@psi.uba.ar elenazubieta@hotmail.com	M2.9, S6.4
buhle.zuma@gmail.com	U1.8

JULY 2011-JULY 2012 ISPP OFFICERS

2011-12 President

Bert Klandermans, VU-University, Netherlands

President-Elect

Rose McDermott, Brown University, USA

Past President

Leonie Huddy, State University of New York, Stony Brook, USA

Executive Director

Farrah Graham, Virginia Commonwealth University, USA

Vice-Presidents

Paul Nesbitt-Larking, Huron University College, Canada

Stanley Feldman, Stony Brook University, USA

Tereza Capelos, University of Surrey, UK

Editors of Political Psychology

Alex Mintz, Lauder School of Government-IDC, Israel (Editor)

Helen Haste, University of Bath, UK (Co-editor)

David Redlawsk, University of Iowa, USA (Co-editor)

Jim Sidanius, Harvard University, USA (Co-editor)

Paul 't Hart, Australian National University, Australia (Co-editor)

Eran Halperin, Lauder School of Government-IDC, Israel (Associate Editor)

Steven Redd, University of Wisconsin-Milwaukee, USA (Associate Editor)

ISPPNews Editor

Melinda Jackson, San Jose State University, USA

Treasurer

Andrea Grove, California State College at Channel Islands, USA

Councilor

George Marcus, Williams College, USA

GOVERNING COUNCIL

Starting a third year in 2011:

Esra Çuhadar Gürkaynak, Bilkent University, Turkey

Jamie Druckman, Northwestern University, USA

Eva Green, University of Lausanne, Switzerland

Jennifer Jerit, Florida State University, USA

Tasha Philpot, University of Texas, USA

Starting a second year in 2011:

Daphna Canetti, University of Haifa, Israel
Chris Cohrs, Queen's University Belfast, Northern Ireland
Susan Condor, Lancaster University, UK
John Jost, New York University, USA
Jacqueline van Stekelenburg, VU-University, Netherlands

Starting a first year in 2011

Leda Blackwood, St. Andrews University, UK
Gian Vittorio Caprara, Sapienza University of Rome, Italy
Rick Lau, Rutgers University, USA
Joanne Miller, University of Minnesota, USA
Katherine Reynolds, Australian National University, Australia

JULY 2012-JULY 2013 ISPP OFFICERS

2013 President

Rose McDermott, Brown University, USA

President-Elect

Stanley Feldman, Stony Brook University, USA

Past President

Bert Klandermans, VU-University, Netherlands

Executive Director

Severine Bennett, USA

Vice-Presidents

Stanley Feldman, Stony Brook University, USA
Tereza Capelos, University of Surrey, UK
Jamie Druckman, Northwestern University, USA

Editors of *Political Psychology*

Alex Mintz, Lauder School of Government-IDC, Israel (Editor)
Helen Haste, University of Bath, UK (Co-editor)
David Redlawsk, University of Iowa, USA (Co-editor)
Jim Sidanius, Harvard University, USA (Co-editor)
Paul 't Hart, Australian National University, Australia (Co-editor)
Eran Halperin, Lauder School of Government-IDC, Israel (Associate Editor)
Steven Redd, University of Wisconsin-Milwaukee, USA (Associate Editor)

ISPPNews Editor

Melinda Jackson, San Jose State University, USA

Treasurer

Andrea Grove, California State College at Channel Islands, USA

Councilor

George Marcus, Williams College, USA

GOVERNING COUNCIL

Starting a third year in 2012:

Daphna Canetti, University of Haifa, Israel
Chris Cohrs, Queen's University Belfast, Northern Ireland
Susan Condor, Lancaster University, UK
John Jost, New York University, USA
Jacqueliën van Stekelenburg, VU-University, Netherlands

Starting a second year in 2012:

Leda Blackwood, St. Andrews University, UK
Gian Vittorio Caprara, Sapienza University of Rome, Italy
Rick Lau, Rutgers University, USA
Joanne Miller, University of Minnesota, USA
Katherine Reynolds, Australian National University, Australia

Starting a first year in 2012

Adam Berinsky, MIT, USA
Ted Brader, University of Michigan, USA
Anca Minescu, University of Limerick, Ireland
Jojanneke van der Toorn, Yale University, USA
Johanna Vollhardt, Clark University, USA



ISPP

International Society
of Political Psychology

Who We Are

ISPP is an interdisciplinary organization representing all fields of inquiry concerned with exploring the relationships between political and psychological processes. Members include psychologists, political scientists, psychiatrists, historians, sociologists, economists, anthropologists, as well as journalists, government officials and others. The Society is also international, with members from all regions of the world: the Americas, Europe, Asia, the Middle East, and Africa.

Benefits of Membership

- six issues per year of the journal Political Psychology;
- two issues per year of ISPPNews, the Society's newsletter;
- reduced registration fees at annual scientific meetings;
- and voting privileges.

2012 Conference Information

The 2012 Annual Conference will take place July 6th – 9th, 2012 in Chicago, IL.

The conference theme is “Identity Politics and Politicized Identities: Political Psychology in Times of Contention.” For more information about the conference go to <http://www.isppmeetings.com/>.

How Do I Join

The online membership form can be found at <http://www.ispp.org/join.html>. Or if you prefer you can print and mail a membership form from the same link.

For More Information

See our website at <http://www.ispp.org> or contact our Central Office:

Sev Bennett, Executive Director
ISPP
P.O. Box 1213
Columbus, NC 28722 USA
sbennett@ispp.org
Tel/Fax: +1 828 894 5422

Win a \$75 Amazon voucher

Receive the latest political psychology research straight to your inbox!

Sign up for table of contents alerts for your chance to win a \$75 Amazon voucher.

Visit <http://svy.mk/politicalpsych> and fill in the short form to be entered into the prize draw.

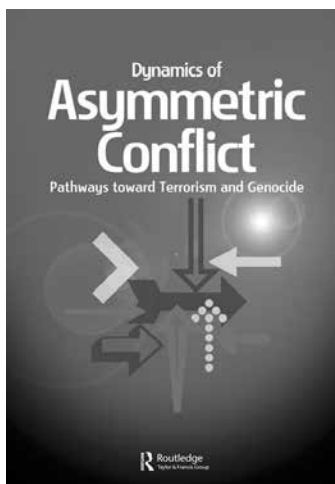

Political Psychology Journals from Routledge

**Deadline for entries:
30th September 2012**



Political Psychology

Editor-in-Chief:

ALEX MINTZ

Co-Editors:

**PAUL T'HART, HELEN HASTE,
DAVID REDLAWSK and
JAMES SIDANIUS**

Associate Editors:

**ERAN HALPERIN and
STEVEN REDD**

**Published on behalf of the
International Society of
Political Psychology**

Understanding the psychological aspects of national and international political developments is increasingly important in this age of international tension and sweeping political change. **Political Psychology** is dedicated to the analysis of the interrelationships between psychological and political processes. International contributors draw on a diverse range of sources, including clinical and cognitive psychology, economics, history, international relations, philosophy, political science, political theory, sociology, personality, and social psychology.



**WILEY-
BLACKWELL**

For more information and to subscribe online visit
wileyonlinelibrary.com/journal/pops